

PORTIONS OF SECTIONS 16, 21 & 28, TWP 24 N., RGE. 6 E., W.M.

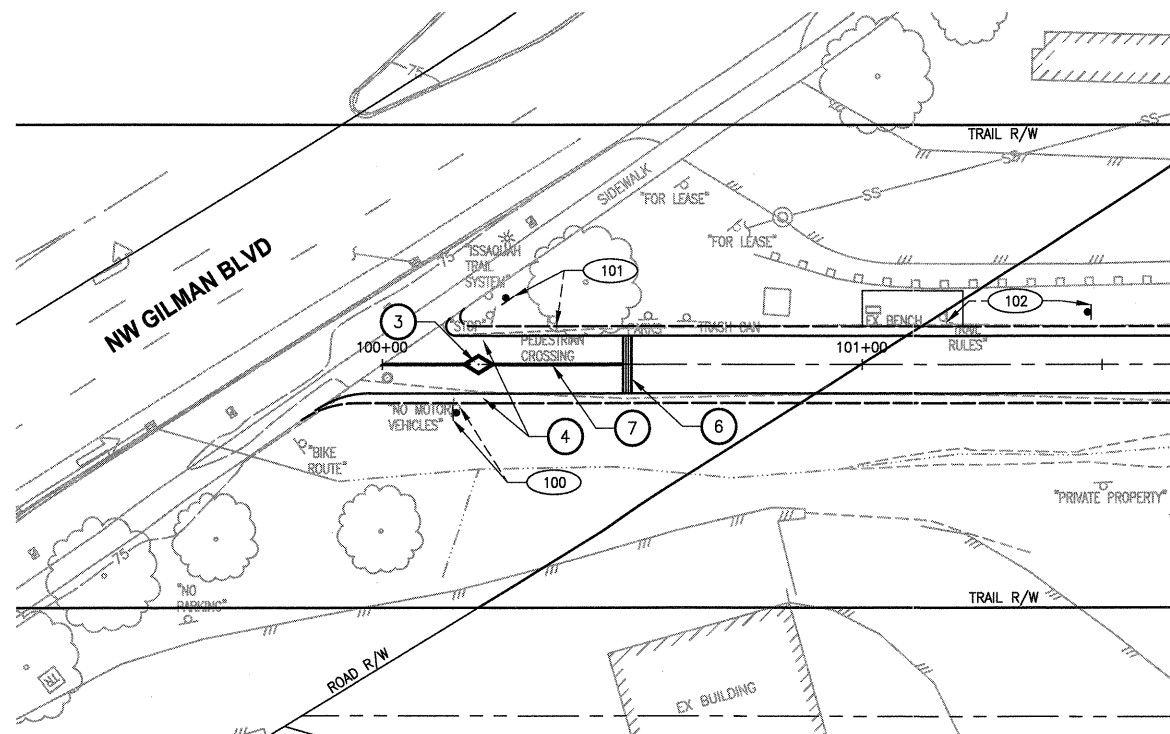

**CROSSING #1**  
SCALE IN FEET  
0 20 40

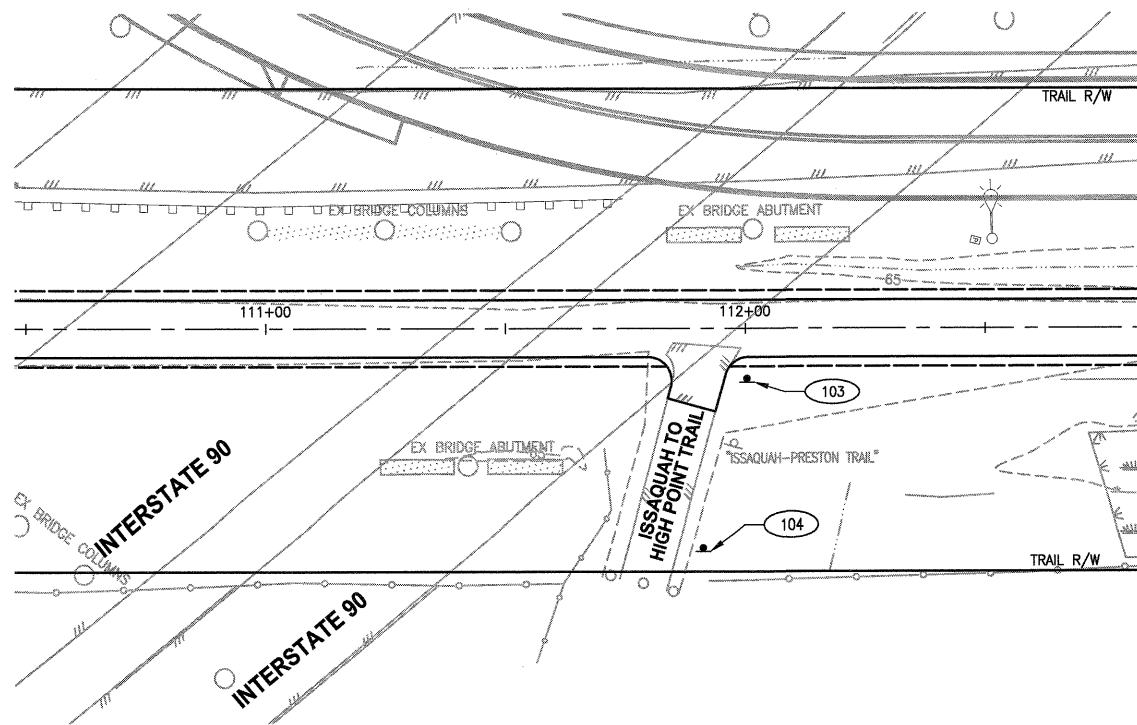

**CROSSING #2**  
SCALE IN FEET  
0 20 40

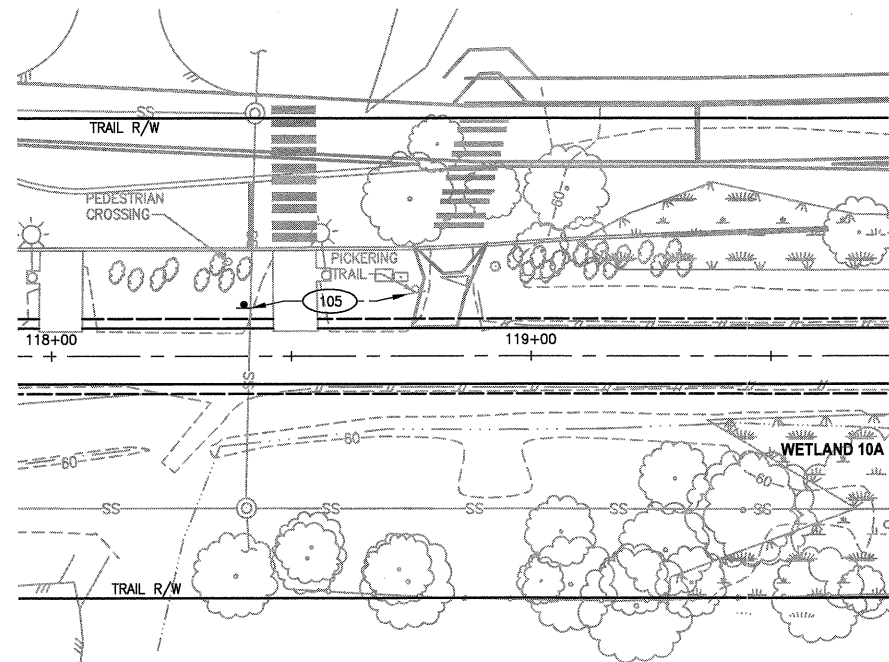

**CROSSING #3**  
SCALE IN FEET  
0 20 40

**CONSTRUCTION NOTES:**

- 1 INSTALL CROSSWALK PLASTIC LINE PER COI STD DETAIL T-36.
- 2 INSTALL TRASH CAN AND PET WASTE STATION. SEE SPECIFICATIONS FOR DETAILS.
- 3 INSTALL REMOVABLE BOLLARD PER 1 MD1
- 4 INSTALL FIXED BOLLARD PER 2 MD1
- 5 INSTALL STOP BAR PER COI STD DETAIL T-36.
- 6 CONCRETE WARNING BAND PER 4 MD1
- 7 INSTALL BOLLARD STRIPING PER 5 MD1

**LEGEND:**

- XXX SIGN, SEE SHEET PSS FOR SIGN SCHEDULE

LAYOUT: PSI  
 PATH: U:\Ball\Projects\Clients\1521-King City\554-1521-075-ELST\9858\CA\Draw\Phase 13\Task 02\Draw\...  
 PLOTTED BY: purgabut DATE: Wednesday, November 23, 2011 11:10:07 AM

REVISIONS	DATE	BY	DESIGNED
			J. JUN
			B. PURGANAN
			Y. HO
			H. LONGFELLOW

**ONE INCH AT FULL SCALE. IF NOT, SCALE ACCORDINGLY.**  
 FILE NAME: BL1521075P13T02PS-C1  
 JOB No.: 554-1521-075  
 DATE: NOVEMBER 2011



**Parametrix**  
 ENGINEERING, PLANNING, ENVIRONMENTAL SCIENCES  
 411 108TH AVENUE N.E., SUITE 1000  
 BELLEVUE, WASHINGTON 98004  
 T: 425-458-8200 F: 425-458-8363  
 www.parametrix.com

PROJECT NAME  
**EAST LAKE SAMMAMISH  
 MASTER PLAN TRAIL, ISSAQUAH SEGMENT**  
 GILMAN BLVD TO ISSAQUAH CITY LIMITS

**PAVEMENT MARKING AND  
 SIGNING PLAN**

DRAWING NO.  
 76 OF 99  
**PS1**

APPROVED  
 DEC 02 2011  
 PUBLIC WORKS ENG.  
 CITY OF ISSAQUAH  
*BH*

PORTIONS OF SECTIONS 16, 21 & 28, TWP 24 N., RGE. 6 E., W.M.

**CONSTRUCTION NOTES:**

- 1 INSTALL CROSSWALK PLASTIC LINE PER COI STD DETAIL T-36.
- 2 INSTALL TRASH CAN AND PET WASTE STATION. SEE SPECIFICATIONS FOR DETAILS.
- 3 INSTALL REMOVABLE BOLLARD PER 1 MDT
- 4 INSTALL FIXED BOLLARD PER 2 MDT
- 5 INSTALL STOP BAR PER COI STD DETAIL T-36.
- 6 CONCRETE WARNING BAND PER 4 MDT
- 7 INSTALL BOLLARD STRIPING PER 5 MDT

**LEGEND:**

XXX SIGN, SEE SHEET PSS FOR SIGN SCHEDULE

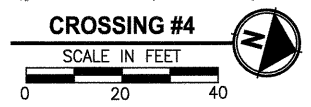
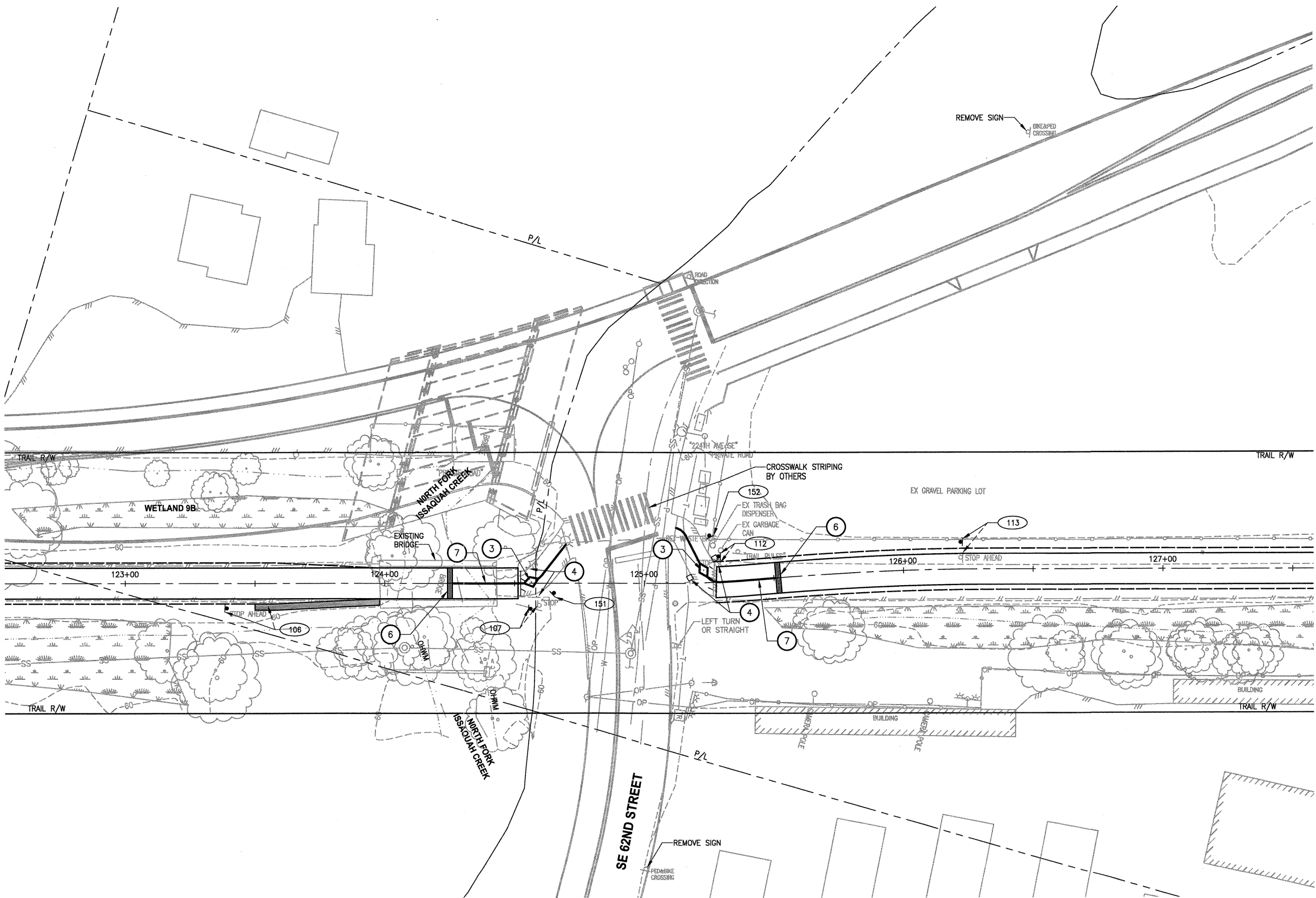

APPROVED  
DEC 02 2011  
PUBLIC WORKS ENG.  
CITY OF ISSAQUAH  
*[Signature]*

LAYOUT: PSZ  
 PATH: U:\Ball\Projects\Clients\1521-075-ELST\955\CAADD\Phase 13\Task 02\Draw\ PLOTTED BY: purgabut DATE: Wednesday, November 23, 2011 11:13:40 AM

REVISIONS	DATE	BY	DESIGNED
			J. JUN
			B. PURGANAN
			Y. HO
			H. LONGFELLOW

ONE INCH AT FULL SCALE.  
IF NOT, SCALE ACCORDINGLY

FILE NAME  
BL1521075P13T02PS-01

JOB NO.  
534-1521-075

DATE  
NOVEMBER 2011



**Parametrix**  
ENGINEERING · PLANNING · ENVIRONMENTAL SCIENCES

411 108TH AVENUE N.E., SUITE 1000  
BELLEVUE, WASHINGTON 98004  
T: 425-458-0200 F: 425-458-0393  
www.parametrix.com

PROJECT NAME  
**EAST LAKE SAMMAMISH  
MASTER PLAN TRAIL, ISSAQUAH SEGMENT**

GILMAN BLVD TO ISSAQUAH CITY LIMITS

**PAVEMENT MARKING AND  
SIGNING PLAN**

DRAWING NO.  
77 OF 99

**PS2**

PORTIONS OF SECTIONS 16, 21 & 28, TWP 24 N., RGE. 6 E., W.M.

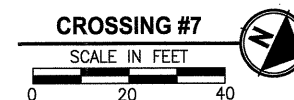
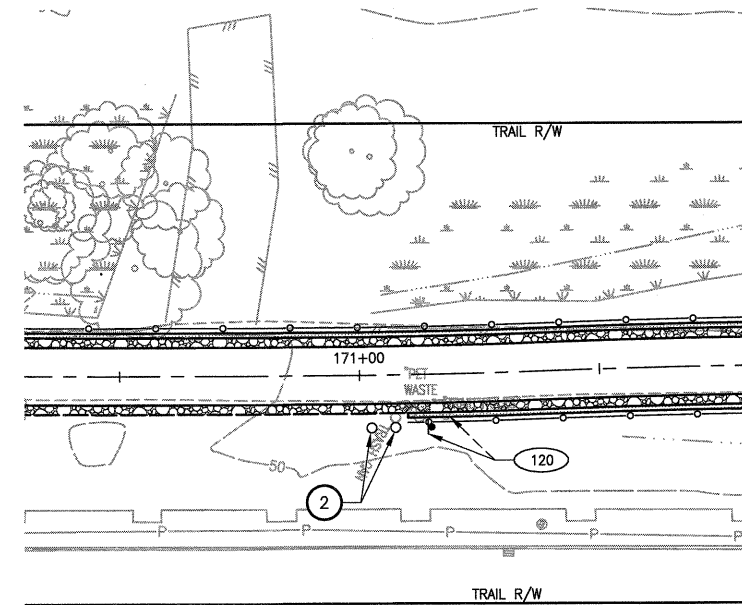
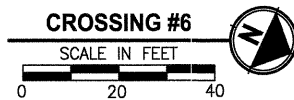
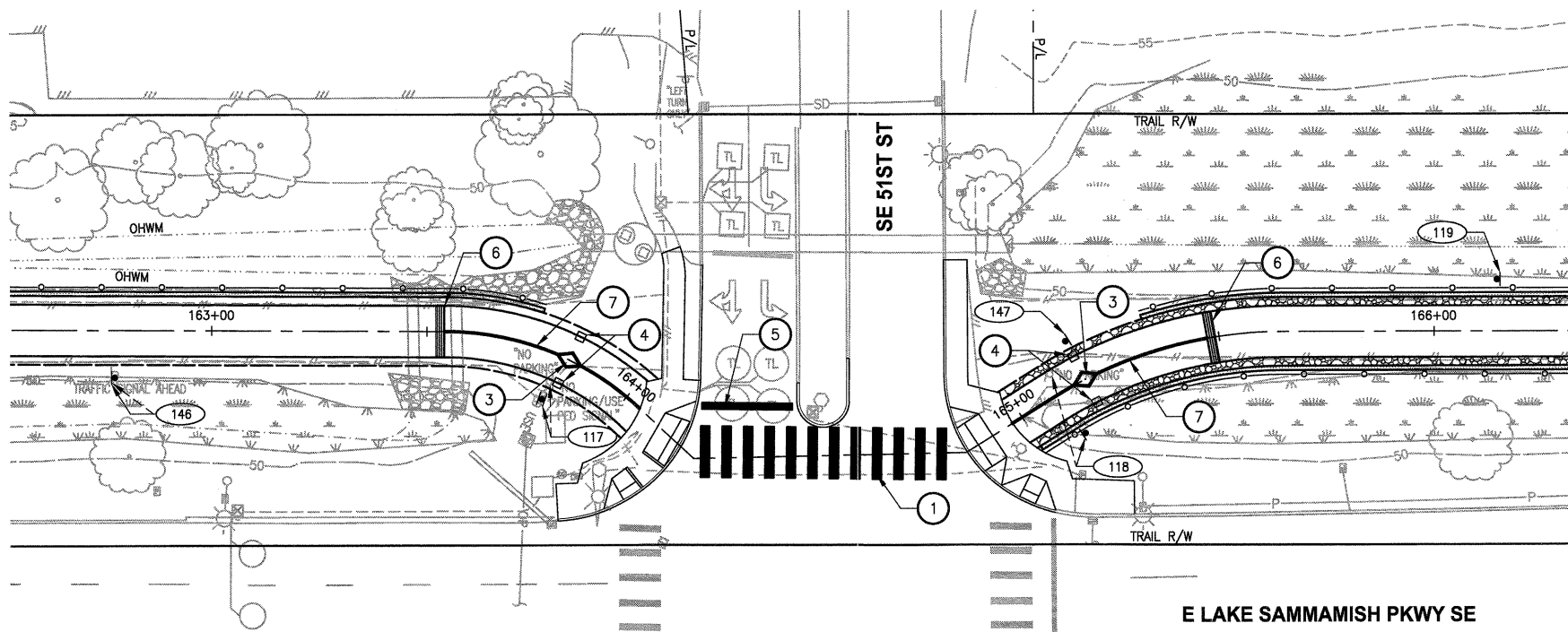
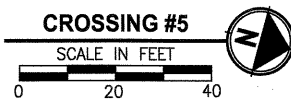
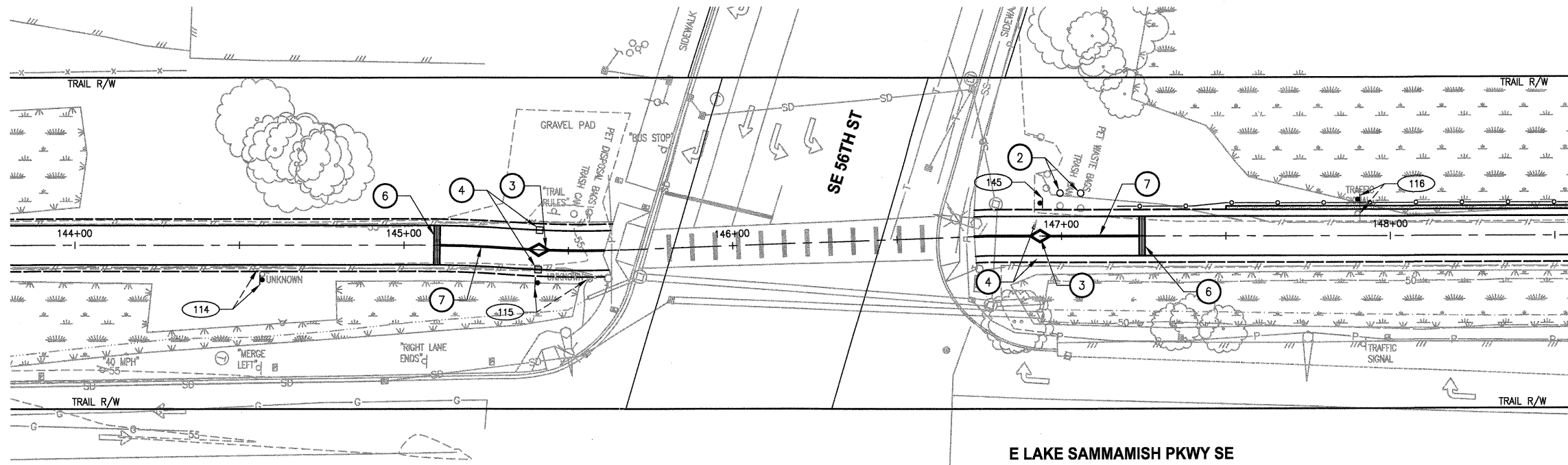

CONSTRUCTION NOTES:

- 1 INSTALL CROSSWALK PLASTIC LINE PER COI STD DETAIL T-36.
- 2 INSTALL TRASH CAN AND PET WASTE STATION. SEE SPECIFICATIONS FOR DETAILS.
- 3 INSTALL REMOVABLE BOLLARD PER 1 MD1
- 4 INSTALL FIXED BOLLARD PER 2 MD1
- 5 INSTALL STOP BAR PER COI STD DETAIL T-36.
- 6 CONCRETE WARNING BAND PER 4 MD1
- 7 INSTALL BOLLARD STRIPING PER 5 MD1

LEGEND:

- XXX SIGN, SEE SHEET PS5 FOR SIGN SCHEDULE

LAYOUT: PS3  
 PATH: U:\Ball\Projects\Clients\1521-King City\554-1521-075-ELST\995\CA\DD\Phase 13\Task 02\Draw\...  
 PLOTTED BY: purgobut DATE: Wednesday, November 23, 2011 11:14:23 AM

REVISIONS	DATE	BY	DESIGNED
			J. JUN
			B. PURGANAN
			Y. HO
			H. LONGFELLOW

ONE INCH AT FULL SCALE.  
 IF NOT, SCALE ACCORDINGLY.  
 FILE NAME: BL1521075P13T02PS-01  
 JOB No: 554-1521-075  
 DATE: NOVEMBER 2011

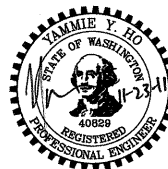

**Parametrix**  
 ENGINEERING, PLANNING, ENVIRONMENTAL SCIENCES  
 411 108TH AVENUE N.E., SUITE 1000  
 BELLEVUE, WASHINGTON 98004  
 T: 425-458-8200 F: 425-458-8363  
 www.parametrix.com

PROJECT NAME  
**EAST LAKE SAMMAMISH  
 MASTER PLAN TRAIL, ISSAQUAH SEGMENT**  
 GILMAN BLVD TO ISSAQUAH CITY LIMITS

**PAVEMENT MARKING AND  
 SIGNING PLAN**

DRAWING NO.  
 78 OF 99  
**PS3**

APPROVED  
 DEC 02 2011  
 PUBLIC WORKS ENG.  
 CITY OF ISSAQUAH

PORTIONS OF SECTIONS 16, 21 & 28, TWP 24 N., RGE. 6 E., W.M.

CONSTRUCTION NOTES:

- 1 INSTALL CROSSWALK PLASTIC LINE PER COI STD DETAIL T-36.
- 2 INSTALL TRASH CAN AND PET WASTE STATION. SEE SPECIFICATIONS FOR DETAILS.
- 3 INSTALL REMOVABLE BOLLARD PER (1) MDT
- 4 INSTALL FIXED BOLLARD PER (2) MDT
- 5 INSTALL STOP BAR PER COI STD DETAIL T-36.
- 6 CONCRETE WARNING BAND PER (4) MDT
- 7 INSTALL BOLLARD STRIPING PER (5) MDT

LEGEND:

- XXX SIGN, SEE SHEET PS5 FOR SIGN SCHEDULE

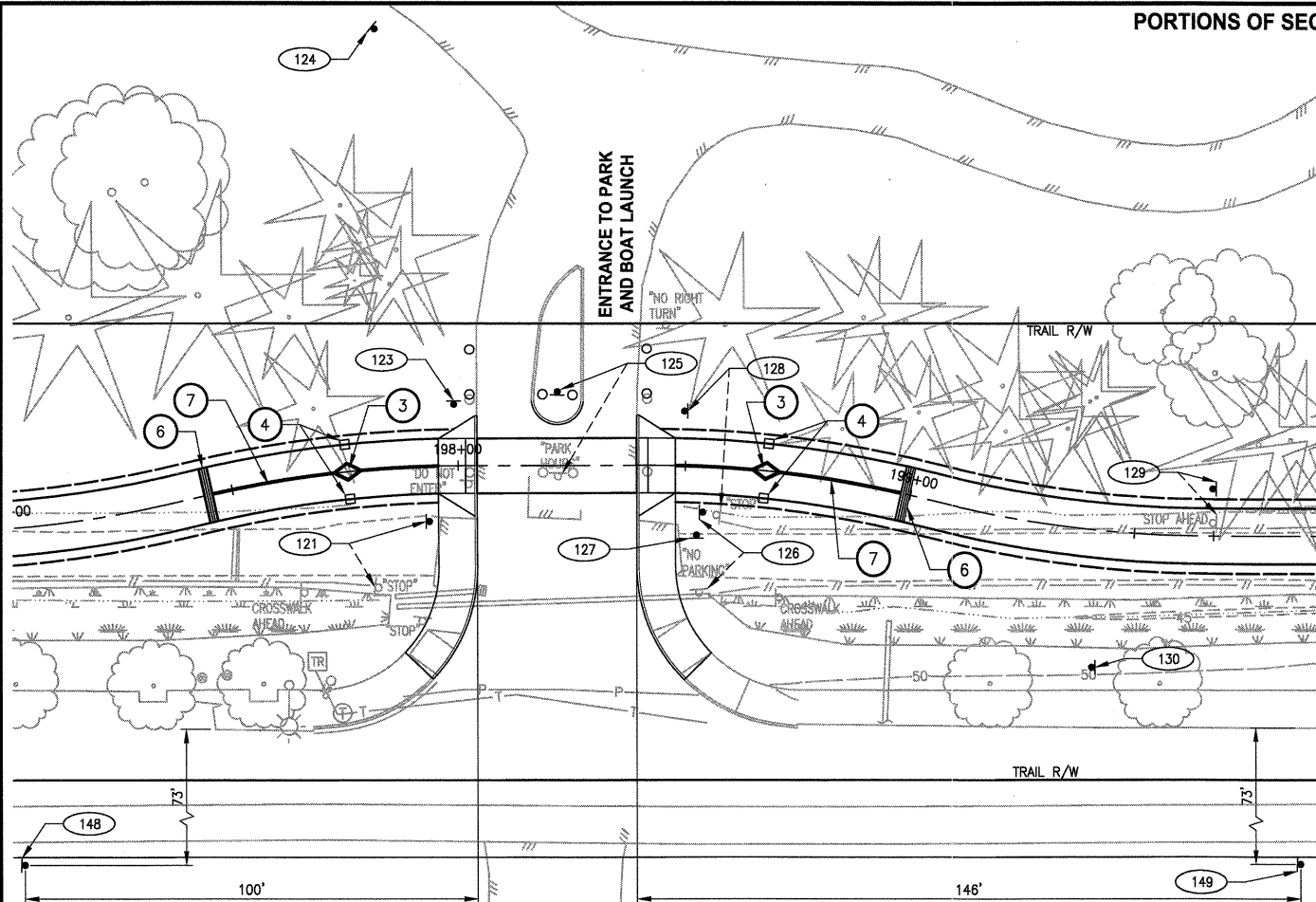

**CROSSING #8**  
SCALE IN FEET  
0 20 40

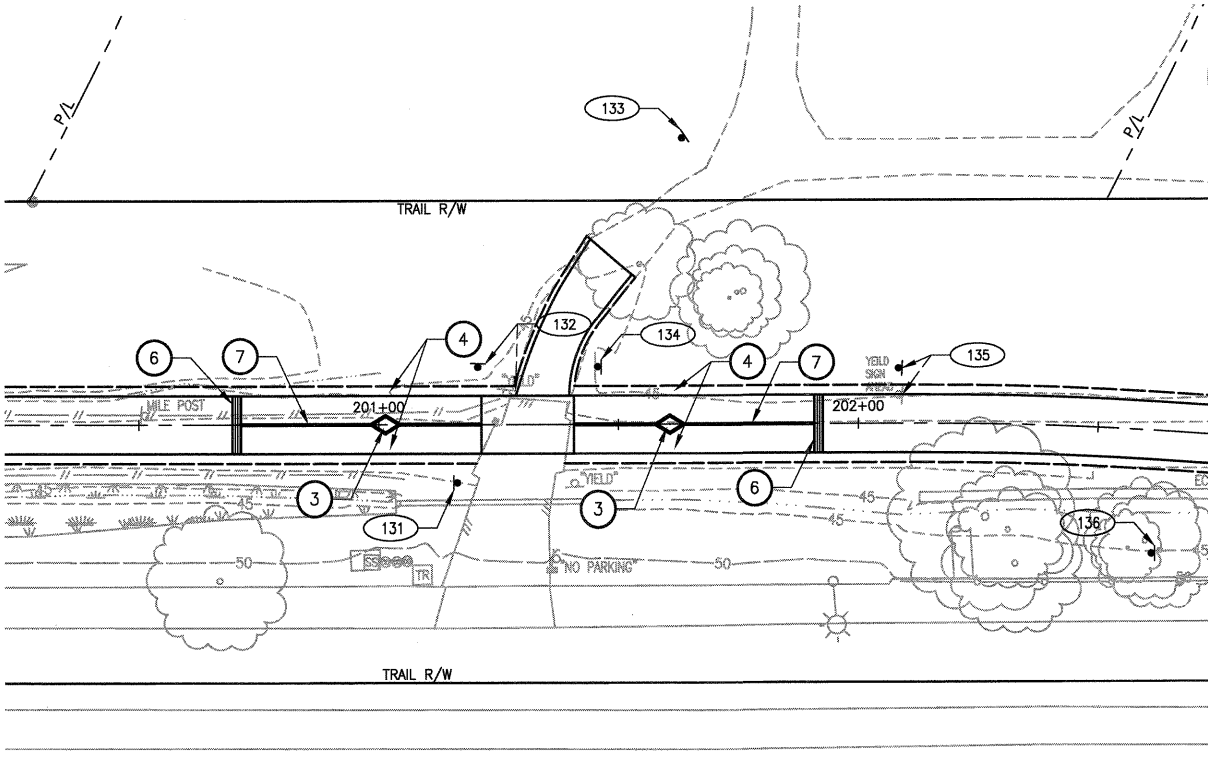

**CROSSING #9**  
SCALE IN FEET  
0 20 40

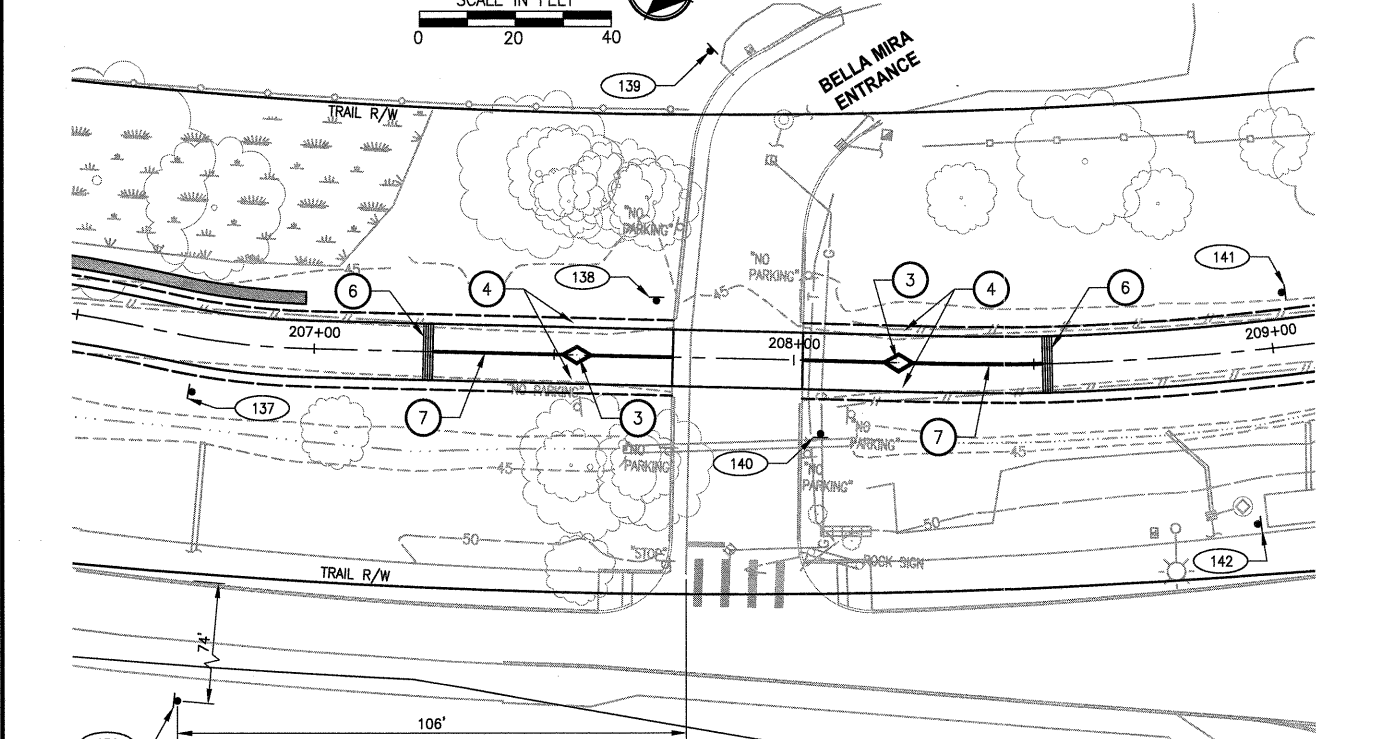

**CROSSING #10**  
SCALE IN FEET  
0 20 40

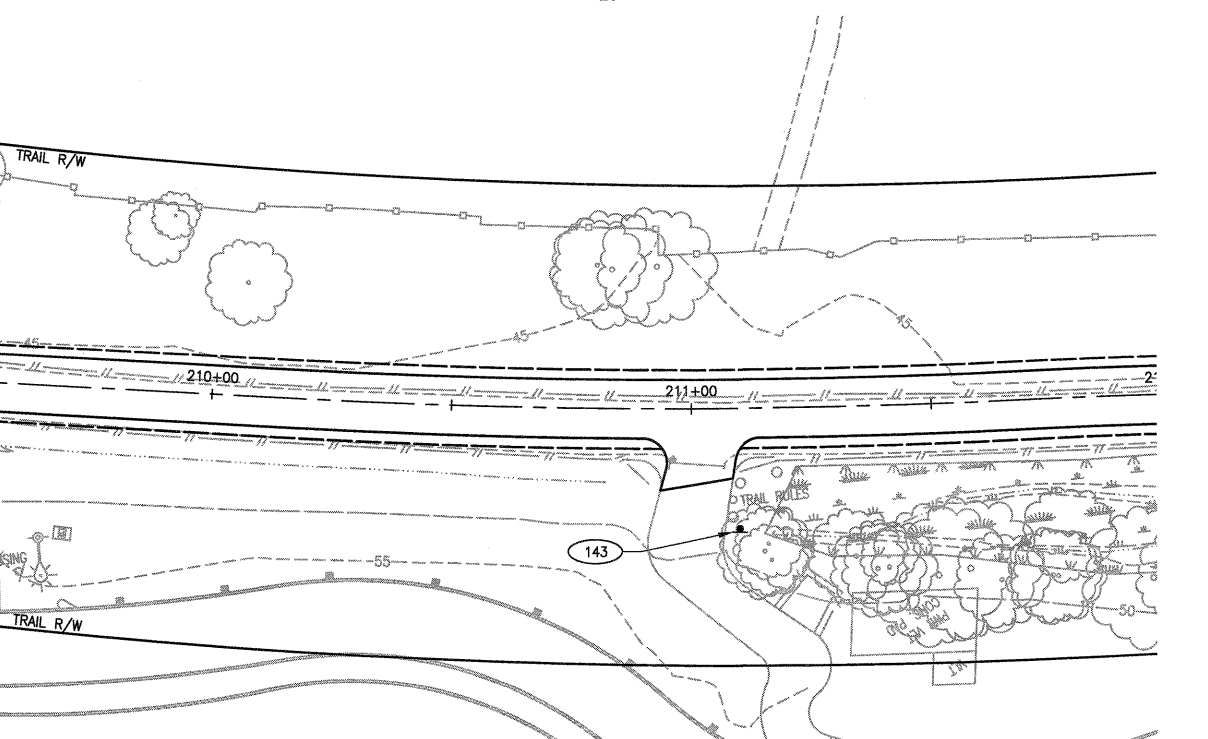

**CROSSING #11**  
SCALE IN FEET  
0 20 40

APPROVED  
DEC 02 2011  
PUBLIC WORKS ENG.  
CITY OF ISSAQUAH



**Parametrix**  
ENGINEERING . PLANNING . ENVIRONMENTAL SCIENCES  
411 108TH AVENUE N.E., SUITE 1000  
BELLEVUE, WASHINGTON 98004  
T. 425-458-8200 F. 425-458-3393  
www.parametrix.com

PROJECT NAME  
**EAST LAKE SAMMAMISH  
MASTER PLAN TRAIL, ISSAQUAH SEGMENT**  
GILMAN BLVD TO ISSAQUAH CITY LIMITS

**PAVEMENT MARKING AND  
SIGNING PLAN**

DRAWING NO.  
79 OF 99  
**PS4**

LAYOUT: PS4 PATH: U:\Bull\Projects\Clients\1521-King\_City\554-1521-075-ELST\95\Sec\CADD\Phase 13\Task 02\Drawn PLOTTED BY: purgabot DATE: Wednesday, November 23, 2011 11:16:16 AM

REVISIONS	DATE	BY	DESIGNED
			J. JUN
			B. PURGANAN
			Y. HO
			H. LONGFELLOW

ONE INCH AT FULL SCALE.  
IF NOT, SCALE ACCORDINGLY  
FILE NAME  
BL1521075P13T02PS-C1  
JOB NO.  
554-1521-075  
DATE  
NOVEMBER 2011

PORTIONS OF SECTIONS 16, 21 & 28, TWP 24 N., RGE. 6 E., W.M.

SIGN SCHEDULE

SIGN NUMBER	PROPOSED		DESCRIPTION	MUTCD SIGN	SIGN SIZE	POST TYPE	POST SIZE	REMARK
	APPROX STATION	APPROX OFFSET						
100	100+15	10' RT	NO MOTOR VEHICLE	R5-3	N/A	N/A	N/A	RELOCATE FROM 100+15.39 (8.95' RT), USE EXISTING SIGN AND POST
101	100+28	14' LT	PEDESTRIAN CROSSING AHEAD RIGHT ARROW PLAQUE (SUPPLEMENTAL)	W11-2 W1-6	N/A	N/A	N/A	RELOCATE FROM 100+35.55 (9.35' LT), USE EXISTING SIGN AND POST
102	101+47	11' LT	TRAIL RULES	CUSTOM	N/A	N/A	N/A	RELOCATE FROM 101+16.84 (8.92' LT), USE EXISTING SIGN AND POST
103	112+00	10.5' RT	YIELD	R1-2	18" X 18" X 18"	WOOD	4" X 4"	NEW SIGN AND POST
104	111+91	45' RT	YIELD AHEAD	W3-2	18" X 18"	WOOD	4" X 4"	NEW SIGN AND POST
105	118+40	11.0' LT	PICKERING TRAIL	CUSTOM	N/A	N/A	N/A	RELOCATED FROM 118+76 (14.76' LT), USE EXISTING SIGN AND POST
106	123+39	9.75' RT	STOP AHEAD	W3-1	N/A	N/A	N/A	RELOCATE FROM 123+54.12 (8.85' RT), USE EXISTING SIGN AND POST
107	124+56	10' RT	STOP	R1-1	N/A	N/A	N/A	RELOCATE FROM 124+59.49 (8.81' RT), USE EXISTING SIGN AND POST
112	125+29	10' LT	STOP	R1-1	N/A	N/A	N/A	RELOCATE FROM 125+28.06 (8.03' LT), USE EXISTING SIGN AND POST
113	126+22	10.5' LT	STOP AHEAD	W3-1	N/A	N/A	N/A	RELOCATE FROM 126+22.11 (4.52' LT), USE EXISTING SIGN AND POST
114	144+57	10.5' RT	SIGNAL AHEAD	W3-3	N/A	N/A	N/A	RELOCATE FROM 144+86.89 (8.79' RT), USE EXISTING SIGN AND POST
115	145+41	10' RT	USE PED SIGNAL	R9-5	N/A	N/A	N/A	RELOCATE FROM 145+58.42 (8.70' RT), USE EXISTING SIGN AND POST REMOVE EXISTING RIGHT ARROW PLAQUE
116	147+90	11' LT	SIGNAL AHEAD	W3-3	N/A	N/A	N/A	RELOCATE FROM 147+80.03 (8.74' LT), USE EXISTING SIGN AND POST
117	163+82	11' RT	USE PED SIGNAL NO PARKING TRAIL RULES	R9-5 R7-1 (CUSTOM) CUSTOM	N/A	N/A	N/A	RELOCATE FROM 163+81.88 (8.51' RT), USE EXISTING SIGN AND POST REMOVE EXISTING RIGHT ARROW PLAQUE
118	165+11	11' RT	NO PARKING TRAIL RULES	R7-1 (CUSTOM) CUSTOM	N/A	N/A	N/A	RELOCATE FROM 165+10.69 (5.15' LT), USE EXISTING SIGN AND POST
119	166+15	12' LT	SIGNAL AHEAD	W3-3	18" X 18"	WOOD	4" X 4"	NEW SIGN AND POST
120	171+16	11' RT	TRAIL RULES	CUSTOM	N/A	N/A	N/A	RELOCATE FROM 171+17.89 (8.75' RT), USE EXISTING SIGN AND POST
121	197+98	12' RT	STOP	R1-1	N/A	N/A	N/A	RELOCATE FROM 197+80.37 (25.37' RT), USE EXISTING SIGN AND POST
123	197+99	13.50' LT	COMBINATION BIKE AND PED CROSSING TRAIL CROSSING (PLAQUE) DIAGONAL ARROW PLAQUE (SUPPLEMENTAL)	W11-15 W11-15P W18-7P	30" X 30" 24" X 18" 24" X 12"	GALVANIZED "QWIK PUNCH" POST	2"	NEW SIGN AND POST
124	197+87	95.73' LT	COMBINATION BIKE AND PED CROSSING TRAIL CROSSING (PLAQUE) AHEAD (SUPPLEMENTAL)	W11-15 W11-15P W18-9P	30" X 30" 24" X 18" 24" X 12"	GALVANIZED "QWIK PUNCH" POST	2"	NEW SIGN AND POST
125	198+22	16.5' LT	PARK HOURS	CUSTOM	N/A	N/A	N/A	RELOCATE FROM 198+21.02 (2.39' RT), USE EXISTING SIGN AND POST
126	198+54	10' RT	NO PARKING	R7-1 (CUSTOM)	N/A	N/A	N/A	RELOCATE FROM 198+54.26 (27.11' RT), USE EXISTING SIGN AND POST
127	198+53	15' RT	COMBINATION BIKE AND PED CROSSING TRAIL CROSSING (PLAQUE) DIAGONAL ARROW PLAQUE (SUPPLEMENTAL)	W11-15 W11-15P W18-7P	30" X 30" 24" X 18" 24" X 12"	GALVANIZED "QWIK PUNCH" POST	2"	NEW SIGN AND POST
128	198+49	12' LT	STOP	R1-1	N/A	N/A	N/A	RELOCATE FROM 198+57.42 (10.44' RT), USE EXISTING SIGN AND POST
129	199+67	10.5' LT	STOP AHEAD	W3-1	N/A	N/A	N/A	RELOCATE FROM 199+67.25 (2.85' LT), USE EXISTING SIGN AND POST
130	199+43	28.5' RT	CROSSROAD TRAIL SIGN TRAIL CROSSING (PLAQUE)	W10-3 (MOD, RIGHT) W11-15P	36" X 36" 24" X 18"	GALVANIZED "QWIK PUNCH" POST	2"	NEW SIGN AND POST
131	201+16	12' RT	YIELD	R1-2	18" X 18" X 18"	WOOD	4" X 4"	NEW SIGN AND POST
132	201+21	12' LT	YIELD	R1-2	N/A	N/A	N/A	RELOCATE FROM 201+28.59 (8.47' LT) USE EXISTING SIGN AND POST
133	201+63	60' LT	YIELD AHEAD	W3-2	30" X 30"	GALVANIZED "QWIK PUNCH" POST	2"	NEW SIGN AND POST
134	201+46	12' LT	YIELD	R1-2	18" X 18" X 18"	WOOD	4" X 4"	NEW SIGN AND POST
135	202+08	11.5' LT	YIELD AHEAD	W3-2	N/A	N/A	N/A	RELOCATE FROM 202+08.38 (5.91' LT), USE EXISTING SIGN AND POST
136	202+63	25' RT	CROSSROAD TRAIL SIGN TRAIL CROSSING (PLAQUE)	W10-3 (MOD, RIGHT) W11-15P	36" X 36" 24" X 18"	GALVANIZED "QWIK PUNCH" POST	2"	NEW SIGN AND POST
137	206+76	11.5' RT	INTERSECTION WARNING SYMBOL	W2-1	18" X 18"	WOOD	4" X 4"	NEW SIGN AND POST
138	207+71	12' LT	YIELD	R1-2	30" X 30" X 30"	GALVANIZED "QWIK PUNCH" POST	2"	NEW SIGN AND POST
139	207+81	64' LT	YIELD AHEAD	W3-2	30" X 30"	GALVANIZED "QWIK PUNCH" POST	2"	NEW SIGN AND POST
140	208+08	15' RT	YIELD	R1-2	30" X 30" X 30"	GALVANIZED "QWIK PUNCH" POST	2"	NEW SIGN AND POST
141	209+03	11.5' LT	INTERSECTION WARNING SYMBOL	W2-1	18" X 18"	WOOD	4" X 4"	NEW SIGN AND POST
142	209+93	36' RT	CROSSROAD TRAIL SIGN TRAIL CROSSING (PLAQUE)	W10-3 (MOD, RIGHT) W11-15P	36" X 36" 24" X 18"	GALVANIZED "QWIK PUNCH" POST	2"	NEW SIGN AND POST
143	211+10	25' RT	YIELD	R1-2	18" X 18" X 18"	WOOD	4" X 4"	NEW SIGN AND POST
145	146+93	10' LT	USE PED SIGNAL	R9-5	12" X 18"	WOOD	4" X 4"	NEW SIGN AND POST
146	162+78	11' RT	SIGNAL AHEAD	W3-3	N/A	N/A	N/A	RELOCATE FROM 162+77.54 (10.26' RT), USE EXISTING SIGN AND POST
147	165+17	10' LT	USE PED SIGNAL	R9-5	12" X 18"	WOOD	4" X 4"	NEW SIGN AND POST
148	SEE PLAN	SEE PLAN	CROSSROAD TRAIL SIGN TRAIL CROSSING (PLAQUE)	W10-2 (MOD) W11-15P	36" X 36" 24" X 18"	GALVANIZED "QWIK PUNCH" POST	2"	NEW SIGN AND POST LOCATION OF SIGN SHOULD BE INSTALLED 5' AWAY THE BACK EDGE OF SIDEWALK
149	SEE PLAN	SEE PLAN	CROSSROAD TRAIL SIGN TRAIL CROSSING (PLAQUE)	W10-3 (MOD, LEFT) W11-15P	36" X 36" 24" X 18"	GALVANIZED "QWIK PUNCH" POST	2"	NEW SIGN AND POST LOCATION OF SIGN SHOULD BE INSTALLED 5' AWAY THE BACK EDGE OF SIDEWALK
150	SEE PLAN	SEE PLAN	CROSSROAD TRAIL SIGN TRAIL CROSSING (PLAQUE)	W10-3 (MOD, LEFT) W11-15P	36" X 36" 24" X 18"	GALVANIZED "QWIK PUNCH" POST	2"	NEW SIGN AND POST LOCATION OF SIGN SHOULD BE INSTALLED 5' AWAY THE BACK EDGE OF SIDEWALK
151	124+65	3.74' RT	USE PED SIGNAL	R9-5	12" X 18"	WOOD	4" X 4"	NEW SIGN AND POST
152	125+26	18.23' LT	USE PED SIGNAL	R9-5	12" X 18"	WOOD	4" X 4"	NEW SIGN AND POST

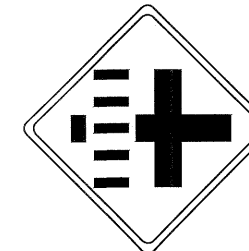

W10-2 (MOD)  
B/Y

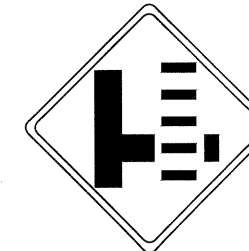

W10-3 (MOD, RIGHT)  
B/Y

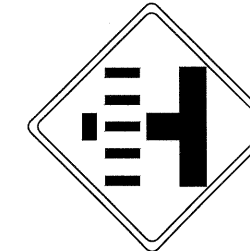

W10-3 (MOD, LEFT)  
B/Y

SIGN  
NO SCALE

LAYOUT: PSS  
 PATH: U:\Ball\Projects\Clients\1521-075-ELST\985\SS\CAMD\Phase 13\Task 02.Dwg  
 PLOTTED BY: purguban DATE: Wednesday, November 23, 2011 11:16:42 AM

REVISIONS	DATE	BY	DESIGNED
			J. JUN
			B. PURGANAN
			Y. HO
			H. LONGFELLOW

ONE INCH AT FULL SCALE.  
IF NOT, SCALE ACCORDINGLY

FILE NAME  
BL1521075P13T02PS-C1

JOB No.  
554-1521-075

DATE  
NOVEMBER 2011



**Parametrix**  
ENGINEERING · PLANNING · ENVIRONMENTAL SCIENCES

411 106TH AVENUE N.E., SUITE 1000  
BELLEVUE, WASHINGTON 98004  
T: 425.458.6200 F: 425.458.6393  
www.parametrix.com

PROJECT NAME  
**EAST LAKE SAMMAMISH  
MASTER PLAN TRAIL, ISSAQUAH SEGMENT**

GILMAN BLVD TO ISSAQUAH CITY LIMITS

**SIGN SCHEDULE**

DRAWING NO.  
80 OF 99

**PS5**

APPROVED  
DEC 02 2011  
PUBLIC WORKS ENG.  
CITY OF ISSAQUAH