

GENERAL NOTES:

- CULVERTS SHALL HAVE BEVELED END SECTIONS PER 2007 KCRS FIG. 7-001 AND DEBRIS BARRIER PER 2016 KSCWDM FIGURE 4.2.1.E, ATTACHED.
- STRUCTURE OFFSETS ARE MEASURED TO CENTER OF GRATE.
- CATCH BASIN TYPE 1 SHALL BE PER 2007 KCRS FIG. 7-003.
- CATCH BASIN TYPE 2 SHALL BE PER 2007 KCRS FIG. 7-005 AND FIG. 7-006.
- CIRCULAR FRAME (RING) AND COVER SHALL BE PER 2007 KCRS FIG. 7-022.
- RECTANGULAR SOLID METAL COVER SHALL BE PER 2007 KCRS FIG. 7-014 AND FIG. 7-015.
- CL IV RCP = CLASS IV REINFORCED CONCRETE STORM SEWER PIPE.
- CPEP = CORRUGATED POLYETHYLENE STORM SEWER PIPE.
- RECTANGULAR HERRINGBONE GRATES SHALL BE PER 2007 KCRS FIG. 7-013.
- THE CONTRACTOR SHALL LOCATE THE BURIED PIPE END. THE PIPE END WILL HAVE A MARKER ON THE GROUND SURFACE AT THE LOCATION OF THE BURIED PIPE END. CONTRACTOR SHALL CLEAN THE EXISTING BURIED PIPE, REMOVE PIPE CAP END AND CONNECT THE NEW PIPE ENSURING WATERTIGHT SEAL PER DETAIL 1 ON SHEET DD2.
- THE CONTRACTOR SHALL LOCATE THE PREVIOUSLY INSTALLED TRACER WIRE AT THE LOCATION OF THE BURIED PIPE END AND RELOCATE EXISTING TRACER WIRE TO TOP OF NEW STORM DRAIN PIPE TO THE NEAREST UPSTREAM CATCH BASIN. EXISTING TRACER WIRE WILL BE IDENTIFIED AS INSULATED 10-GAUGE SOLID COPPER.
- WORK TO BE DONE BY OTHERS WILL BE COMPLETED BEFORE CONTRACTOR WORK WILL BEGIN. THE COUNTY WILL PROVIDE THE CONTRACTOR WITH CONSTRUCTION PHOTOS OR AS-BUILT DRAWINGS THAT DEPICTS THE WORK DONE BY OTHERS TO INFORM CONTRACTOR WHERE THE BURIED PIPE END AND TRACER WIRE BENEATH THE EXISTING PAVED AREA.
- IF UTILITY CONFLICT IS FOUND AND RELOCATION OF EXISTING UTILITY IS DEEMED NECESSARY BY THE PROJECT REPRESENTATIVE, THE UTILITY RELOCATION/ADJUSTMENT WILL BE TRACKED UNDER FORCE ACCOUNT. THE UTILITY OWNER SHALL BE CONSULTED AS TO THE REPAIR APPROACH BEING PROPOSED, AND THE UTILITY CONFLICT RESOLUTION MUST BE APPROVED BY THE UTILITY OWNER.

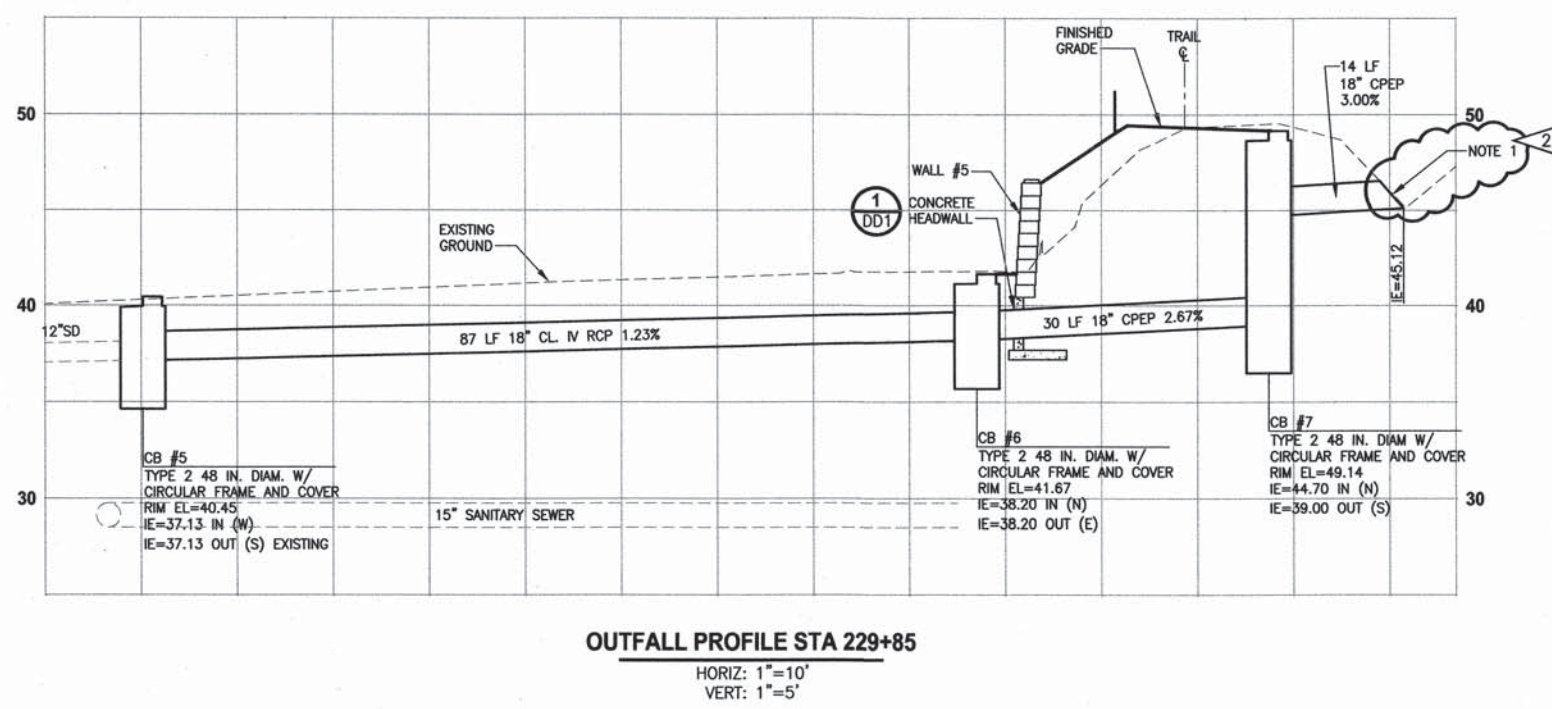
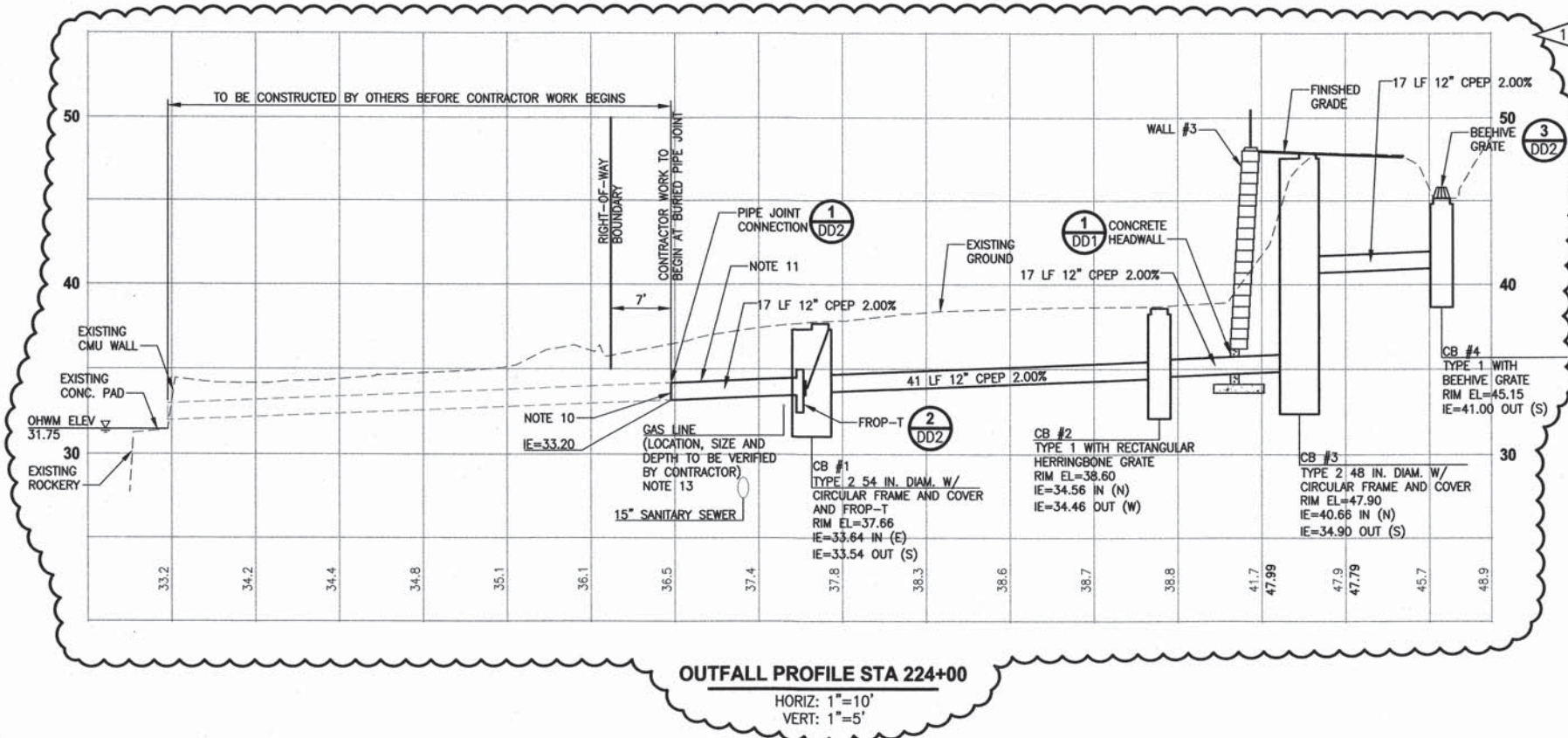

PATH: U:\P50\Projects\Gleima\1521-075-ELST\985\CA\DD\Phase 20\Task 03\DWG\ PLOTTED BY: purgbut DATE: Thursday, November 03, 2016 10:21:00 AM
 LAYOUT: SD1

REVISIONS	DATE	BY	DESIGNED
1	4/6/16	CB	C. BUITRAGO
2	11/7/16	CB	B. PURGANAN
			R. CUSHMAN
			O. KIKUTA

ONE INCH AT FULL SCALE, IF NOT, SCALE ACCORDINGLY
 FILE NAME: BL1521075P20T03SD-01
 JOB No: 554-1521-075 P20T03
 DATE: JANUARY 2016



Parametrix
 ENGINEERING · PLANNING · ENVIRONMENTAL SCIENCES
 719 2ND AVENUE, SUITE 200 | SEATTLE, WA 98104
 P 206.394.3700
 WWW.PARAMETRIX.COM

PROJECT NAME
EAST LAKE SAMMAMISH MASTER PLAN TRAIL SOUTH SAMMAMISH SEGMENT A
 SAMMAMISH, WA

CITY OF SAMMAMISH APPROVAL
 City Engineer: [Signature] Date: 11-10-16
 Community Development: [Signature] Date: 11-10-16
 DPER ACTIVITY NUMBER: GRDE14-0052 / SHORE14-0022
 FEDERAL AID # CM-2017(133)

STORM DRAINAGE PROFILES AND SECTIONS
 SHEET NO. 40 OF 78
SD1

