

**TRIBUTARY #0143H**  
**PLAN**  
SCALE IN FEET  
0 10' 20'

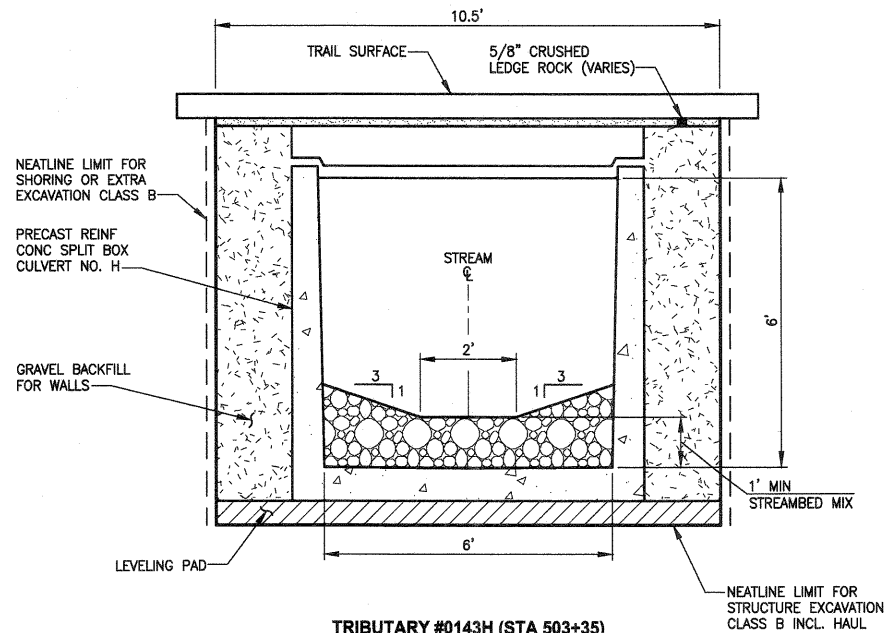

**TRIBUTARY #0143H (STA 503+35)**  
**SECTION**  
NO SCALE

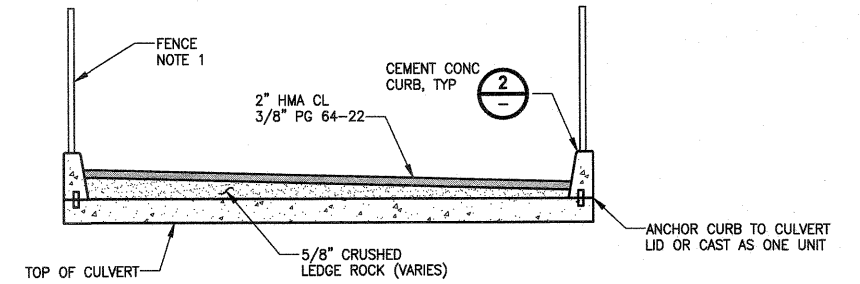

**CULVERT COVER**  
**DETAIL**  
NO SCALE

**NOTE:**  
1. FENCE SHALL BE IN LINE WITH CURBS, BUT FENCE SECTION SHALL SPAN THE CULVERT. DO NOT CONNECT POSTS TO CURBS.

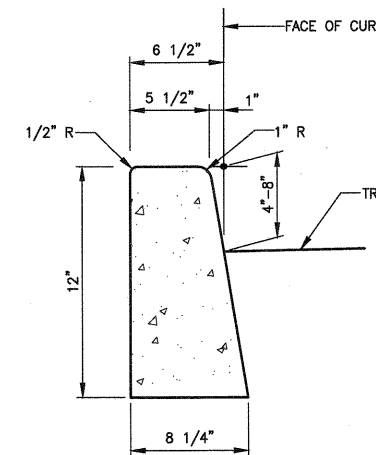

**CEMENT CONCRETE CURB**  
**DETAIL**  
NO SCALE

**NOTES:**

- CONSTRUCTION ACTIVITY FOR CULVERTS SHALL NOT OCCUR UNTIL AFTER STRUCTURAL ENGINEERING APPROVAL IS OBTAINED.
- BOX CULVERTS AND STREAM WORKS BELOW ORDINARY HIGH WATER LINE SHALL ONLY OCCUR BETWEEN JUNE 16 AND SEPTEMBER 30 PER HPA APPROVAL CONDITIONS IN APPENDIX B OF THE SPECIAL PROVISIONS.

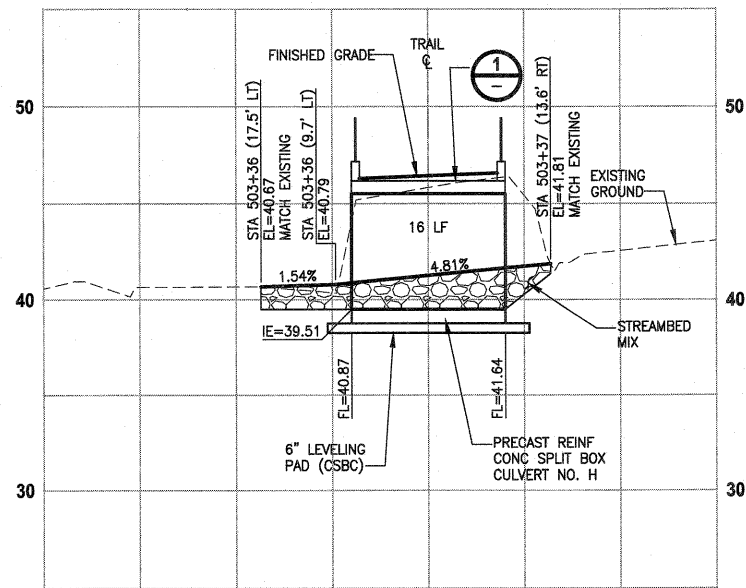

**TRIBUTARY #0143H**  
**PROFILE STA 503+36**  
HORIZ: 1"=10'  
VERT: 1"=5'



ONE INCH AT FULL SCALE, IF NOT, SCALE ACCORDINGLY  
FILE NAME: BL1521075P15T03FP-01  
JOB No.: 554-1521-075-P15T04B  
DATE: SEPTEMBER 2013

**Parametrix**  
ENGINEERING . PLANNING . ENVIRONMENTAL SCIENCES  
411 108TH AVENUE N.E., SUITE 1800  
BELLEVUE, WASHINGTON 98004  
T: 425.450.6200 F: 425.450.3303  
www.parametrix.com

PROJECT NAME  
**EAST LAKE SAMMAMISH  
MASTER PLAN TRAIL  
NORTH SAMMAMISH SEGMENT**  
SAMMAMISH, WA

**FISH PASSAGE CULVERTS**

SHEET NO.  
67 OF 127  
**FP1**

CITY OF SAMMAMISH APPROVAL  
*David Dupont* 9-16-13  
Civil Engineer Date  
*Mona Davis* 9-16-13  
Community Development Date

DPER ACTIVITY NUMBER  
GRDE12-0017/SHOR12-0003  
FEDERAL AID # STPE-2017 (126)

LAYOUT: FP1 PATH: U:\G:\Projects\Clients\1521-King\_City\554-1521-075-ELIST\995\cadd\Phase 15\Task 03\Drawg PLOTTED BY: purgabub DATE: Thursday, September 12, 2013 12:28:27 PM

REVISIONS	DATE	BY	DESIGNED
			C. BUITRAGO
			S. SIRE
			P. JOHANNESSEN
			J. DVORAK

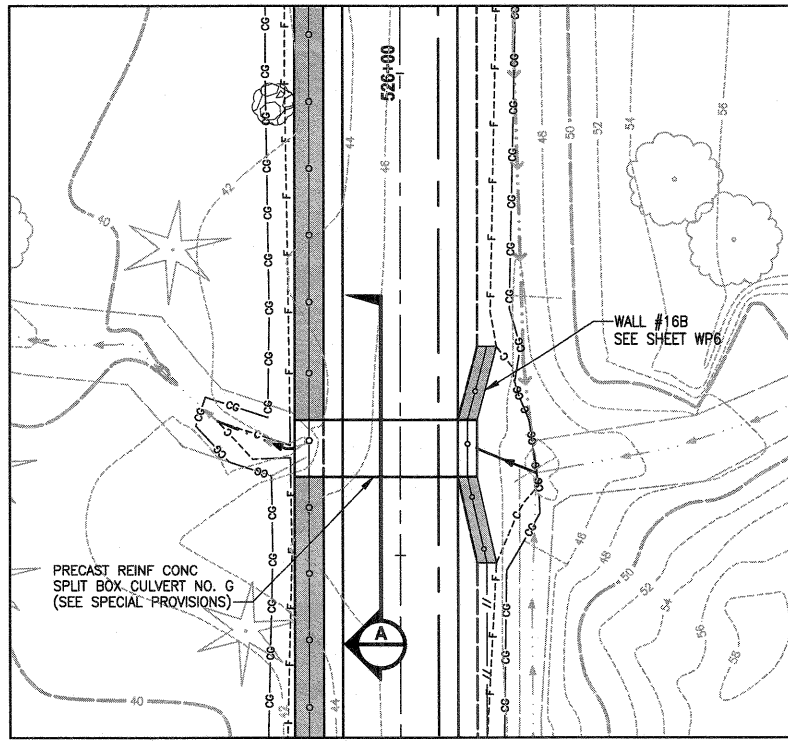

**TRIBUTARY #0143G**  
**PLAN**  
SCALE IN FEET

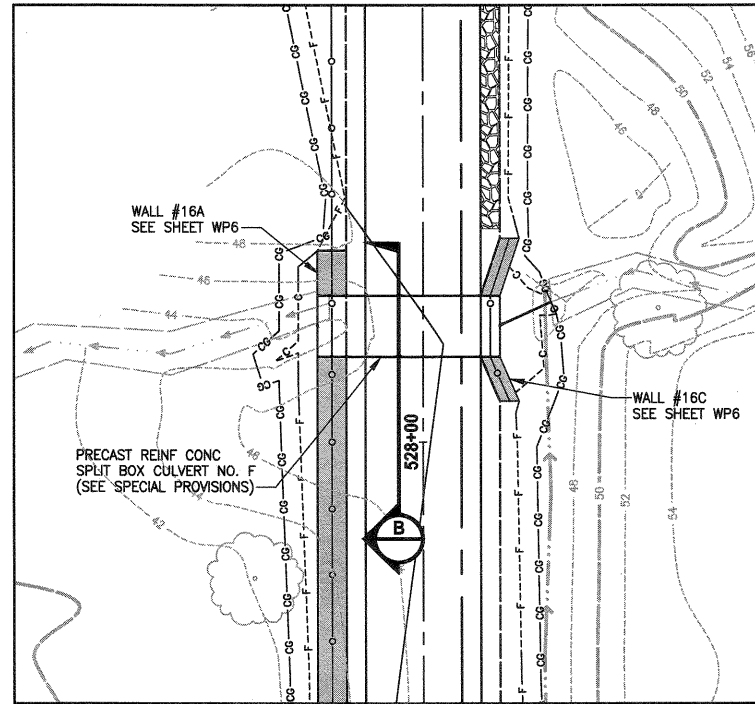

**PLAN**  
SCALE IN FEET

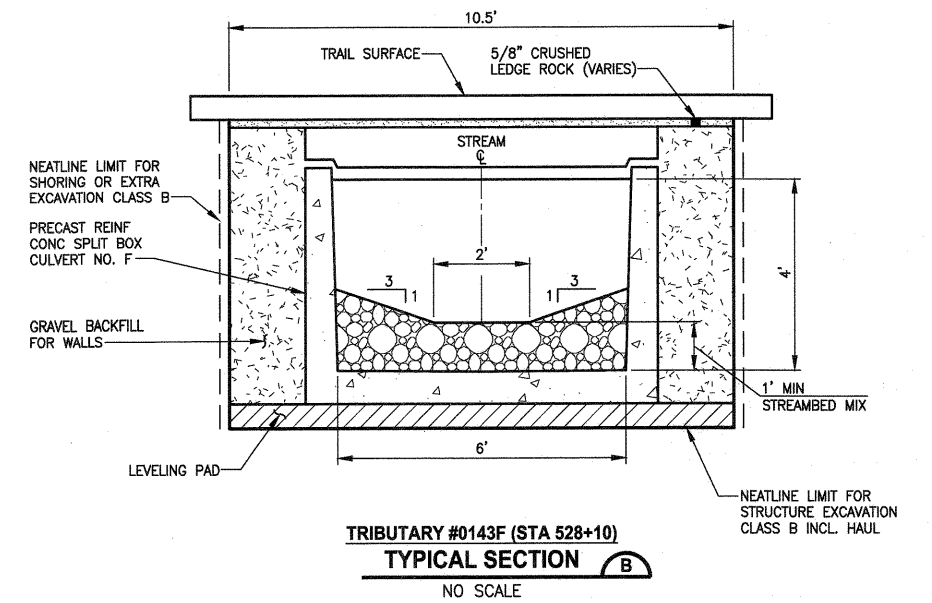
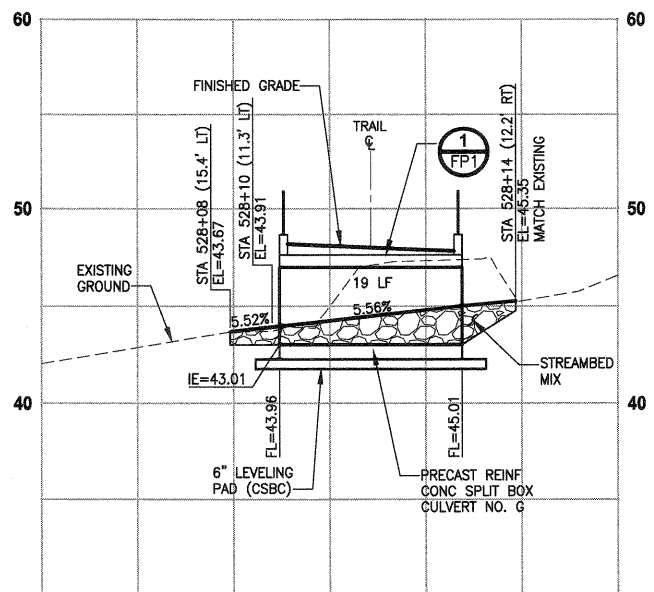
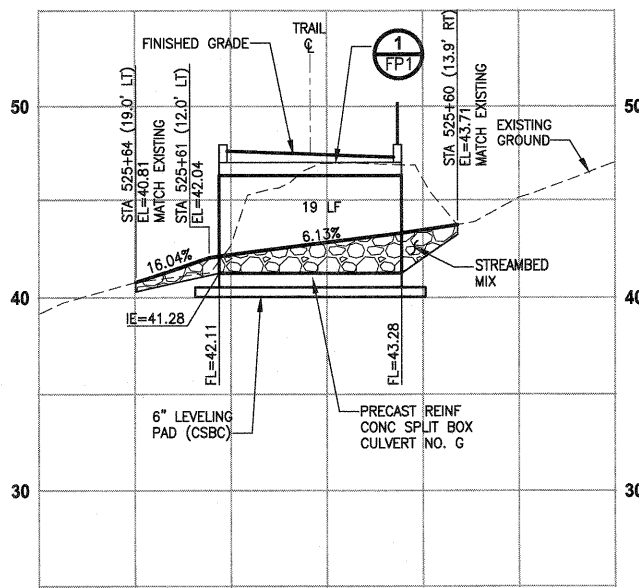
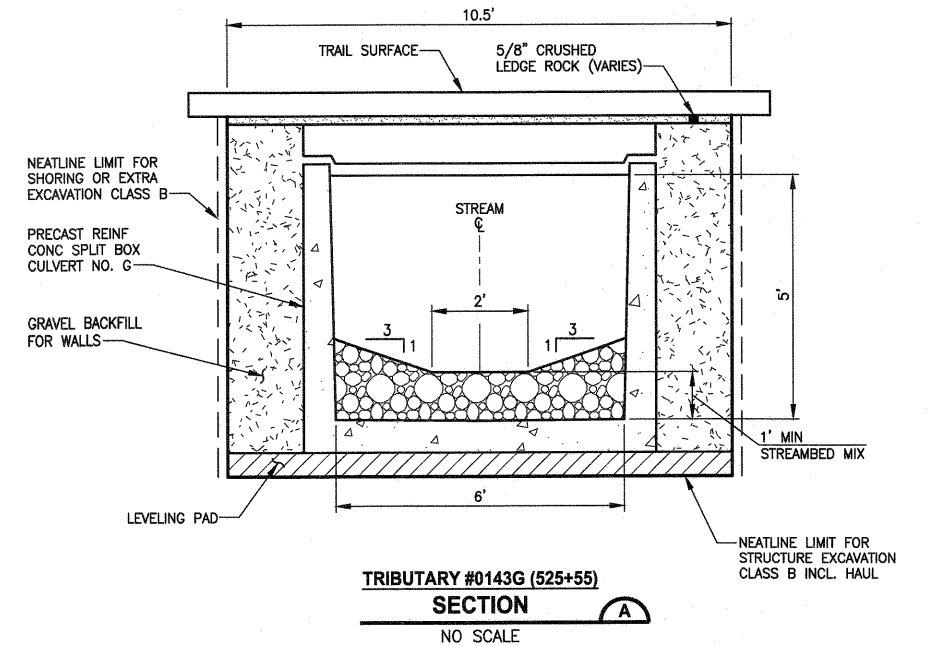

- NOTES:**
- CONSTRUCTION ACTIVITY FOR CULVERTS SHALL NOT OCCUR UNTIL AFTER STRUCTURAL ENGINEERING APPROVAL IS OBTAINED.
  - BOX CULVERTS AND STREAM WORKS BELOW ORDINARY HIGH WATER LINE SHALL ONLY OCCUR BETWEEN JUNE 16 AND SEPTEMBER 30 PER HPA APPROVAL CONDITIONS IN APPENDIX B OF THE SPECIAL PROVISIONS.

CITY OF SAMMAMISH APPROVAL

*Laura Rippe*  
City Engineer  
Date: 9.16.13

*Mona Davis*  
Community Development  
Date: 9.16.13

DPER ACTIVITY NUMBER  
GRDE12-0017/SHOR12-0003  
FEDERAL AID # STPE-2017 (126)

LAYOUT: FP2 PATH: U:\Ball\Projects\Clients\1521-075-ELST\9950ca\CADD\Phase 15\Task 03\Drawg PLOTTED BY: purgobut DATE: Thursday, September 12, 2013 12:31:19 PM

REVISIONS	DATE	BY	DESIGNED
			C. BUITRAGO
			S. SIRE
			P. JOHANNESSEN
			J. DVORAK

ONE INCH AT FULL SCALE, IF NOT, SCALE ACCORDINGLY

FILE NAME: BL1521075P15T03FP-01

JOB No. 554-1521-075-P15T04B

DATE: SEPTEMBER 2013

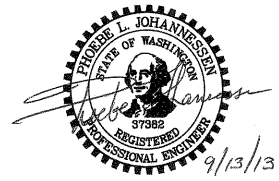

**Parametrix**  
ENGINEERING, PLANNING, ENVIRONMENTAL SCIENCES

411 108TH AVENUE N.E., SUITE 1000  
BELLEVUE, WASHINGTON 98004  
T. 425.458.6200 F. 425.458.6383  
www.parametrix.com

PROJECT NAME  
**EAST LAKE SAMMAMISH  
MASTER PLAN TRAIL  
NORTH SAMMAMISH SEGMENT**  
SAMMAMISH, WA

**FISH PASSAGE CULVERTS**

SHEET NO.  
68 OF 127

**FP2**

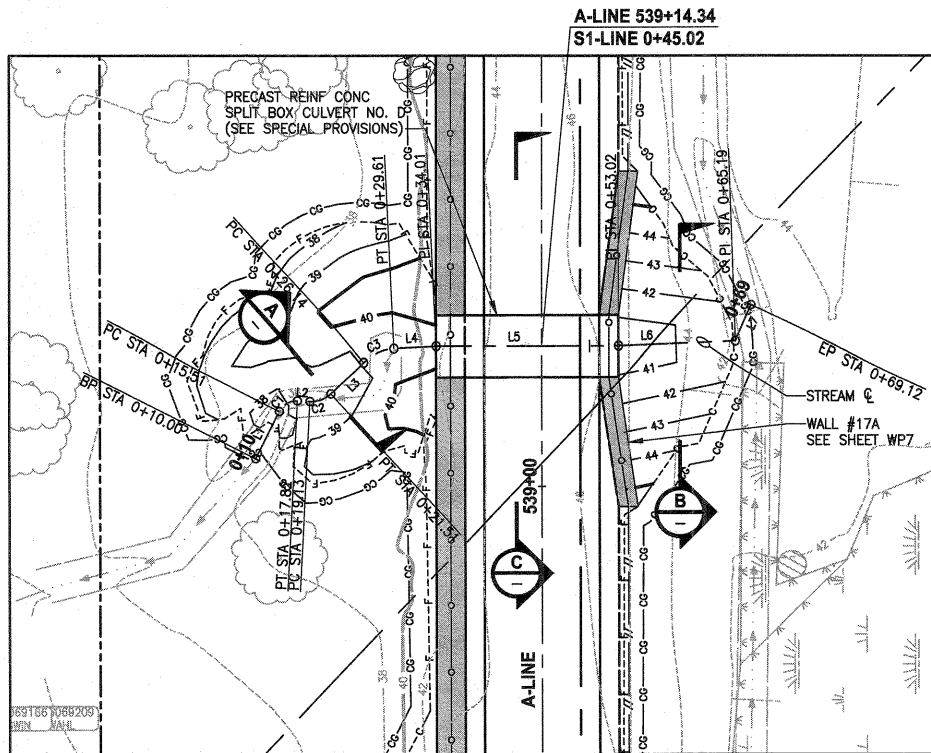

TRIBUTARY #0143D  
S1-LINE PLAN  
SCALE IN FEET  
0 10' 20'

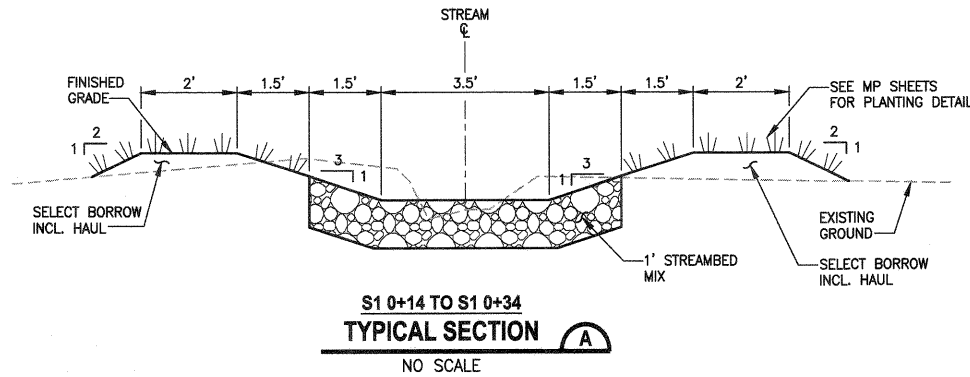

S1 0+14 TO S1 0+34  
TYPICAL SECTION A  
NO SCALE

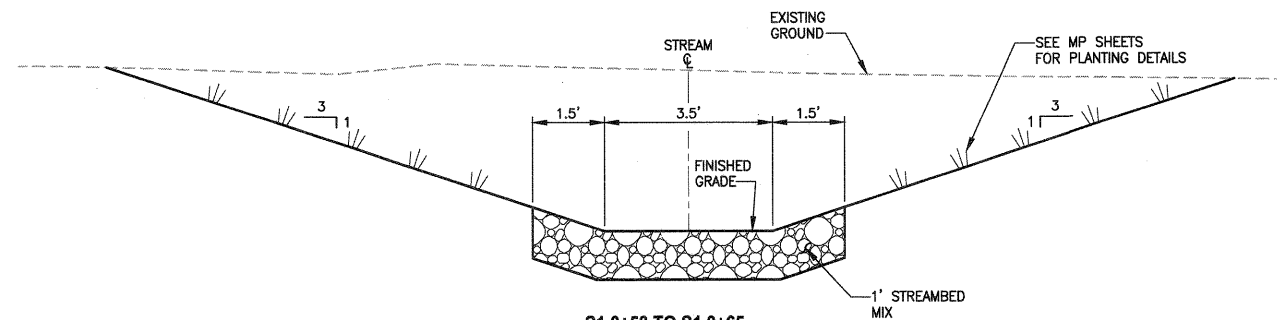

S1 0+53 TO S1 0+65  
TRIBUTARY #0143D  
TYPICAL SECTION B  
NO SCALE

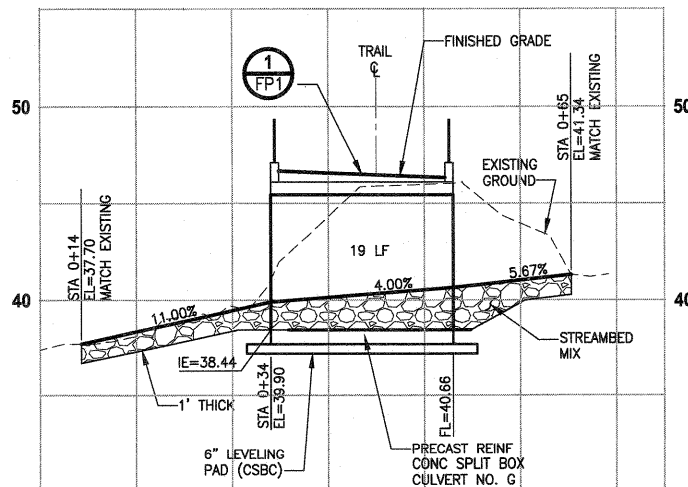

TRIBUTARY #0143D  
S1-LINE PROFILE  
HORIZ: 1"=10'  
VERT: 1"=5'

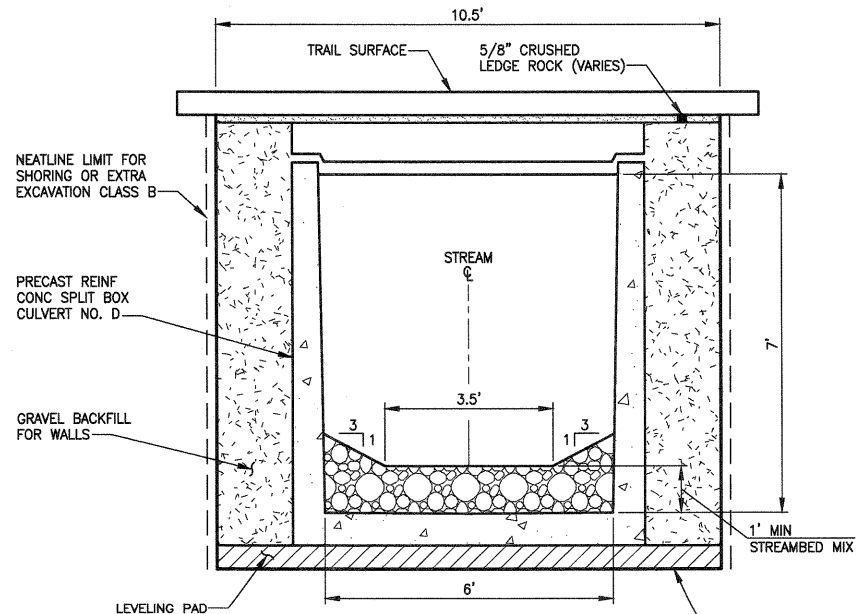

S1 0+34 TO S1 0+53  
TRIBUTARY #0143D (A 539+10)  
TYPICAL SECTION C  
NO SCALE

S1-LINE LINE TABLE

LINE TABLE		
LINE	LENGTH	BEARING
L1	5.51	N16° 23' 50.19"W
L2	1.30	N49° 53' 13.08"E
L3	4.63	N4° 24' 30.23"E
L4	4.40	N44° 12' 58.20"E
L5	19.00	N46° 47' 20.74"E
L6	12.18	N44° 55' 54.44"E
L7	3.93	N18° 30' 00.49"W

S1-LINE CURVE TABLE

CURVE TABLE			
CURVE	LENGTH	RADIUS	DELTA
C1	2.31	2.00	66°17'03"
C2	2.38	3.00	45°28'43"
C3	3.47	5.00	39°48'28"

NOTES:

- CONSTRUCTION ACTIVITY FOR CULVERTS SHALL NOT OCCUR UNTIL AFTER STRUCTURAL ENGINEERING APPROVAL IS OBTAINED.
- BOX CULVERTS AND STREAM WORKS BELOW ORDINARY HIGH WATER LINE SHALL ONLY OCCUR BETWEEN JUNE 15 AND SEPTEMBER 30 PER HPA APPROVAL CONDITIONS IN APPENDIX B OF THE SPECIAL PROVISIONS.

CITY OF SAMMAMISH APPROVAL

*Debra Phipps* City Engineer Date 9.16.13  
*Dona Davis* Community Development Date 9.16.13

DPER ACTIVITY NUMBER  
GRDE12-0017/SHOR12-0003  
FEDERAL AID # STPE-2017 (126)



**Parametrix**  
ENGINEERING · PLANNING · ENVIRONMENTAL SCIENCES  
411 108TH AVENUE N.E., SUITE 1000  
BELLEVUE, WASHINGTON 98004  
T. 425.458.8200 F. 425.458.8393  
www.parametrix.com

PROJECT NAME  
**EAST LAKE SAMMAMISH  
MASTER PLAN TRAIL  
NORTH SAMMAMISH SEGMENT**  
SAMMAMISH, WA

**FISH PASSAGE CULVERTS**

SHEET NO.  
69 OF 127  
**FP3**

PATH: U:\Ball\Projects\Clients\1521-King City\554-1521-075-ELST\985sect\CADD\Phase 15\Task 03\Draw\ PLOTTED BY: purgabud DATE: Thursday, September 12, 2013 12:32:00 PM LAYOUT: FP3

REVISIONS	DATE	BY	DESIGNED
			C. BUITRAGO
			S. SIRE
			P. JOHANNESSEN
			J. DVORAK

ONE INCH AT FULL SCALE,  
IF NOT SCALE ACCORDINGLY  
FILE NAME  
BL1521075P15T03FP-01  
JOB No.  
554-1521-075-P15T04B  
DATE  
SEPTEMBER 2013

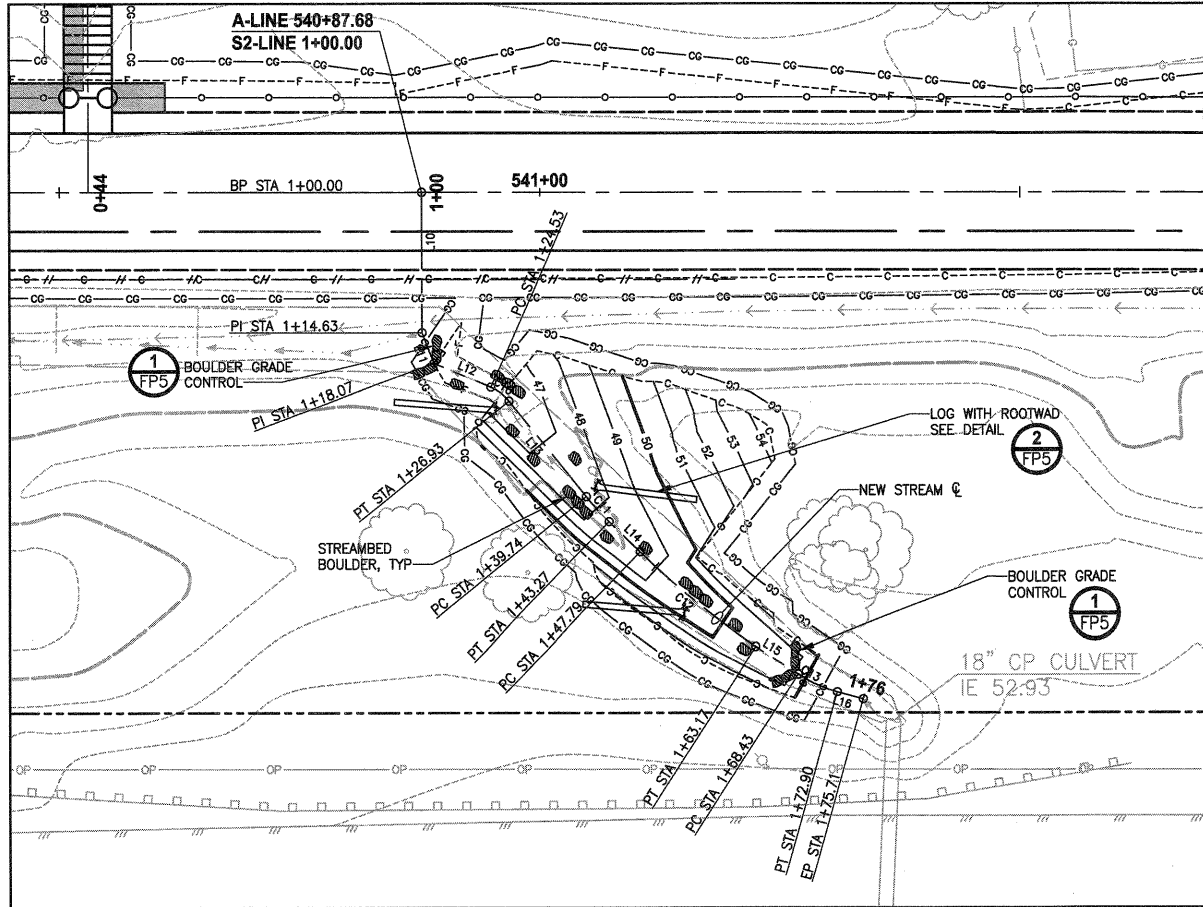

**TRIBUTARY #0143D  
S2-LINE PLAN**  
SCALE IN FEET  
0 10' 20'

**S2-LINE LINE TABLE**

LINE	LENGTH	BEARING
L10	14.63	N46° 55' 30.36"E
L11	3.44	N25° 58' 08.91"E
L12	6.46	N19° 30' 07.65"W
L13	12.81	N8° 03' 08.57"E
L14	4.52	N1° 18' 51.95"E
L15	5.26	N10° 26' 19.17"W
L16	2.82	N27° 30' 19.73"W

**S2-LINE CURVE TABLE**

CURVE	LENGTH	RADIUS	DELTA
C10	2.40	5.00	27°33'16"
C11	3.53	30.00	6°44'17"
C12	15.38	75.00	11°45'11"
C13	4.47	15.00	17°04'01"

**NOTE:**  
1. BOX CULVERTS AND STREAM WORKS BELOW ORDINARY HIGH WATER LINE SHALL ONLY OCCUR BETWEEN JUNE 16 AND SEPTEMBER 30 PER HPA APPROVAL CONDITIONS IN APPENDIX B OF THE SPECIAL PROVISIONS.

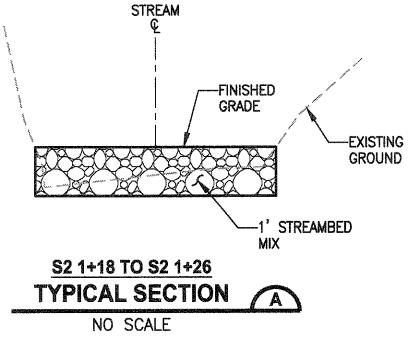

**S2 1+18 TO S2 1+26  
TYPICAL SECTION A**  
NO SCALE

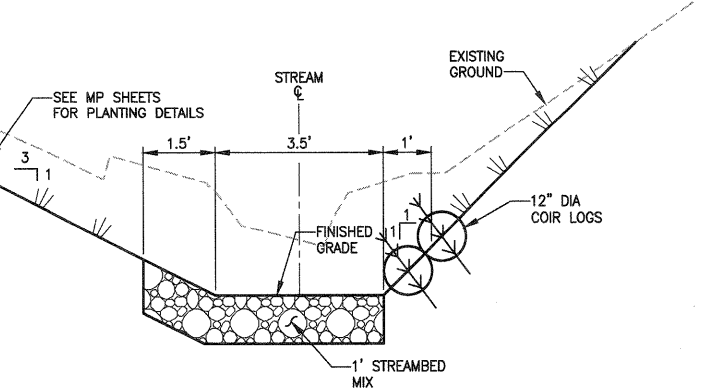

**S2 1+26 TO S2 1+53  
TYPICAL SECTION B**  
NO SCALE

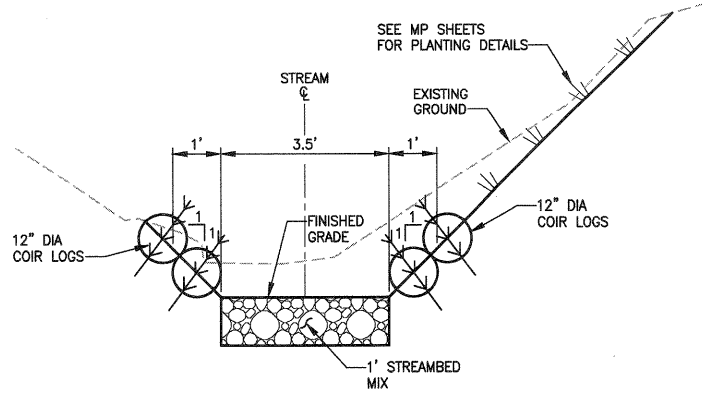

**S2 1+53 TO S2 1+69  
TYPICAL SECTION C**  
NO SCALE

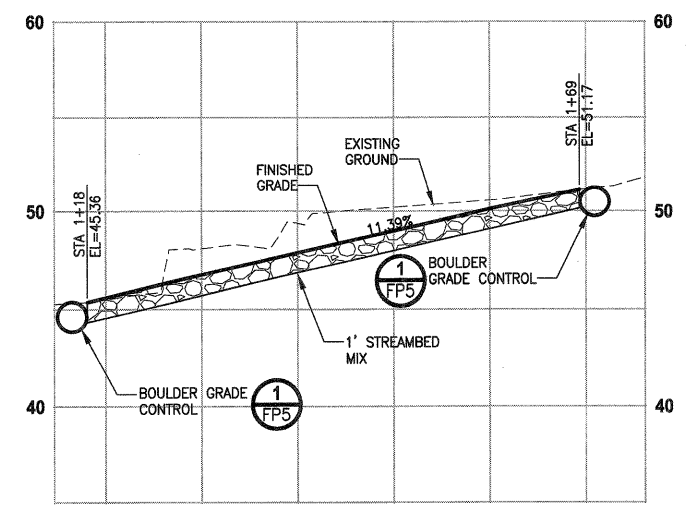

**TRIBUTARY #0143D  
S2-LINE PROFILE**  
HORIZ: 1"=10'  
VERT: 1"=5'

CITY OF SAMMAMISH APPROVAL  
*Laura Hilpot* 9-16-13  
 Date  
*Mona Davis* 9-16-13  
 Date  
 Community Development

DPER ACTIVITY NUMBER  
 GRDE12-0017/SHOR12-0003  
 FEDERAL AID # STPE-2017 (126)

LAYOUT: SR1  
 PATH: U:\Gm\Projects\Clients\1521-King\_City\554-1521-075-ELST\995vca\CADD\Phase 15\Task 03\Dwg\  
 PLOTTED BY: purgabut DATE: Thursday, September 12, 2013 12:36:56 PM

REVISIONS	DATE	BY	DESIGNED
			C. BUITRAGO
			B. PURGANAN
			P. JOHANNESSEN
			J. DVORAK

ONE INCH AT FULL SCALE.  
 IF NOT, SCALE ACCORDINGLY  
 FILE NAME  
 BL1521075P15T03SR-01  
 JOB No.  
 554-1521-075-P15T04B  
 DATE  
 SEPTEMBER 2013



**Parametrix**  
 ENGINEERING . PLANNING . ENVIRONMENTAL SCIENCES  
 411 108TH AVENUE N.E., SUITE 1600  
 BELLEVUE, WASHINGTON 98004  
 T. 425.450.6200 F. 425.450.6393  
 www.parametrix.com

PROJECT NAME  
**EAST LAKE SAMMAMISH  
 MASTER PLAN TRAIL  
 NORTH SAMMAMISH SEGMENT**  
 SAMMAMISH, WA

**STREAM RESTORATION**

SHEET NO.  
 70 OF 127  
**SR1**

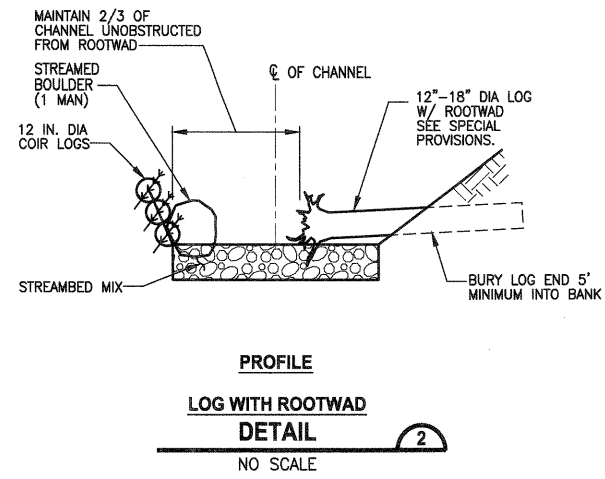
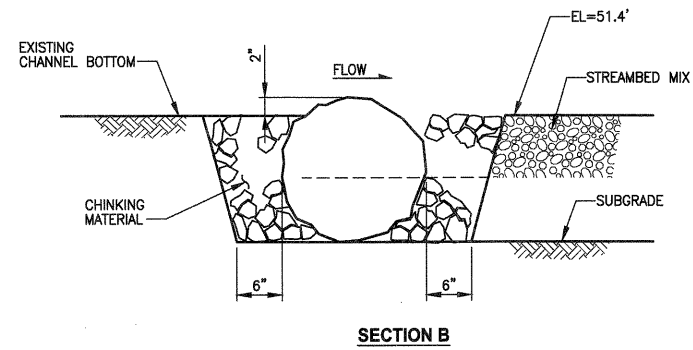
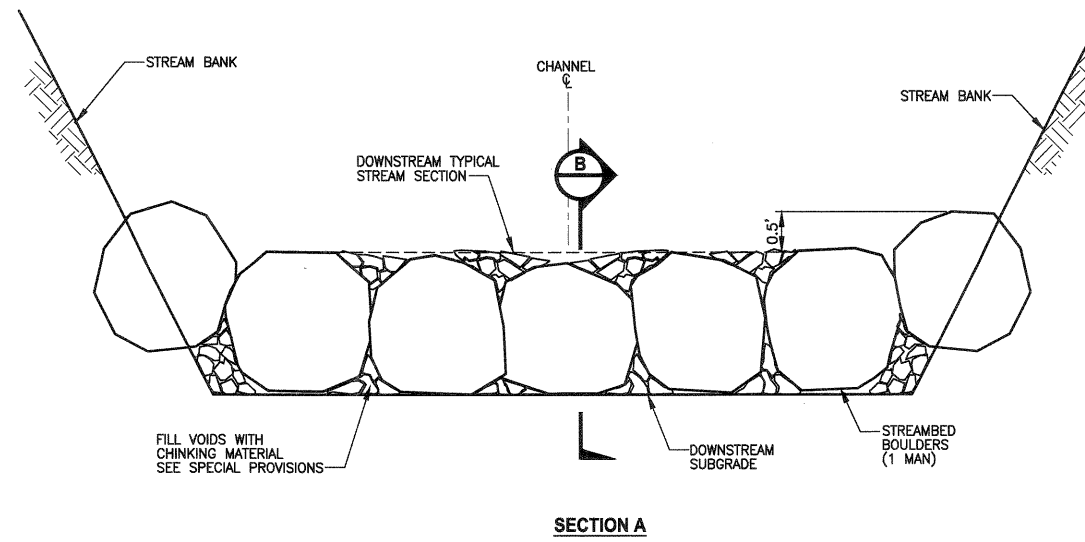
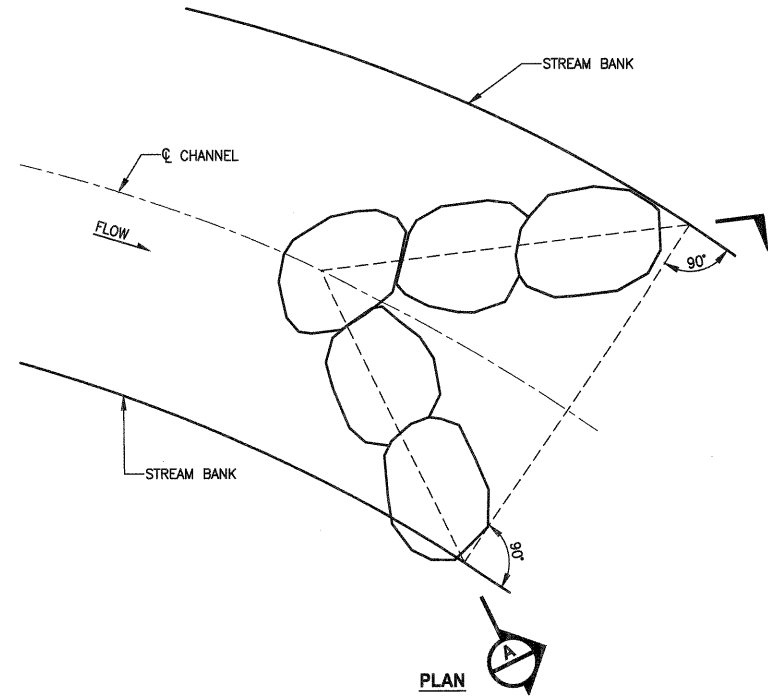

LAYOUT: SR2 PATH: U:\Ball\Projects\Clients\1521-Hing\_City\554-1521-075-ELST\98Secs\CADD\Phase 15\Task 03\Draws\ PLOTTED BY: purgabout DATE: Thursday, September 12, 2013 12:37:43 PM

CITY OF SAMMAMISH APPROVAL	
<i>Laura Pugh</i> City Engineer	9.16.13 Date
<i>Mona Dachs</i> Community Development	9.16.13 Date

DPER ACTIVITY NUMBER  
GRDE12-0017/SHOR12-0003  
FEDERAL AID # STPE-2017 (126)



**Parametrix**  
ENGINEERING . PLANNING . ENVIRONMENTAL SCIENCES  
411 106TH AVENUE N.E., SUITE 1000  
BELLEVUE, WASHINGTON 98004  
T. 425.458.6200 F. 425.458.6393  
www.parametrix.com

PROJECT NAME  
**EAST LAKE SAMMAMISH  
MASTER PLAN TRAIL  
NORTH SAMMAMISH SEGMENT**  
SAMMAMISH, WA

**STREAM RESTORATION**

SHEET NO.  
71 OF 127  
**SR2**

REVISIONS	DATE	BY	DESIGNED
			C. BUJTRAGO
			B. PURGANAN
			P. JOHANNESSEN
			J. DVORAK

ONE INCH AT FULL SCALE.  
IF NOT, SCALE ACCORDINGLY  
FILE NAME  
BL1521075P15T03SR-01  
JOB No.  
554-1521-075-P15T04B  
DATE  
SEPTEMBER 2013