

SEC. 26, 34 & 35, T 20 N, R 6 E, W.M.



King County

Department of Natural Resources and Parks
Parks and Recreation Division

King Street Center, KSC-NR-0700
201 So. Jackson Street, Suite 700
Seattle, Washington 98104
Telephone: (206) 477-4527
Fax: (206) 263-6217

HUITZOLARS
Professional Engineer
816 Stewart St, Suite 1120
Seattle, Washington, 98101-1479
Phone (206) 324-6500 Fax (206) 328-8880

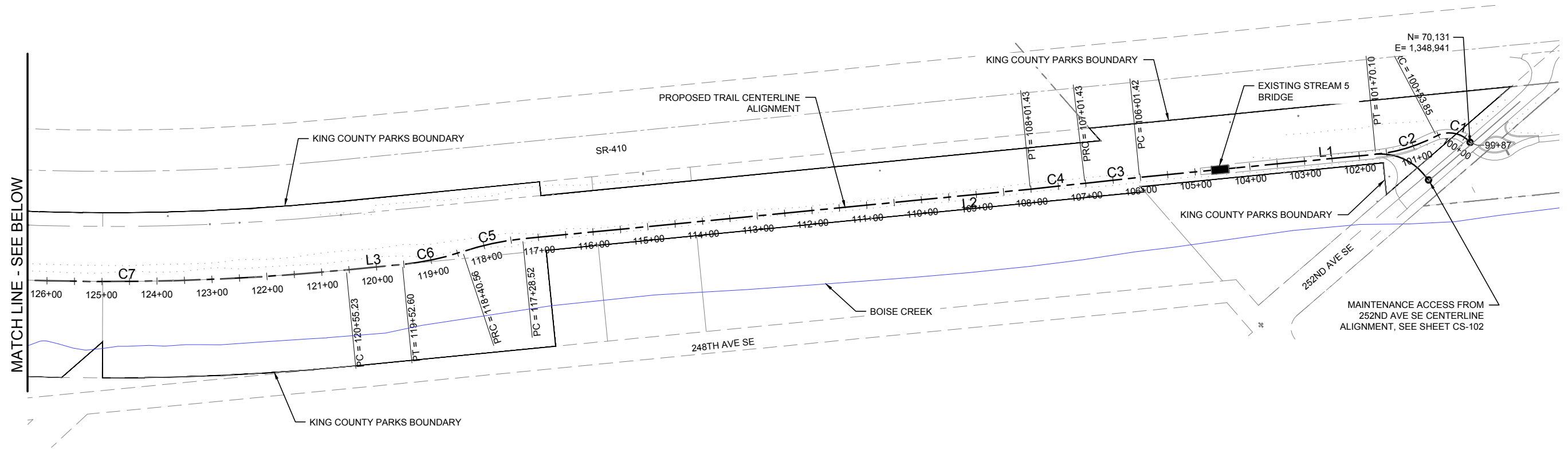

TRAIL CENTERLINE ALIGNMENT LINES AND CURVES DATA

LINE TABLE				
LINE #	LENGTH	BEARING	START STATION	END STATION
L1	431.32'	S35° 55' 28.37"W	101+70.10	106+01.42
L2	927.09'	S35° 55' 28.37"W	108+01.43	117+28.52
L3	102.64'	S35° 55' 28.29"W	119+52.60	120+55.23
L4	128.88'	S50° 14' 19.51"W	131+58.16	132+87.04
L5	309.06'	S57° 24' 43.49"W	135+37.44	138+46.49
L6	58.45'	S0° 04' 41.78"E	141+72.51	142+30.96
L7	151.56'	S72° 40' 17.49"W	146+94.98	148+46.54
L8	49.56'	S13° 17' 58.75"E	148+46.54	148+96.10
L9	551.30'	S20° 43' 28.37"W	155+30.47	160+81.77

CURVE TABLE				
CURVE #	RADIUS	LENGTH	START STATION	END STATION
C5	500'	112.04'	117+28.52	118+40.56
C2	300'	116.25'	100+53.85	101+70.10
C1	50'	67.15'	99+86.70	100+53.85
C3	5,000'	100.00'	106+01.42	107+01.43
C4	5,000'	100.00'	107+01.43	108+01.43
C6	500'	112.04'	118+40.56	119+52.60
C7	4,447'	846.48'	120+55.23	129+01.71
C8	400'	101.34'	129+01.71	130+03.05
C9	800'	155.11'	130+03.05	131+58.16
C10	2,000'	250.40'	132+87.04	135+37.44
C11	400'	87.38'	138+46.49	139+33.87
C12	200'	86.47'	139+33.87	140+20.34
C13	125'	152.16'	140+20.34	141+72.51
C14	150'	83.87'	142+30.96	143+14.82
C15	300'	231.82'	143+14.82	145+46.65
C16	100'	148.33'	145+46.65	146+94.98
C17	30'	40.10'	148+96.10	149+36.20
C18	800'	594.27'	149+36.20	155+30.47

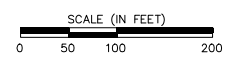
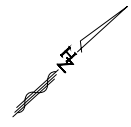
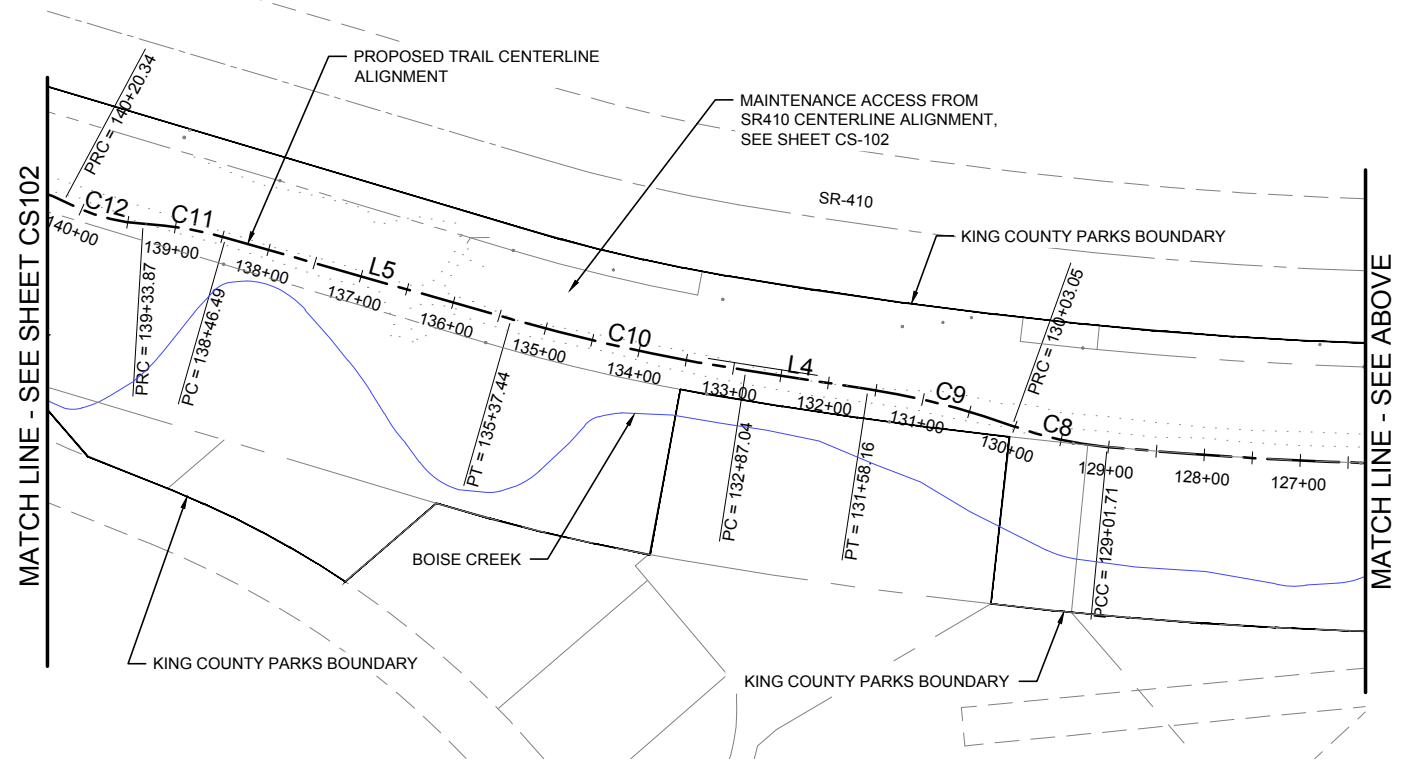

ISSUE / REVISIONS		
ID	DATE	DESCRIPTION
△	6/6/16	30% SUBMITTAL
△	7/27/16	60% SUBMITTAL

PROJECT NO. 15095303
SITE NO.
FILE
CONTRACT NO. E00115E08 - AM. 8
DRAWN BY VUL CHECKED BY GS

SHEET TITLE
ALIGNMENTS
LAYOUT
LINES
AND
CURVES TABLE

CS-101

FOOTHILLS TRAIL
TRAIL IMPROVEMENTS - PHASE II
KING COUNTY DEPT. OF NATURAL RESOURCES & PARKS

J:\15095303 Foothills Trail Amd 716_AMENDMENT 811_DESIGN_CAD\60% sheet files\ 15095303-CS101.dwg Friday, September 09, 2016 11:30am

60% SUBMITTAL

SEC. 26, 34 & 35, T 20 N, R 6 E, W.M.

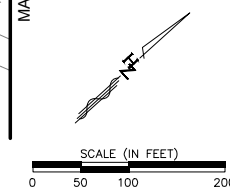
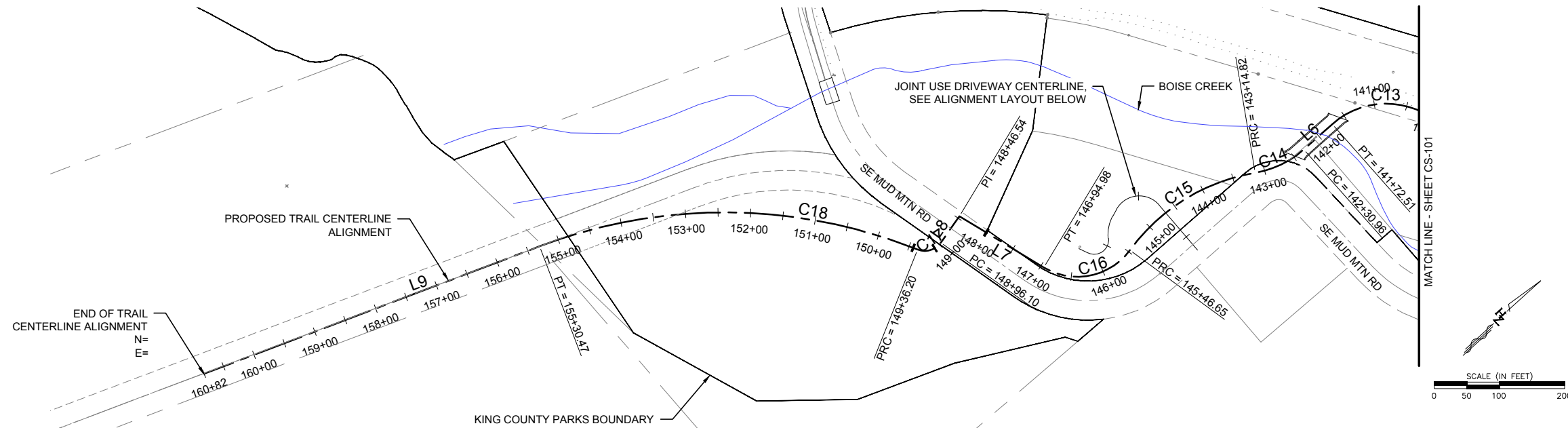

ACCESS AND DRIVEWAY CENTERLINE ALIGNMENT LINES AND CURVES DATA

LINE TABLE				
LINE #	LENGTH	BEARING	START STATION	END STATION
L110	203.62'	N55° 17' 28.88"E	1+21.19	3+24.82
L111	8.53'	S39° 45' 40.49"E	3+76.71	3+85.24
L120	15.56'	N66° 03' 59.98"E	0+00.00	0+15.56
L121	11.68'	N19° 06' 26.69"W	0+97.35	1+09.02
L122	90.71'	S89° 04' 29.68"E	1+85.84	2+76.55
L100	16.51'	N89° 19' 36.31"W	200+00.00	200+16.51

CURVE TABLE				
CURVE #	RADIUS	LENGTH	START STATION	END STATION
C110	100'	121.19'	0+00.00	1+21.19
C111	35'	51.89'	3+24.82	3+76.71
C120	22'	46.12'	0+15.56	0+61.68
C121	58'	35.67'	0+61.68	0+97.35
C122	40'	76.82'	1+09.02	1+85.84
C100	100'	95.55'	200+16.51	201+12.07

NOTE: TRAIL LINES AND CURVES DATA ON SHEET CS-101

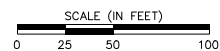
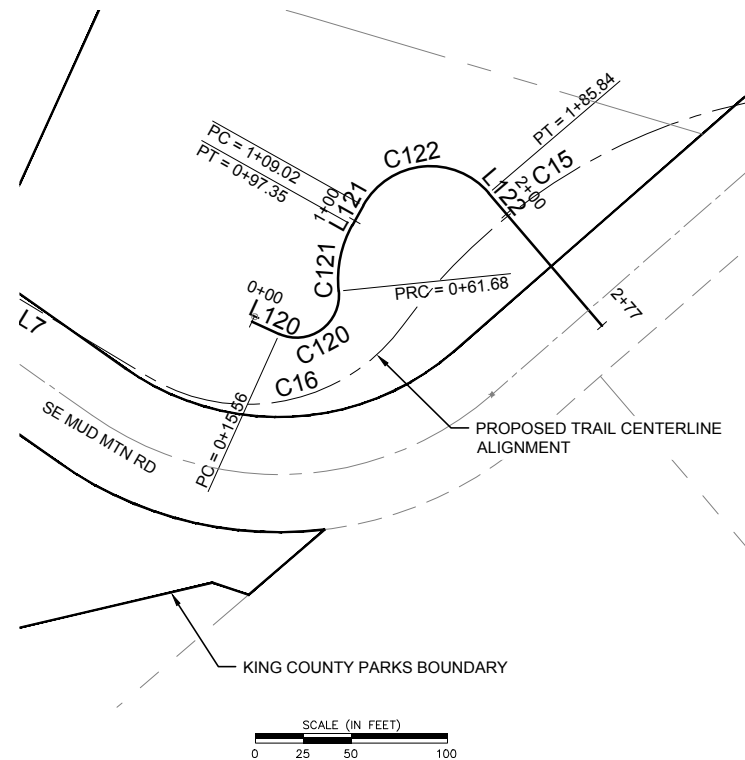

JOINT USE DRIVEWAY CENTERLINE ALIGNMENT

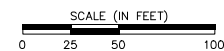
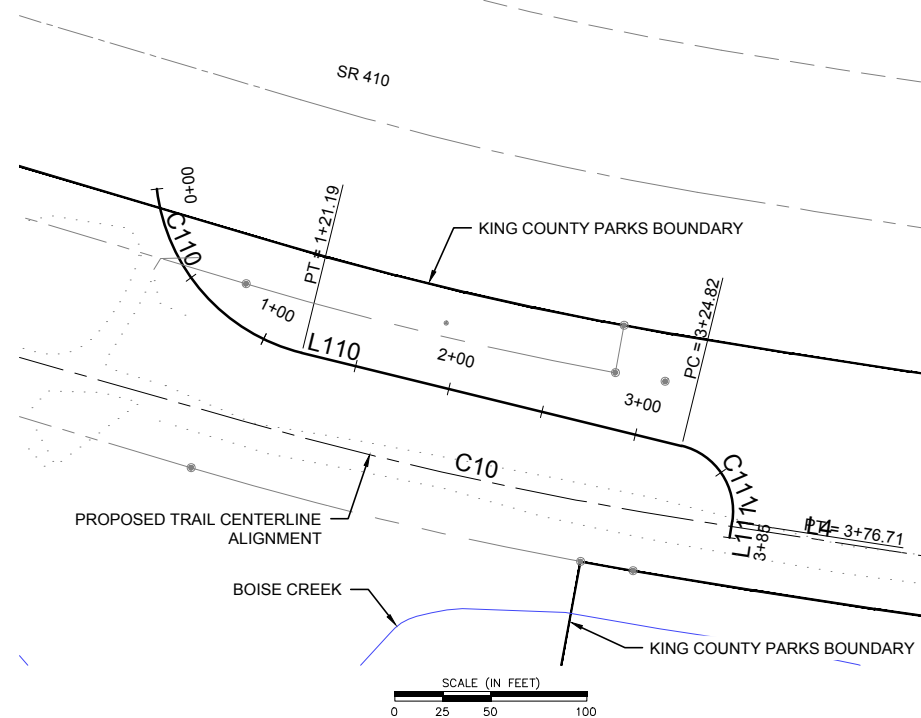

MAINTENANCE ACCESS FROM SR410 CENTERLINE ALIGNMENT

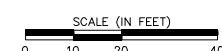
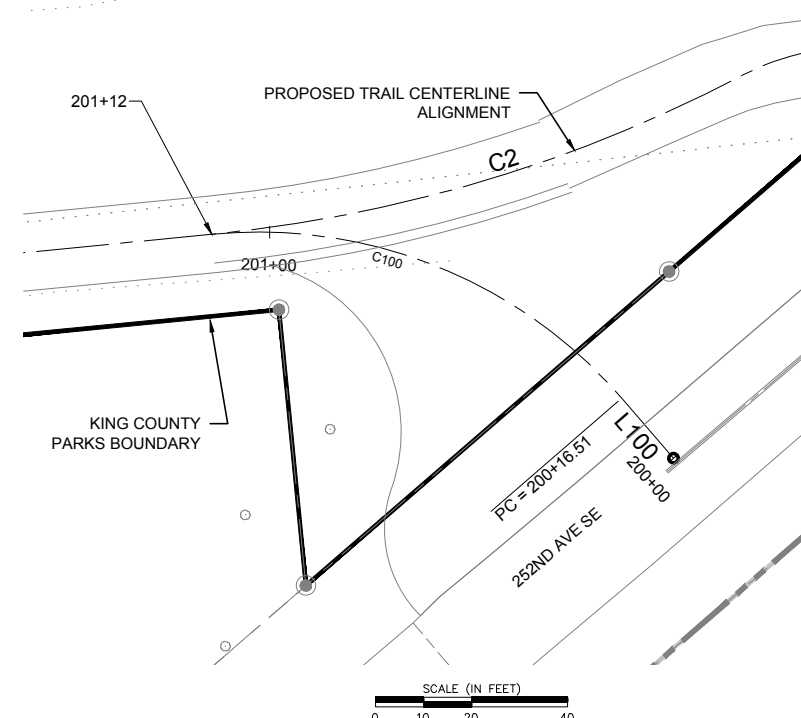

MAINTENANCE ACCESS FROM 252ND AVE SE CENTERLINE ALIGNMENT



Department of Natural Resources and Parks
 Parks and Recreation Division
 King Street Center, KSC-NR-0700
 201 So. Jackson Street, Suite 700
 Seattle, Washington 98104
 Telephone: (206) 477-4527
 Fax: (206) 263-6217

HUITZOLARS
 Professional Engineer
 818 Stewart St, Suite 1120
 Seattle, Washington, 98101-1479
 Phone (206) 324-6500 Fax (206) 328-8880



FOOTHILLS TRAIL
 TRAIL IMPROVEMENTS - PHASE II
 KING COUNTY DEPT. OF NATURAL RESOURCES & PARKS

ISSUE / REVISIONS		
ID	DATE	DESCRIPTION
△ 6/6/16		30% SUBMITTAL
△ 7/27/16		60% SUBMITTAL

PROJECT NO. 15095303
 SITE NO.
 FILE
 CONTRACT NO. E00115E08 - AM. 8
 DRAWN BY VUL CHECKED BY GS

SHEET TITLE
 ALIGNMENTS LAYOUT LINES AND CURVES TABLE

CS-102

J:\15095303 Foothills Trail Amd 716_AMENDMENT 811_DESIGN_CAD\60% sheet files\ 15095303-CS102.dwg Friday, September 09, 2016 11:31am

60% SUBMITTAL