

KING COUNTY DEPARTMENT OF NATURAL RESOURCES AND PARKS FOOTHILLS TRAIL IMPROVEMENTS - PHASE II

KING COUNTY, WASHINGTON

KING COUNTY CONTRACT NO. : E00115E08

HUITT-ZOLLARS PROJECT NO. : 15095303 AMENDMENT 8

AREA MAP

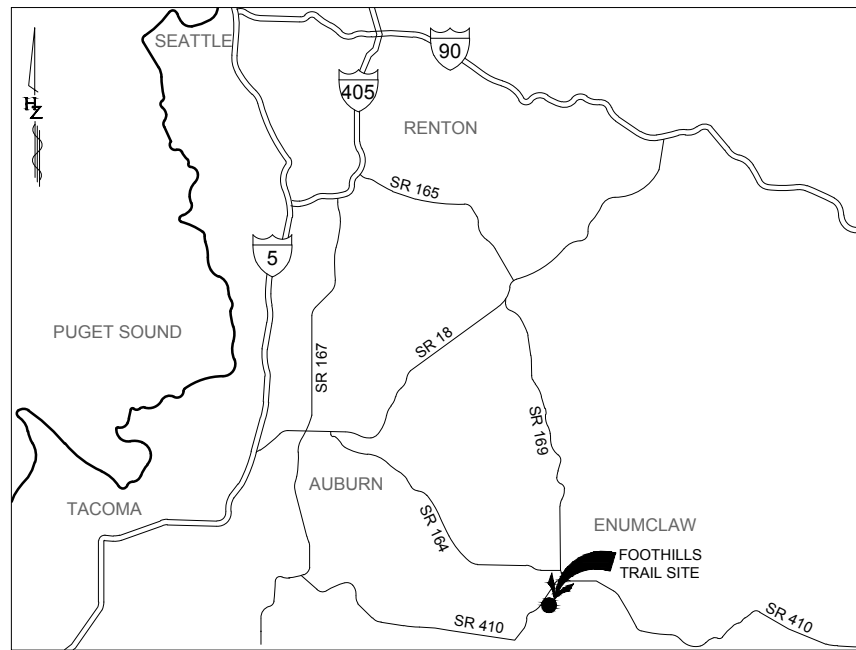

PROJECT MAP

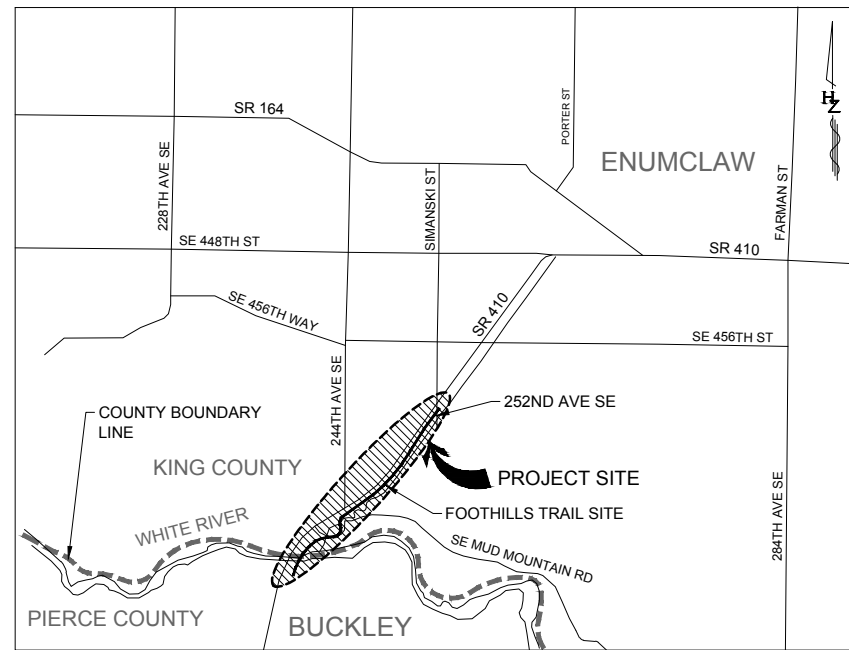

Department of Natural Resources
and Parks
Parks and Recreation Division
King Street Center, KSC-NR-0700
201 So. Jackson Street, Suite 700
Seattle, Washington 98104
Telephone: (206) 477-4527
Fax: (206) 263-6217

HUITT-ZOLLARS
Professional Engineers
1120 Stewart St., Suite 1120
Seattle, Washington, 98101-1479
Phone (206) 324-4500 Fax (206) 328-8880

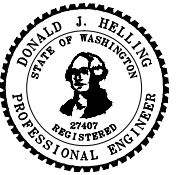

**FOOTHILLS TRAIL
TRAIL IMPROVEMENTS - PHASE II**
KING COUNTY DEPT. OF NATURAL RESOURCES & PARKS

ISSUE / REVISIONS		
ID	DATE	DESCRIPTION
△	6/6/16	30% SUBMITTAL
△	7/27/16	60% SUBMITTAL

PROJECT NO. 15095303
SITE NO.
FILE
CONTRACT NO. E00115E08 - AM. 8
DRAWN BY LAJ CHECKED BY GS
SHEET TITLE
COVER SHEET

CONTACTS

APPLICANT

KING COUNTY PARKS
201 SOUTH JACKSON ST., ROOM 700
SEATTLE, WA 98104

CONTACT: CHRIS ERICKSON
PHONE: (206) 477-4564

SURVEY

LIN & ASSOCIATES, INC.
901 FIFTH AVENUE, SUITE 1610
SEATTLE, WA 98164

CONTACT: ADOLPH FURTADO, PE
PHONE: (206) 621-1218 EXT. 14

PRIME - CIVIL

HUITT-ZOLLARS
818 STEWART ST., SUITE 1120
SEATTLE, WA 98101

CONTACT: DON HELLING, PE
PHONE: (206) 324-5500

ENVIRONMENTAL

THE WATERSHED COMPANY
750 6TH STREET SOUTH
KIRKLAND, WA 98033

CONTACT: HUGH MORTENSEN, PWS
PHONE: (425) 822-5242

CULTURAL RESOURCES

CULTURAL RESOURCE CONSULTANTS, INC.
197 PARFITT WAY SW, SUITE 100
P.O. BOX 10668
BAINBRIDGE ISLAND, WA 98110

CONTACT: GLENN HARTMANN
PHONE: (206) 855-9020

GEOTECHNICAL

HART CROWSER
3131 ELLIOTT AVE, SUITE 600
SEATTLE, WA 98121

CONTACT: JEFFREY WAGNER, PE
PHONE: (206) 324-9530

STRUCTURAL

EXELTECH CONSULTING, INC.
8729 COMMERCE PLACE DRIVE NE, SUITE A
LACEY, WA 98516

CONTACT: EVAN GRIMM
PHONE: (360) 357-8289 EXT. 1121

DATUM:

HORIZONTAL DATUM: NORTH AMERICAN DATUM OF 1983 / 1991 ADJUSTMENT (NAD 83/91), WASHINGTON NORTH ZONE.

VERTICAL DATUM: NORTH AMERICAN VERTICAL DATUM OF 1988 (NAVD 88)

PROJECT VERTICAL CONTROL: LIN & ASSOCIATES CONTROL POINT, ELEV. XXX, SEE CS101.

60% SUBMITTAL

GI-001

SHEET INDEX

CIVIL

SHEET	DRAWING	DESCRIPTION
1	GI-001	COVER SHEET
2	GI-002	SHEET INDEX
3	GI-003	NOTES, LEGENDS, AND ABBREVIATION
4	GI-004	OVERALL TRAIL PLAN KEY MAP
5	CS-101	ALIGNMENTS LAYOUT, LINES AND CURVES TABLE
6	CS-102	ALIGNMENTS LAYOUT, LINES AND CURVES TABLE
7	CE-101	EROSION CONTROL PLAN STA 100+00 TO STA 108+00
8	CE-102	EROSION CONTROL PLAN STA 108+00 TO STA 116+00
9	CE-103	EROSION CONTROL PLAN STA 116+00 TO STA 124+00
10	CE-104	EROSION CONTROL PLAN STA 124+00 TO STA 132+25
11	CE-105	EROSION CONTROL PLAN STA 132+25 TO STA 141+00
12	CE-106	EROSION CONTROL PLAN STA 141+00 TO STA 144+50
13	CE-107	EROSION CONTROL PLAN STA 144+50 TO STA 148+00
14	CE-108	EROSION CONTROL PLAN STA 148+00 TO STA 152+00
15	CE-109	EROSION CONTROL PLAN STA 152+00 TO STA 155+00
16	CE-110	EROSION CONTROL PLAN STA 155+00 TO STA 161+00
17	CE-501	EROSION CONTROL NOTES AND DETAILS
18	CE-502	EROSION CONTROL DETAILS
19	CG-101	GRADING PLAN AND PROFILE STA 100+00 TO STA 104+00
20	CG-102	GRADING PLAN AND PROFILE STA 104+00 TO STA 108+00
21	CG-103	GRADING PLAN AND PROFILE STA 108+00 TO STA 112+00
22	CG-104	GRADING PLAN AND PROFILE STA 112+00 TO STA 116+00
23	CG-105	GRADING PLAN AND PROFILE STA 116+00 TO STA 120+00
24	CG-106	GRADING PLAN AND PROFILE STA 120+00 TO STA 124+00
25	CG-107	GRADING PLAN AND PROFILE STA 124+00 TO STA 128+00
26	CG-108	GRADING PLAN AND PROFILE STA 128+00 TO STA 132+25
27	CG-109	GRADING PLAN AND PROFILE STA 132+25 TO STA 136+75
28	CG-110	GRADING PLAN AND PROFILE STA 136+75 TO STA 141+00
29	CG-111	GRADING PLAN STA 141+00 TO STA 144+50
30	CG-112	GRADING PROFILE STA 141+00 TO STA 144+50
31	CG-113	GRADING PLAN STA 144+50 TO STA 148+00
32	CG-114	GRADING PROFILE STA 144+50 TO STA 148+00
33	CG-115	GRADING PLAN STA 148+00 TO STA 152+00
34	CG-116	GRADING PROFILE STA 148+00 TO STA 152+00
35	CG-117	GRADING PLAN STA 152+00 TO STA 154+75
36	CG-118	GRADING PROFILE STA 152+00 TO STA 154+75
37	CG-119	GRADING PLAN STA 154+75 TO STA 158+75
38	CG-120	GRADING PROFILE STA 154+75 TO STA 158+75
39	CG-121	GRADING PLAN AND PROFILE STA 158+75 TO STA 161+00
40	CG-122	GRADING PLAN ACCESS FROM 252ND AVE SE
41	CG-123	GRADING PLAN AND PROFILE ACCESS FROM SR-410
42	CG-124	GRADING PROFILE HOUSE # 24316 & # 24324 DRIVEWAY
43	CG-201	WALL PROFILES WALLS 1 - 2
44	CG-202	WALL PROFILES WALLS 3 - 6
45	CG-203	WALL PROFILES WALLS 7 - 8
46	CG-204	WALL PROFILES WALLS 9 - 10
47	CG-301	GRADING SECTIONS STREAM 5 BRIDGE TO STA 136+00
48	CG-302	GRADING SECTIONS STA 136+00 TO BC BRIDGE
49	CG-303	GRADING SECTIONS BC BRIDGE TO MUD MTN RD
50	CG-304	GRADING SECTIONS MUD MTN RD TO END
51	CG-401	BOISE CREEK BRD & APPROACHES GRADING BLOW-UP DETAIL
52	CG-402	SE MUD MOUNTAIN RD CROSSING GRADING BLOW-UP DETAIL
53	CG-501	TRAIL DETAILS
54	CG-502	TRAIL DETAILS

CIVIL (CONT)

SHEET	DRAWING	DESCRIPTION
55	CP-101	TRAIL PLAN STA 100+00 TO STA 108+00
56	CP-102	TRAIL PLAN STA 108+00 TO STA 116+00
57	CP-103	TRAIL PLAN STA 116+00 TO STA 124+00
58	CP-104	TRAIL PLAN STA 124+00 TO STA 132+25
59	CP-105	TRAIL PLAN STA 132+25 TO STA 141+00
60	CP-106	TRAIL PLAN STA 141+00 TO STA 144+50
61	CP-107	TRAIL PLAN STA 144+50 TO STA 148+00
62	CP-108	TRAIL PLAN STA 148+00 TO STA 152+00
63	CP-109	TRAIL PLAN STA 152+00 TO STA 155+00
64	CP-110	TRAIL PLAN STA 155+00 TO STA 161+00
65	CP-111	MAINTENANCE ACCESS FROM 252ND AVE SE AND PARKING PLAN
66	CP-112	MAINTENANCE ACCESS FROM SR410 PLAN
67	CP-401	MUD MOUNTAIN ROAD TRAIL CROSSING PLAN AND DETAILS
68	CP-501	TRAIL IMPROVEMENTS DETAILS
69	CP-502	TRAIL IMPROVEMENTS DETAILS
70	CP-503	TRAIL IMPROVEMENTS DETAILS

STRUCTURAL

SHEET	DRAWING	DESCRIPTION
1	S-100	GENERAL STRUCTURAL NOTES
2	S-101	RETAINING WALL PLAN, WALLS 1 - 6
3	S-102	RETAINING WALL PLAN, WALLS 7 - 10
4	S-103	RETAINING WALL DETAILS
5	S-104	RETAINING WALL DETAILS
6	S-105	BOISE CREEK BRIDGE RETAINING WALL #3 DETAILS
7	S-106	TRAIL PEDESTRIAN RAIL AND TRAFFIC BARRIER
8	S-107	BOISE CREEK BRIDGE REPAIR PLAN
9	S-108	BOISE CREEK BRIDGE REPAIR DETAILS (SHEET 1 OF 2)
10	S-109	BOISE CREEK BRIDGE REPAIR DETAILS (SHEET 2 OF 2)
11	S-110	BRIDGE RAILING, TYPE BP (SHEET 1 OF 2)
12	S-111	BRIDGE RAILING, TYPE BP (SHEET 2 OF 2)

MITIGATION

SHEET	DRAWING	DESCRIPTION
1	W-01	SHEET OVERVIEW
2	W-02	EXISTING CONDITIONS (1 OF 6)
3	W-03	EXISTING CONDITIONS (2 OF 6)
4	W-04	EXISTING CONDITIONS (3 OF 6)
5	W-05	EXISTING CONDITIONS (4 OF 6)
6	W-06	EXISTING CONDITIONS (5 OF 6)
7	W-07	EXISTING CONDITIONS (6 OF 6)
8	W-08	IMPACTS ASSESSMENT (1 OF 6)
9	W-09	IMPACTS ASSESSMENT (2 OF 6)
10	W-10	IMPACTS ASSESSMENT (3 OF 6)
11	W-11	IMPACTS ASSESSMENT (4 OF 6)
12	W-12	IMPACTS ASSESSMENT (5 OF 6)
13	W-13	IMPACTS ASSESSMENT (6 OF 6)
14	W-14	MITIGATION PLAN (1 OF 6)
15	W-15	MITIGATION PLAN (2 OF 6)
16	W-16	MITIGATION PLAN (3 OF 6)
17	W-17	MITIGATION PLAN (4 OF 6)
18	W-18	MITIGATION PLAN (5 OF 6)
19	W-19	MITIGATION PLAN (6 OF 6)
20	W-20	PLANTING PLAN (1 OF 6)
21	W-21	PLANTING PLAN (2 OF 6)
22	W-22	PLANTING PLAN (3 OF 6)
23	W-23	PLANTING PLAN (4 OF 6)
24	W-24	PLANTING PLAN (5 OF 6)
25	W-25	PLANTING PLAN (6 OF 6)
26	W-26	PLANTING NOTES AND DETAILS
27	W-27	HABITAT CREATION AND STREAM-BANK STABILIZATION
28	W-28	MITIGATION NOTES AND DETAILS



King County

Department of Natural Resources
and Parks
Parks and Recreation Division
King Street Center, KSC-NR-0700
201 So. Jackson Street, Suite 700
Seattle, Washington 98104
Telephone: (206) 477-4527
Fax: (206) 263-6217

HUIT-ZOLARS
Professional Engineer
818 Stewart St, Suite 1120
Seattle, Washington, 98101-1479
Phone (206) 324-6500 Fax (206) 328-8880

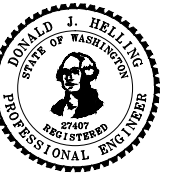

FOOTHILLS TRAIL
TRAIL IMPROVEMENTS - PHASE II
KING COUNTY DEPT. OF NATURAL RESOURCES & PARKS

ISSUE / REVISIONS		
ID	DATE	DESCRIPTION
△	6/6/16	30% SUBMITTAL
△	7/27/16	60% SUBMITTAL

PROJECT NO. 15095303
SITE NO.
FILE
CONTRACT NO. E00115E08 - AM. 8
DRAWN BY LAJ CHECKED BY GS
SHEET TITLE

SHEET INDEX

GI-002

KC DPER GENERAL NOTES (*)

- ALL DESIGN AND CONSTRUCTION SHALL BE IN ACCORDANCE WITH PERMIT CONDITIONS, THE KING COUNTY CODE (KCC), ROAD STANDARDS (KCRS), WASHINGTON STATE DOT (WSDOT) STANDARD SPECIFICATIONS AND THE CONDITIONS OF PRELIMINARY APPROVAL. ~~IT SHALL BE THE SOLE RESPONSIBILITY OF THE APPLICANT AND THE PROFESSIONAL CIVIL ENGINEER TO CORRECT ANY ERROR, OMISSION, OR VARIATION FROM THE ABOVE REQUIREMENTS FOUND IN THESE PLANS. ALL CORRECTIONS SHALL BE AT NO ADDITIONAL COST OR LIABILITY TO KING COUNTY.~~
- THE DESIGN ELEMENTS WITHIN THESE PLANS HAVE BEEN REVIEWED ACCORDING TO THE KING COUNTY DEPARTMENT OF PERMITTING AND ENVIRONMENTAL REVIEW (DPER) ENGINEERING REVIEW CHECKLIST. SOME ELEMENTS MAY HAVE BEEN OVERLOOKED OR MISSED BY THE DPER PLAN REVIEWER. ANY VARIANCE FROM ADOPTED STANDARDS IS NOT ALLOWED UNLESS SPECIFICALLY APPROVED BY KING COUNTY PRIOR TO CONSTRUCTION.
- APPROVAL OF THIS ROAD, GRADING, PARKING AND DRAINAGE PLAN DOES NOT CONSTITUTE AN APPROVAL OF ANY OTHER CONSTRUCTION (E.G. DOMESTIC WATER CONVEYANCE, SEWER CONVEYANCE, GAS, ELECTRICAL, ETC.)
- BEFORE ANY CONSTRUCTION OR DEVELOPMENT ACTIVITY, A PRECONSTRUCTION MEETING MUST BE HELD BETWEEN THE DPER'S LAND USE INSPECTION SECTION, THE APPLICANT, AND THE APPLICANT'S CONSTRUCTION REPRESENTATIVE.
- A COPY OF THESE APPROVED PLANS MUST BE ON THE JOB SITE WHENEVER CONSTRUCTION IS IN PROGRESS.
- GRADING ACTIVITIES (SITE ALTERATION) ARE LIMITED TO THE HOURS OF 7 A.M. TO 7 P.M. MONDAY THROUGH ~~SATURDAY~~ FRIDAY AND 10 A.M. TO 5 P.M. ON ~~SATURDAY~~ AND SUNDAY, UNLESS OTHERWISE APPROVED WITH A WRITTEN DECISION BY THE REVIEWING AGENCY.
- IT SHALL BE THE APPLICANT'S/CONTRACTOR'S RESPONSIBILITY TO OBTAIN ALL CONSTRUCTION EASEMENTS NECESSARY BEFORE INITIATING OFF-SITE WORK. EASEMENTS REQUIRE REVIEW AND APPROVAL PRIOR TO CONSTRUCTION.
- FRANCHISED UTILITIES OR OTHER INSTALLATIONS THAT ARE NOT SHOWN ON THESE APPROVED PLANS SHALL NOT BE CONSTRUCTED UNLESS AN APPROVED SET OF PLANS THAT MEET ALL REQUIREMENTS OF KCRS CHAPTER 8 ARE SUBMITTED TO THE DPER'S LAND USE INSPECTION SECTION THREE DAYS PRIOR TO CONSTRUCTION.
- DATUM SHALL BE KCAS UNLESS OTHERWISE APPROVED BY DPER.
- DEWATERING SYSTEM (UNDERDRAIN) CONSTRUCTION SHALL BE WITHIN A RIGHT-OF-WAY OR APPROPRIATE DRAINAGE EASEMENT, BUT NOT UNDERNEATH THE ROADWAY SECTION. ALL UNDERDRAIN SYSTEMS MUST BE CONSTRUCTED IN ACCORDANCE WITH WSDOT STANDARD SPECIFICATIONS.
- ALL UTILITY TRENCHES AND ROADWAY SUBGRADE SHALL BE BACKFILLED AND COMPACTED TO 95 PERCENT DENSITY, STANDARD PROCTOR UNLESS OTHERWISE NOTED.
- OPEN CUTTING OF EXISTING ROADWAYS FOR NON-FRANCHISED UTILITY OR STORM WORK IS NOT ALLOWED UNLESS SPECIFICALLY APPROVED BY DPER AND NOTED ON THESE APPROVED PLANS. ANY OPEN CUT SHALL BE RESTORED IN ACCORDANCE WITH KCRS.
- THE CONTRACTOR SHALL BE RESPONSIBLE FOR PROVIDING ADEQUATE SAFEGUARDS, SAFETY DEVICES, PROTECTIVE EQUIPMENT, FLAGGERS, AND ANY OTHER NEEDED ACTIONS TO PROTECT THE LIFE, HEALTH, AND SAFETY OF THE PUBLIC, AND TO PROTECT PROPERTY IN CONNECTION WITH THE PERFORMANCE OF WORK COVERED BY THE CONTRACTOR. ANY WORK WITHIN THE TRAVELED RIGHT-OF-WAY THAT MAY INTERRUPT NORMAL TRAFFIC FLOW SHALL REQUIRE AT LEAST ONE FLAGGER FOR EACH LANE OF TRAFFIC AFFECTED. MANUAL ON UNIFORM TRAFFIC CONTROL DEVICES (MUTCD) SHALL APPLY. WORK IN RIGHT-OF-WAY IS NOT AUTHORIZED UNTIL A TRAFFIC CONTROL PLAN IS APPROVED BY KING COUNTY.

(*) NOTE:

NOTES REFERENCE KING COUNTY SURFACE WATER DESIGN MANUAL, DATED APRIL 24, 2016

EDITS TO KING COUNTY STANDARD NOTES BY HUITT-ZOLLARS ARE INDICATED BY UNDERLINING (ADDITIONS) OR STRIKE THROUGH (DELETIONS).

DPER DRAINAGE NOTES (*)

- PROOF OF LIABILITY INSURANCE SHALL BE SUBMITTED TO DPER PRIOR TO THE CONSTRUCTION OF THE DRAINAGE FACILITIES, PREFERABLY AT THE PRECONSTRUCTION MEETING.
- ALL PIPE AND APPURTENANCES SHALL BE LAID ON A PROPERLY PREPARED FOUNDATION IN ACCORDANCE WITH WSDOT SPECIFICATIONS. THIS SHALL INCLUDE LEVELING AND COMPACTING THE TRENCH BOTTOM, THE TOP OF THE FOUNDATION MATERIAL, AND ANY REQUIRED PIPE BEDDING, TO A UNIFORM GRADE SO THAT THE ENTIRE PIPE IS SUPPORTED BY A UNIFORMLY DENSE UNYIELDING BASE.
- STEEL PIPE SHALL BE ALUMINIZED, OR GALVANIZED WITH ASPHALT TREATMENT #1 OR BETTER INSIDE AND OUTSIDE.
- ~~ALL DRAINAGE STRUCTURES, SUCH AS CATCH BASINS AND MANHOLES, NOT LOCATED WITHIN A TRAVELED ROADWAY OR SIDEWALK, SHALL HAVE SOLID-LOCKING LIDS. ALL DRAINAGE STRUCTURES ASSOCIATED WITH A PERMANENT RETENTION/DETENTION FACILITY SHALL HAVE SOLID-LOCKING LIDS.~~
- ~~ALL CATCH-BASIN GRATES SHALL CONFORM TO KCRS, WHICH INCLUDES THE STAMPING "OUTFALL TO STREAM, DUMP NO POLLUTANTS" AND "PROPERTY OF KING COUNTY", EXCEPT THAT PRIVATE DRAINAGE SYSTEMS SHALL NOT HAVE THE WORDS "PROPERTY OF KING COUNTY".~~
- ALL DRIVEWAY CULVERTS LOCATED WITHIN KING COUNTY RIGHT-OF-WAY SHALL BE OF SUFFICIENT LENGTH TO PROVIDE A MINIMUM 3:1 SLOPE FROM THE EDGE OF THE DRIVEWAY TO THE BOTTOM OF THE DITCH. CULVERTS SHALL HAVE BEVELED END SECTIONS TO MATCH THE SIDE SLOPE KCRS.
- ROCK FOR EROSION PROTECTION OF ROADWAY DITCHES, WHERE REQUIRED, MUST BE OF SOUND QUARRY ROCK, PLACED TO A DEPTH OF 1 FOOT, AND MUST MEET THE FOLLOWING SPECIFICATIONS: 4"-8"/40%-70% PASSING; 2"- 4" ROCK/30%-40% PASSING; AND -2" ROCK/10%-20% PASSING. INSTALLATION SHALL BE IN ACCORDANCE WITH KCRS.
- DRAINAGE OUTLETS (STUB-OUTS) SHALL BE PROVIDED FOR EACH INDIVIDUAL LOT, EXCEPT FOR THOSE LOTS APPROVED FOR INFILTRATION BY KING COUNTY. STUB-OUTS SHALL CONFORM TO THE FOLLOWING:
 - EACH OUTLET SHALL BE SUITABLY LOCATED AT THE LOWEST ELEVATION ON THE LOT, SO AS TO SERVICE ALL FUTURE ROOF DOWNSPOUTS AND FOOTING DRAINS, DRIVEWAYS, YARD DRAINS, AND ANY OTHER SURFACE OR SUBSURFACE DRAINS NECESSARY TO RENDER THE LOTS SUITABLE FOR THEIR INTENDED USE. EACH OUTLET SHALL HAVE FREE-FLOWING, POSITIVE DRAINAGE TO AN APPROVED STORMWATER CONVEYANCE SYSTEM OR TO AN APPROVED OUTFALL LOCATION.
 - OUTLETS ON EACH LOT SHALL BE LOCATED WITH A FIVE-FOOT-HIGH, 2" X 4" STAKE MARKED "STORM" OR "DRAIN". THE STUB-OUT SHALL EXTEND ABOVE SURFACE LEVEL, BE VISIBLE, AND BE SECURED TO THE STAKE.
 - PIPE MATERIAL SHALL CONFORM TO UNDERDRAIN SPECIFICATIONS DESCRIBED IN KCRS AND, IF NON-METALLIC, THE PIPE SHALL CONTAIN WIRE OR OTHER ACCEPTABLE DETECTION.
 - DRAINAGE EASEMENTS ARE REQUIRED FOR DRAINAGE SYSTEMS DESIGNED TO CONVEY FLOWS THROUGH INDIVIDUAL LOTS.
 - THE APPLICANT/CONTRACTOR IS RESPONSIBLE FOR COORDINATING THE LOCATIONS OF ALL STUB-OUT CONVEYANCE LINES WITH RESPECT TO THE UTILITIES (E.G. POWER, GAS, TELEPHONE, TELEVISION).
 - ALL INDIVIDUAL STUB-OUTS SHALL BE PRIVATELY OWNED AND MAINTAINED BY THE LOT HOME OWNER.
- ALL DISTURBED PVIOUS AREAS (COMPACTED, GRADED, LANDSCAPED, ETC.) OF THE DEVELOPMENT SITE MUST DEMONSTRATE ONE OF THE FOLLOWING: THE EXISTING DUFF LAYER SHALL BE STAGED AND REDISTRIBUTED TO MAINTAIN THE MOISTURE CAPACITY OF THE SOIL, OR; AMENDED SOIL SHALL BE ADDED TO MAINTAIN THE MOISTURE CAPACITY.
- SEASONAL CLEARING IS ~~LIMITED~~ **NOT ALLOWED** BETWEEN OCTOBER 1 AND MARCH 30 INCLUSIVE, UNLESS OTHERWISE APPROVED WITH A WRITTEN DECISION BY THE REVIEWING AGENCY.
- IMPROVEMENTS AND/OR ~~BUILDINGS~~ **PAVEMENT** SHALL NOT BE INSTALLED UNTIL DRAINAGE FACILITIES ARE "IN OPERATION", (KCC 9.04).

ABBREVIATIONS

AC	ASPHALTIC CONCRETE	PCC	POINT OF COMPOUND CURVE
ALT	ALTERNATE	PED	PEDESTAL/PEDESTRIAN
APPROX	APPROXIMATE	PI	POINT OF INTERSECTION
APWA	AMERICAN PUBLIC WORKS ASSOCIATION	PL	PROPERTY LINE
ASTM	AMERICAN SOCIETY FOR TESTING AND MATERIALS	POC	POINT OF CONNECTION
AVE	AVENUE	PP	POWER POLE OR PUGET POWER
BCV	BEGIN VERTICAL CURVE	PRC	POINT OF REVERSE CURVATURE
BLDG	BUILDING	PSE	PUGET SOUND ENERGY
BM	BENCHMARK	PT	POINT OF TANGENCY
B/P	BOTTOM OF PIPE	PVC	POINT OF VERTICAL CURVE
C	COMMUNICATION	PVI	POINT OF VERTICAL INTERSECTION
CB	CATCH BASIN	PVT	POINT OF VERTICAL TANGENT
CF	CUBIC FEET	R/W, ROW	RIGHT OF WAY
CIP	CAST-IN-PLACE	R	RADIUS OR RIGHT
CIP MON	CAST-IN-PLACE MONUMENT	REF	REFERENCE
CJ	CENTER JOINT	RIM	MANHOLE RIM ELEVATION
C	CENTERLINE	RP	RADIUS POINT
CLR	CLEAR	RT	RIGHT
CONC	CONCRETE	S/W	SIDEWALK
COORD	COORDINATE	S	SOUTH OR SLOPE
CULVT	CULVERT	SD	STORM DRAIN
CY	CUBIC YARD	SF	SQUARE FEET
D/W	DRIVEWAY	SEC	SECTION
DEF	DEFLECTION	SDMH	STORM MANHOLE
DEG	DEGREE	SS	SANITARY SEWER
DI	DUCTILE IRON	SSMH	SANITARY SEWER MANHOLE
DIA/DIAM/Ø	DIAMETER	STA	STATION
DNRP	DEPARTMENT OF NATURAL RESOURCES AND PARKS	STD	STANDARD
DPER	DEPARTMENT OF PERMITTING AND ENVIRONMENTAL REVIEW	TBM	TEMPORARY BENCH MARK
DWG	DRAWING	TEMP	TEMPORARY
E	EAST/EASTING OR ELECTRICAL	TESC	TEMPORARY EROSION AND SEDIMENT CONTROL
EA	EACH	T/P	TOP OF PIPE
EG	EXISTING GRADE	TYP	TYPICAL
ELEV	ELEVATION	VAP	VERTICAL ANGLE POINT
EP/EOP	EDGE OF PAVEMENT	VC	VERTICAL CURVE
EQ	EQUAL	V, VERT	VERTICAL
ESMT	EASEMENT	W	WEST OR WATER
EVC	END VERTICAL CURVE	W/	WITH
EXIST	EXISTING	WL	WETLAND
FG	FINISH GRADE	WLRD	WATER AND LAND RESOURCES
FH	FIRE HYDRANT	WM	DIVISION WATER MAIN OR WILLAMETTE MERIDIAN
FIN	FINISH	WS	WATER SURFACE
FL	FLOW LINE OR FLANGE	WSDOT	WASHINGTON STATE DEPARTMENT OF TRANSPORTATION
FM	FORCE MAIN	WV	WATER VALVE
FT	FOOT/FEET	XING	CROSSING
G	GAS		
GALV	GALVANIZED		
GRND	GROUND		
GV	GATE VALVE		
H, HORZ	HORIZONTAL		
IE	INVERT ELEVATION		
IN	INCH		
JB	JUNCTION BOX		
JT	JOINT TRENCH		
KC	KING COUNTY		
KCRS	KING COUNTY ROAD SERVICES		
KCSWDM	KING COUNTY SURFACE WATER DESIGN MANUAL		
L	LENGTH		
LF	LINEAR FEET		
LP	LOW POINT		
LT	LEFT		
MANUF	MANUFACTURER		
MAX	MAXIMUM		
MED	MEDIUM		
MH	MANHOLE		
MIN	MINIMUM		
MON	MONUMENT IN CASE		
MUTCD	MANUAL ON UNIFORM TRAFFIC CONTROL DEVICES		
MVO	MAIN VALVE OPENING		
N	NORTH/NORTHING		
NO	NUMBER		
NST	NOT STEEPER THAN		
NTS	NOT TO SCALE		
OC	ON CENTER		
OD	OUTSIDE DIAMETER		
P	POWER OR POWER VAULT		
PAVT	PAVEMENT		
PC	POINT OF CURVATURE		

LINETYPE LEGEND (EXISTING)

	730	CONTOUR MAJOR LINE
	729	CONTOUR MINOR LINE
		EDGE OF TREE LINE
		FENCE
	WL	WETLAND
		DITCH CENTERLINE
		PLSS SECTION LINE
		RIGHT OF WAY

SYMBOL LEGEND (EXISTING)

	CONIFER TREE
	DECIDUOUS TREE
	SHRUB
	WETLAND FLAG
	POWER POLE
	STREET SIGN
	WATER METER
	WATER VALVE



King County

Department of Natural Resources and Parks
Parks and Recreation Division
 King Street Center, KSC-NR-0700
 201 So. Jackson Street, Suite 700
 Seattle, Washington 98104
 Telephone: (206) 477-4527
 Fax: (206) 263-6217



FOOTHILLS TRAIL
TRAIL IMPROVEMENTS - PHASE II
 KING COUNTY DEPT. OF NATURAL RESOURCES & PARKS

ISSUE / REVISIONS		
ID	DATE	DESCRIPTION
△	6/6/16	30% SUBMITTAL
△	7/27/16	60% SUBMITTAL

PROJECT NO. 15095303
 SITE NO.
 FILE
 CONTRACT NO. E00115E08 - AM. 8
 DRAWN BY CHECKED BY LAJ
 SHEET TITLE

NOTES
LEGENDS
AND
ABBREVIATION

GI-003



King County

Department of Natural Resources and Parks
Parks and Recreation Division

King Street Center, KSC-NR-0700
201 So. Jackson Street, Suite 700
Seattle, Washington 98104
Telephone: (206) 477-4527
Fax: (206) 263-6217

HUITZOLARS
Professional Engineers
816 Stewart St, Suite 1120 Seattle
Seattle, Washington, 98101-1479
Phone (206) 324-6500 Fax (206) 328-8880

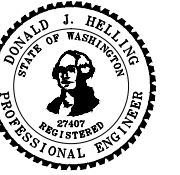

FOOTHILLS TRAIL
TRAIL IMPROVEMENTS - PHASE II
KING COUNTY DEPT. OF NATURAL RESOURCES & PARKS

ISSUE / REVISIONS		
ID	DATE	DESCRIPTION
△ 6/6/16		30% SUBMITTAL
△ 7/27/16		60% SUBMITTAL

PROJECT NO. 15095303
SITE NO.
FILE
CONTRACT NO. E00115E08 - AM. 8
DRAWN BY LAJ CHECKED BY GS

SHEET TITLE
**OVERALL TRAIL
PLAN KEY MAP**

GI-004

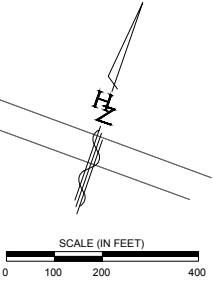
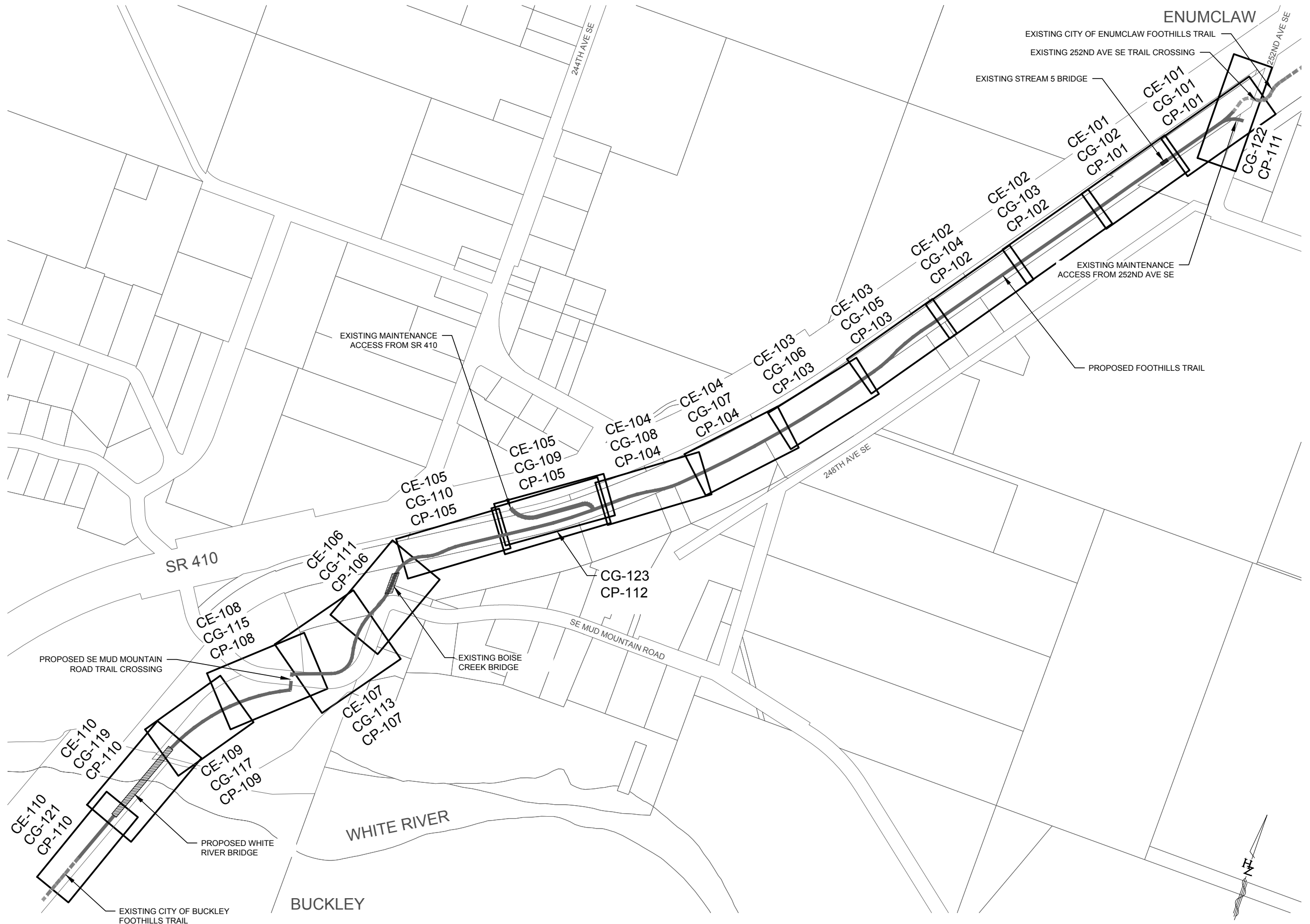

60% SUBMITTAL

J:\15095303 Foothills Trail Amd 716_AMENDMENT 811_DESIGN_CAD\60% sheet files\15095303-GI004.dwg Friday, September 09, 2016 11:28am