

Vashon Town Plan

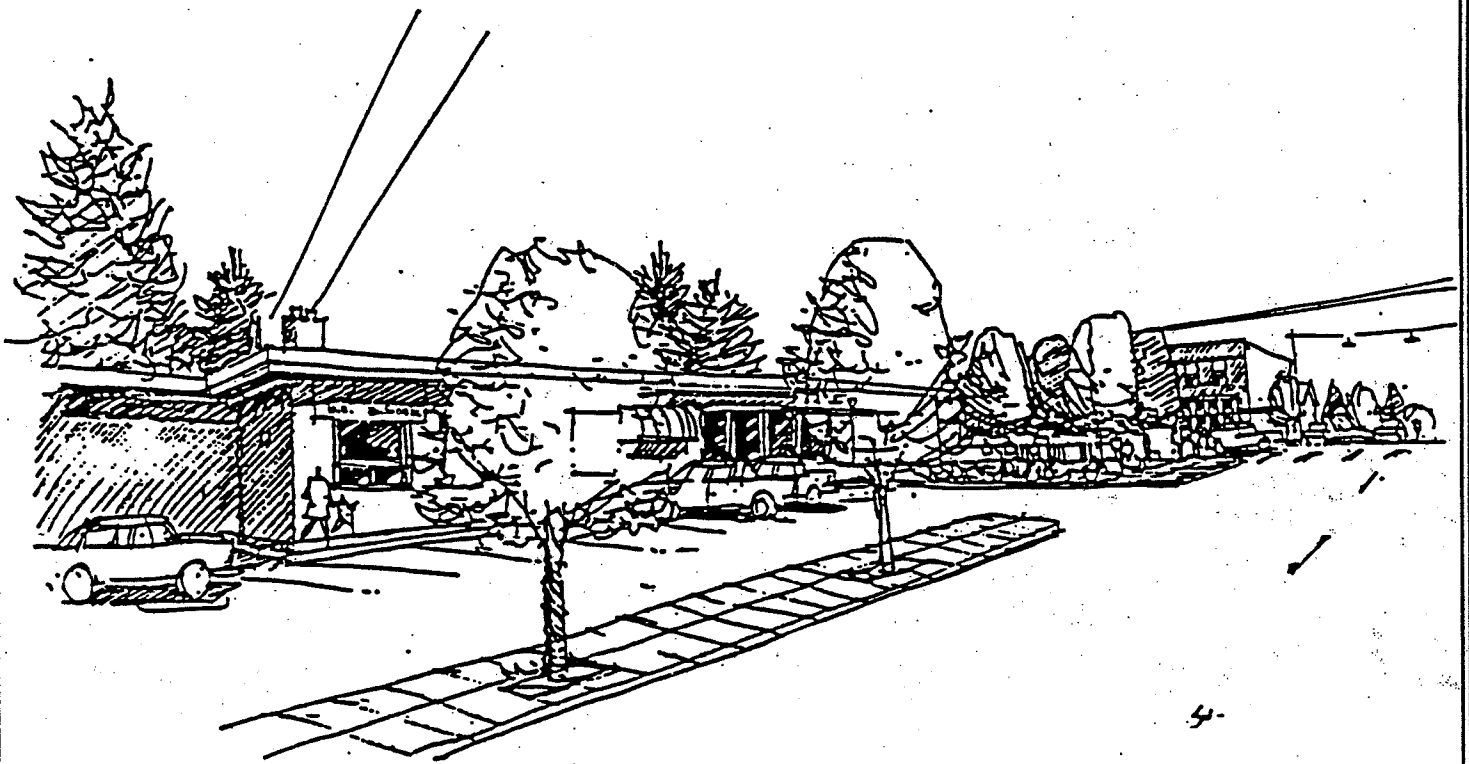

4-



King County
July 1996

Metropolitan King County Council

Maggi Fimia
Cynthia Sullivan
Louise Miller
Larry Phillips
Ron Sims
Rob McKenna
Pete von Reichbauer
Greg Nickels
Kent Pullen
Larry Gossett
Jane Hague
Brian Derdowski
Christopher Vance

The County Council acknowledges the significant work of the Vashon Town Plan Committee of the Vashon-Maury Island Community Council which proposed the 1994 Vashon Town Plan on which the adopted Plan is based. The Town Plan Committee was assisted by the following consultant team: Bredouw, Public Participation & Planning Services; Tonkin/Hoyne, Architects & Planners; Kasprisin/Pettinari Design; Dennis Tate Associates; Economic Consulting Services; and TDA, Inc.

VASHON TOWN PLAN

Table of Contents

	<u>Page</u>
I. Executive Summary	1
II. Development of the Town Plan	2
• Purpose	2
• Management of the Planning Process	2
• Public Process	3
III. Plan Structure	4
• Vashon Community Plan (1986)	5
• Vashon Town Plan Format	5
IV. Policy Recommendations	6
• Land Use	6
• Circulation	8
• Parks and Open Space	9
• Town Green and Green Network	10
• Urban Design	10
• Sidewalks/Pathways	11
• Pedestrian Amenities	11
• Historic Preservation	12
• Residential Development	13
V. Implementation	14
• The VCC "Implementation Group	14
• The Community	15
• Public Agencies	15
• Public Agencies	15
• Public - Private Partnerships	15
• Private Organizations	16
• Schedule for Infrastructure Improvements	16
• Schedule	17

APPENDICES

- A. Vashon Community Plan - Deleted Policies
- B. Existing Conditions
- C. Vashon History
- D. Cultural Resources

FIGURES

- 1. Map: Town Planning Area and Land Use Designations
- 2. Vehicular Circulation
- 3. Pedestrian Circulation
- 4. Map: Parking Reduction Zone
- 5. Parks and Open Space: possible future sites and areas, including Town Green
- 6. Significant Trees
- 7. Landscape and Sidewalk Concepts
- 8. U.S. Bank Corner Concept
- 9. Housing Types:
 - a. Multiplex and Single Family Attached
 - b. Cottages
- 10. Development Schemes:
 - a. Small lot subdivision
 - b. Cluster
 - c. Commons
 - d. Farmstead

May 8, 1996

Introduced By:

GREG NICKEL

vshp:JC:ac

Proposed No.:

96-434

ORDINANCE NO. **12395**

AN ORDINANCE relating to comprehensive planning; adopting the Vashon Town Plan and Area Zoning; amending the King County Comprehensive Plan, amending the Vashon Community Plan; amending Ordinance No. 263, Section 1, as amended and K.C.C. 20.12.010, Ordinance 11653, Section 6 as amended and K.C.C. 20.12.017, Ordinance 7837, as amended and K.C.C. 20.12.320.

BE IT ORDAINED BY THE COUNCIL OF KING COUNTY:

SECTION 1. Findings. For the purpose of effective subarea planning and regulation, the Metropolitan King County Council makes the following legislative findings:

1. The Vashon Town Planning Area is an appropriate subarea planning area as described in King County Comprehensive Plan policies I-215, I-216 and I-209.
2. The Vashon Town Planning Area includes the Rural Town of Vashon and certain immediately surrounding areas.
3. In 1993 and 1994 the county appropriated funds to contract for expert assistance in preparing the Vashon Town Plan. The Plan was guided by the Vashon-Maury Island Community Council through a Town Plan Committee. The proposed Vashon Town Plan was completed in 1994; it contained proposed policies on land use, circulation, parks and open space; a detailed description of the public input; changes to zoning; and a Special District Overlay for the Planning Area.
4. The Plan was transmitted by the executive to the council as part of the 1995 Comprehensive Plan amendment package. The council directed, through a Comprehensive Plan amendment, that the Vashon Town Plan be reviewed and adopted as a subarea plan.
5. After reviewing the proposed Town Plan, the council directed that a revised plan be prepared to comply with the planning structure described in the 1994 King County

1 Comprehensive Plan, as amended; so that the council could adopt the Plan as the initial
2 subarea plan for the Town Planning Area.

3 SECTION 2. Ordinance 263, Section 1, as amended and K.C.C. 20.12.010 are each
4 amended to read as follows:

5 **Comprehensive Plan adopted.** A. Under the provisions of the King County Charter.
6 King County's constitutional authority and pursuant to the Washington State Growth
7 Management Act, RCW 36.70A, the 1994 King County Comprehensive Plan is adopted and
8 declared to be the Comprehensive Plan for King County until amended, repealed or
9 superseded. The Comprehensive Plan shall be the principal planning document for the
10 orderly physical development of the county and shall be used to guide subarea plans.

11 functional plans, provision of public facilities and services, review of proposed
12 incorporations and annexations, development regulations and land development decisions;

13 B. The amendments to the 1994 King County Comprehensive Plan and the 1995
14 area zoning amendments contained in King County Comprehensive Plan 1995
15 Amendments attached as Appendix A to Ordinance 12061 are hereby adopted as
16 amendments to the King County Comprehensive Plan and adopted as the official zoning
17 control for those portions of unincorporated King County defined therein.

18 C. The amendments to the 1994 King County Comprehensive Plan contained in
19 Attachment A to this ordinance are hereby adopted to comply with the Central Puget
20 Sound Growth Management Hearings Board Decision and Order in Vashon-Maury Island,
21 et. al. v. King County, Case No. 95-3-0008.

22 D. The Vashon Town Plan, attached to this Ordinance as Attachment I, is adopted
23 as a subarea plan of the King County Comprehensive Plan and, as such, constitutes official
24 County policy for the geographic area of unincorporated King County defined therein and
25 amending the 1994 King County Comprehensive Plan Land Use Map.

26 SECTION 3. Ordinance 11653, Section 6, as amended and K.C.C. 20.12.017 are each
27 amended to read as follows:

28 **Adoption of area zoning to implement the 1994 King County Comprehensive Plan**
29 **and conversion to K.C.C. Title 21A.** A. Ordinance 11653 adopts area zoning to implement
30 the 1994 King County Comprehensive Plan pursuant to the Washington State Growth

1 Management Act RCW 36.70A. Ordinance 11653 also converts existing zoning in
2 unincorporated King County to the new zoning classifications in the 1993 Zoning Code,
3 codified in Title 21A, pursuant to the area zoning conversion guidelines in K.C.C.
4 21A.01.070. The following are adopted as attachments to Ordinance 11653:

5 Appendix A: 1994 Zoning Atlas, dated November 1994, as amended December 19, 1994.

6 Appendix B: Amendments to Bear Creek Community Plan P-Suffix Conditions.

7 Appendix C: Amendments to Federal Way Community Plan P-Suffix Conditions.

8 Appendix D: Amendments to Northshore Community Plan P-Suffix Conditions.

9 Appendix E: Amendments to Highline Community Plan P-Suffix Conditions.

10 Appendix F: Amendments to Soos Creek Community Plan P-Suffix Conditions.

11 Appendix G: Amendments to Vashon Community Plan P-Suffix Conditions.

12 Appendix H: Amendments to East Sammamish Community Plan P-Suffix Conditions.

13 Appendix I: Amendments to Snoqualmie Valley Community Plan P-Suffix Conditions.

14 Appendix J: Amendments to Newcastle Community Plan P-Suffix Conditions.

15 Appendix K: Amendments to Tahoma/Raven Heights Community Plan P-Suffix Conditions.

16 Appendix L: Amendments to Enumclaw Community Plan P-Suffix Conditions.

17 Appendix M: Amendments to West Hill Community Plan P-Suffix Conditions.

18 Appendix N: Amendments to Resource Lands Community Plan P-Suffix Conditions.

19 Appendix O: 1994 to Parcel List, as amended December 19, 1994.

20 Appendix P: Amendments considered by the Council January 9, 1995.

21 B. Area zoning adopted by Ordinance 11653, including potential zoning is contained
22 in Appendices A and O. Amendments to area-wide P-suffix conditions adopted as part of
23 community plan area zoning are contained in Appendices B through N. Existing P-suffix
24 conditions whether adopted through reclassifications or community plan area zoning are
25 retained by Ordinance 11653 except as amended in Appendices B through N.

26 C. The department is hereby directed to correct the official zoning map in accordance
27 with Appendices A through P of Ordinance 11653.

28 D. The 1995 area zoning amendments attached to Ordinance 12061 in appendix A
29 are adopted as the official zoning control for those portions of unincorporated King County
30 defined therein.

1 E. Amendments to the 1994 King County Comprehensive Plan area zoning,
2 Ordinance 11653 Appendices A through P, as contained in Attachment A to this ordinance
3 are hereby adopted to comply with the Decision and Order of the Central Puget Sound
4 Growth Management Hearings Board in Vashon-Maury Island, et. al. v. King County,
5 Case No. 95-3-0008.

6 E. The Vashon Town Plan Area Zoning, attached to this Ordinance as Attachment
7 2, is adopted as the official zoning control for that portion of unincorporated King County
8 defined therein.

9 SECTION 4. Ordinance 7873, as amended and K.C.C. 20.12.320 are each amended
10 to read as follows:

11 **Vashon community plan. A.** The Vashon community plan update, together with
12 revised local service area boundaries for sewer service, attached to Ordinance 7837 as
13 Appendix A, is adopted as an amplification and augmentation of the comprehensive plan for
14 King County.

15 B. The revised Vashon community plan area zoning, attached to Ordinance 7837 as
16 Appendix B, as amended, is adopted as the official zoning control for that portion of
17 unincorporated King County defined herein.

18 C. Ordinance No. 4035, previously adopting the King County sewerage general plan,
19 is hereby amended in accordance with Subsection A. The Town of Vashon business district
20 development guide, attached to Ordinance 6386, is adopted as an amplification of the Vashon
21 community plan.

22 D. The revised Vashon community plan area zoning, attached to Ordinance 7837 as
23 Appendix B, as amended, is hereby amended by Ordinance 11653 as follows: Existing
24 zoning and potential zoning are replaced by the zoning and potential zoning contained in
25 Appendices A and O of Ordinance 11653. Existing P-suffix conditions are retained except as
26 amended in Appendix G of Ordinance 11653.

27 E. The Vashon community plan update, attached to Ordinance 7837 as Appendix A, is
28 amended by the Vashon Town Plan, attached to this Ordinance as Attachment 1.

1 E. The revised Vashon community plan area zoning, attached to Ordinance 7837 as
2 Appendix B, as amended, and as amended by Ordinance 11653, is hereby amended by the
3 Vashon Town Plan Area Zoning, attached to this Ordinance as Attachment 2.

4 INTRODUCED AND READ for the first time this 13th day of

5 May, 1996

6 PASSED by a vote of 12 to 1 this 22nd day of July, 1996.

7 KING COUNTY COUNCIL
8 KING COUNTY, WASHINGTON

9
10 Jane Hague
Chair

11 ATTEST:

12 Gerald A. Peterson
13 Clerk of the Council

14 APPROVED this 2nd day of August, 1996

15 Sam Locke
16 King County Executive

17 Attachments: Attachment 1: Vashon Town Plan
18 Attachment 2: Vashon Town Plan Area Zoning

II. DEVELOPMENT OF THE TOWN PLAN

PURPOSE

Vashon, as it appears today, was never "planned". It evolved due to a combination of geographic, economic and transportation factors. Roads developed along the beach or on section lines between properties. Stores developed along these roads that connected beach landings to inland areas more conveniently accessible to farms or logging operations. The intersection at Vashon Highway and Bank Road is the focal point of Vashon Island. The oldest and most successful business establishments were founded at that intersection and many of today's most successful businesses are located here, the Thriftway shopping center being the primary example. Past fires have wiped out most of the old historic downtown, with the notable exception of Vashon Hardware, which has been in business since 1904.

This evolution has resulted in a typical Pacific Northwest small town, with a mixture of architecture from several eras and haphazard development based on quirks of history and residents' individuality. Vashon Islanders cherish this character and the Town Plan reflects their efforts to maintain it. This preservation consensus does not preclude agreement that the town lacks some important amenities: a permanent home for the outdoor Saturday Market, affordable housing, a performing arts center. All are desired by the community.

Growth pressures in Vashon have illustrated the limitations of the regulatory tools in the Community Plan in achieving its stated goals of maintaining rural character, as opposed to a suburban appearance. Recent development proposals have forced a re-examination of allowable height, scale and parking.

The objective of the plan is to direct gradual growth and infill development so that it best meets the needs of the community and does not over tax infrastructure. The intent is to seek ways to reinforce Vashon's traditional small town values, character and structure. It is also intended that the Plan provide some predictability to Vashon landowners as to future development potential, and give Island residents a description of likely changes which, based on utility availability and market forces, are expected to be gradual. Most important, it provides a blueprint for changes.

MANAGEMENT OF THE PLANNING PROCESS

The 1994 Vashon Town Plan was funded by King County and written by a consulting team under the direction of the Town Plan Committee, a group of volunteer Islanders appointed by the Vashon-Maury Island Community Council.

The Town Plan was designed to develop a land use, design, and implementation plan for the commercial center of Vashon Island, an unincorporated part of King County. The island's population has exceeded County forecasts, and with the passage of the statewide Growth Management Act, the Community Council sought to revisit the island's goals and regulations for its main commercial center.

The Community Council appointed a Town Plan Committee in 1992 to update the Town's 1983 "Business District Development Guide". While this Guide was officially adopted by the County Council, its recommendations had not been implemented. When the 1986 Vashon Community Plan was adopted, much of the island's allowable development density was reduced (due to Islanders' wishes, and water and sewage restrictions), but the zoning in the Town of Vashon was not adjusted to reflect the newly adopted policies.

PUBLIC PROCESS

While the Town Plan Committee (TPC) was charged with hiring the consultant and managing the funds and process, the entire effort was community-directed. The approach used was to involve as many Islanders as possible. Announcements of TPC meetings appeared in *The Beachcomber*, the local weekly newspaper, and were open to the public. Newspaper articles, fliers, and other printed material described the study's progress and its findings.

Among the problems mentioned by the public were lack of local (Island) control, lack of an entity to ensure maintenance of amenities (e.g., public restroom, mini-parks, flower boxes/baskets, clean-up), housing costs vs. lower-income Islanders' needs, lack of commercially-zoned land for sale, parking, and an uncertain availability of drinking water. The opportunities identified by Islanders included local enthusiasm and expertise, a town that has not experienced rapid development, and the natural limitation on growth imposed by an uncertain availability of drinking water.

TPC members worked closely with property owners, and held numerous public meetings to bring owners' goals into the planning process. Every owner's proposal was considered and voted on by the TPC.

Overall, the basic values the community wanted to see reflected in the Plan include:

- A friendly and safe place (where we know each other and frequently talk to people we don't yet know);
- A "small town character" (rural, not suburban);
- A Town to serve Islanders' needs: provide affordable housing; keep the Saturday Market alive and well; don't make Vashon too "cute", and, thus, cater to tourists or upscale folks;
- A Town where pedestrians are more important than cars.

Most people just want Vashon to stay as it is, and not recognize the growth potential under existing regulations.

III. PLAN STRUCTURE

KING COUNTY COMPREHENSIVE PLAN

The King County Comprehensive Plan (KCCP) directed the drafting of the Vashon Town Plan through (1) setting forth the structure and required content for a subarea plan, and (2) setting the general policy framework for what a Rural Town should be.

Subarea Plans. The Vashon Town Plan is a subarea plan as described in RCW 36.70A.130 and the KCCP policy I-209¹. The policy reads as follows:

- I-209 Subarea plans should provide detailed land use plans for local geographic areas. Subarea plans implement and shall be elements of the King County Comprehensive Plan and shall be consistent with the County's Comprehensive Plan's policies, development regulation and Land Use Map. The subarea plans should be consistent with functional plans' facility and service standards. The subarea plans may include, but are not limited to:
- a. Identify policies in the Comprehensive Plan that apply to the subarea;
 - b. Plan specific land uses and apply implementing zoning, consistent with the Comprehensive Plan;
 - c. Identify the boundaries of Unincorporated Activity Centers and Rural Towns;
 - d. Recommend establishment of new Unincorporated Activity Centers if appropriate;
 - e. Recommend additional Open Space designations and park sites;
 - f. Recommend capital improvements, the means and schedule for providing them and amendments to functional plans to support planned land uses;
 - g. Identify new issues that need resolution at a countywide level, and
 - h. Identify all necessary implementing measures needed to carry out the plan.

Rural Town Policies. The following KCCP policies relating to Rural Towns specifically apply. The VTP complies with these policies.

- R-302 King County hereby designates Fall City and the Town of Vashon as unincorporated Rural Towns. Boundaries of the designated Rural Towns are shown on the Comprehensive Plan Land Use Map. Subarea plans may review and recommend minor adjustments to these boundaries, but such adjustments shall not allow significant increases in development potential for a town, and shall not allow increased development intensities closer to environmentally sensitive areas than existing boundaries would.
- R-303 Commercial and industrial development in the Rural Area may locate in Rural Towns if utilities and other services permit, to provide employment, shopping, services and housing opportunities that will reinforce the fiscal and economic health of these communities.
- R-304 Rural Towns may contain higher density housing than permitted in the surrounding Rural Area if utilities and other services permit. Development density in Rural Towns may approach that achieved in Rural Cities.

¹ This Plan is also governed by KCCP policies I-215 and I-216. It complies with the direction given in both the policies

- R-305 Rural Towns serve as activity centers for the Rural Area and may include several or all of the following land uses, if supported by necessary utilities and other services and if scaled and designed to protect rural character:
- a. Retail, commercial and industrial uses to serve the surrounding Rural Area population and to provide support for resource industries and tourism;
 - b. Residential development, including single family housing on small lots as well as multifamily housing and mixed-use developments;
 - c. Other commercial and industrial uses, including commercial recreation and light industry; and
 - d. Public facilities and services such as community services, churches, schools and fire stations.
- R-306 Rural Towns should be compact, promoting pedestrian travel as well as automobile access to most commercial and industrial uses, although these uses are often mixed throughout the towns. New development should be designed to strengthen the desirable characteristics and the historic character of the town, be supported by necessary public facilities and services, and be compatible with historic resources and nearby rural or resource uses. New industrial uses should locate where they do not disrupt pedestrian traffic in established retail areas of town or conflict with residential uses.

Definitions of operative policy language. The shall, will, should, and may are used in this Plan as defined in the KCCP, Chapter One, Section V.A. as follows:

“Shall” and “will” in a policy mean that it is mandatory for the County to carry out the policy, even if a timeframe is not included. “Shall” and “will” are imperative and nondiscretionary--the County must make decisions based on what the policy says to do. “Should” in a policy provides non-complutory guidance, and establishes that the County has some discretion in making decisions. “May” in a policy means that it is in the County’s interest to carry out the policy, but the County has total discretion in making decisions.

VASHON COMMUNITY PLAN (1986)

The Vashon Community Plan, as stated in King County Code 20.12.320, is an amplification and augmentation of the KCCP for policy and area zoning for Vashon Island. This VTP amends the Community Plan by deleting policies that specifically dealt with the Rural Town, and changing land use and amending zoning for the Town Planning Area. Appendix A lists the policies deleted from the Vashon Community Plan.

VASHON TOWN PLAN FORMAT

A Vashon Town Plan prepared in 1994, by contract, under guidance of the TPC provided the vision and objectives for this Town Plan. To meet the requirements of the Growth Management Act and the King County Comprehensive Plan, the Plan was restructured. Generally, the explanatory text from the 1994 Plan is included to furnish context for policies. The policies (printed in bold) are extracted and edited from both the 1994 Plan and

the corresponding proposed Special District Overlay. The implementation section is generally that from the 1994 Plan. Two appendices from 1994 are also included: Existing Conditions and Vashon History.

IV. POLICY RECOMMENDATIONS

The development of the Vashon Town Plan was guided by principles adapted from the Vashon Community Plan:

- Maintain the rural character of the town and Island
- Encourage a compact town center in Vashon
- Encourage pedestrian activity in Vashon
- Encourage open and green space
- Encourage economic diversity
- Protect environmentally sensitive and natural areas
- Encourage affordable housing
- Expand small business opportunities in the planning area
- Emphasize residential and commercial infill
- Encourage mixed-use development in commercial areas
- Allow industrial employment to grow with the population
- Avoid strip development or spot zoning
- Protect existing land uses, not necessarily existing zoning
- Encourage development of vacant lots for businesses and residences
- Protect public safety
- Protect groundwater quality
- Develop recommendations that will result in the planning area relating appropriately to the rest of the island

For purposes of the Plan, Vashon Island is referred to as such, and the area surrounding the intersection of Vashon Highway and Bank Road is referred to by its historic name, Vashon. Center is an area around the intersection of Cemetery Road and Vashon Highway. The Rural Town is the entire area with designated Rural Town land use, i.e., it encompasses Vashon and Center, and surrounding residential areas and industrial areas (see Figure 1).

LAND USE

The land use policies are intended to strengthen existing land use patterns, while achieving the goals of compact development, employment opportunities, and affordable housing.

- L-1 Development in the Rural Town should maintain the rural nature and service orientation of the commercial areas of Vashon and Center, with compact, pedestrian-friendly commercial development mixed with moderate density residential development.**
- L-2 The Rural Town should support diverse commercial activities, employment opportunities, cultural and educational facilities, parks and open space, and varied housing types arranged in neighborhoods.**

In order to create contiguous rural town land use, the boundaries of the Rural Town of Vashon are revised as allowed in KCCP policy R-302. The revision does not increase development potential nor does it change the impact to sensitive areas since, primarily, the boundary revision moves the existing industrial land use into Rural Town land use.

L-3 The boundaries of the Rural Town land use (Rural Town of Vashon) shall be as described in Figure 1, amending the 1994 King County Comprehensive Plan Land Use Map.

The following policies replace policies V-10 through V-14 from the Vashon Community Plan. The VTP policies express the vision that Vashon's residential development would be intensive in relation to other residential areas on the Island but it would not exceed the development that can be accommodated by existing or planned services.

L-4 In order to fully utilize existing services including sewers, Class I water, public transportation and shopping, Vashon is planned to accommodate the most intensive residential development on the Island, as mixed use and infill.

L-5 Vashon should continue to be the major commercial business center on Vashon Island.

L-6 The area between Vashon and Center should be designated R-1 in order to separate the two commercial nodes and to allow for the development of moderately-priced housing along the Vashon Highway.

L-7 Multifamily rezones for housing projects for senior or disabled citizens, or for low-income citizens, for up to twelve dwelling units per acre, should be allowed in areas zoned R-8 provided they meet other applicable Town Plan, Community Plan and Comprehensive Plan policies.

Policy L-8 broadens the locations of mixed business and residential to the full Rural Town.

L-8 Mixed business and residential uses are encouraged in the Rural Town.

Policy L-9 replaces V-16 in the VCP. It indicates, along with L-10 and L-11, that "light" industrial uses are appropriate and that commercial services should be in the Town.

L-9 Commercial and light industrial land uses should be concentrated in the Rural Town where water, wastewater and transit services are available and adequate.

L-10 Future light industrial development on Vashon Island should only occur on property in the Rural Town, and with industrial or potential industrial zoning. Industrial development, therefore, should be clustered south and west of Vashon and near existing manufacturing uses.

L-11 Light industrial development should have adequate access to Vashon Highway, but is not to occur along the Highway.

L-12 Storage of heavy equipment may occur within industrially zoned land, but not along arterials.

CIRCULATION

Vehicular Circulation

The intent of the circulation recommendations are (1) to facilitate smooth and safe travel throughout the Town, and (2) to encourage traditional residential patterns and increased pedestrian traffic through use of a grid system of streets. Figure 2 shows conceptual road linkages; field surveys have not been prepared to determine actual feasibility. Actual alignments would be determined at the time of development proposals. A major consideration is keeping residential traffic separate from industrial traffic.

Two changes of circulation are not included in the VTP: traffic signals are not recommended to replace the four-way stops; a bypass of the main intersection in Vashon is not recommended. Also, the alleys in the planning area provide access to parking areas and for service vehicles. The Town Plan does not recommend any change to those functions at this time.

Public transit use has been addressed by land uses which are higher density residential and mixed use in Vashon. In addition, the urban design recommendations are intended to enhance the pedestrian environment and increase transit use. Also, the Ober Park park-and-ride facility is over-crowded and subject to vandalism and theft, many commuters park along Vashon Highway and in privately-owned parking lots before boarding Metro buses. A second park-and-ride facility is suggested.

- C-1 The Town Planning Area vehicle circulation system should be a street grid structure that provides for efficient movement of people, goods, and services, and safe ingress/egress from businesses and residences.**
- C-2 King County should review and consider how to help implement traffic studies which may be prepared by other agencies such as the Vashon Chamber of Commerce and the Vashon Community Council.**
- C-3 A second park-and ride facility at the southern end of Vashon should be considered, possibly along with a large parcel development.**

Non-Motorized Circulation

Pedestrian priority over motorized vehicles was a strong theme in the Town Plan from its inception.

Sidewalks and special pavings have been recommended to provide a safe and pleasant place for pedestrians to walk, including seniors, disabled, and children in strollers. Figure 3 shows the high priority (and secondary priority) locations for sidewalks, pathways, walkways or trails in the Town Planning Area. Primary activity areas include the Post Office, Beck's Market, Vashon Landing, Thriftway Market, and the Library (and the County Market site on Saturdays). Dashed lines in the northwest portion of Vashon indicate the vision of a walking trail/easement along the stream north of Bank Road, connecting with SW 174th Street and a potential community center site across from Ober Park. A pathway would extend north from 100th Ave SW. For the southwest quadrant of Vashon, the concept of connecting 98th Way SW southward, then back to Vashon Highway, would be realized when a development proposal is implemented on those parcels.

SW COVE ROAD

SW BANK ROAD

SW 188th STREET

SW CEMETERY ROAD

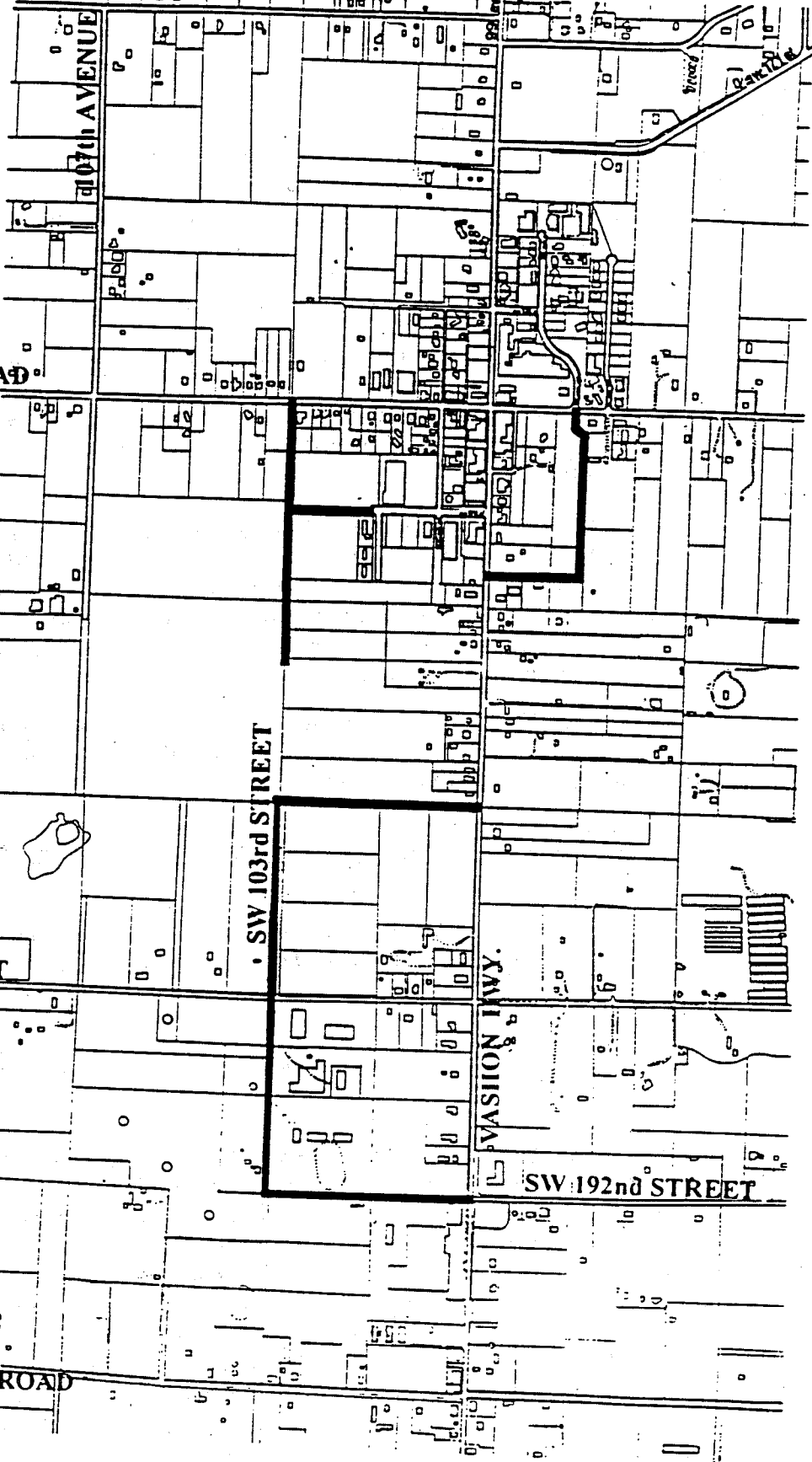

Vashon Town Plan



PROPOSED ROAD

VEHICULAR
CIRCULATION
FIGURE 2

SW COVE ROAD

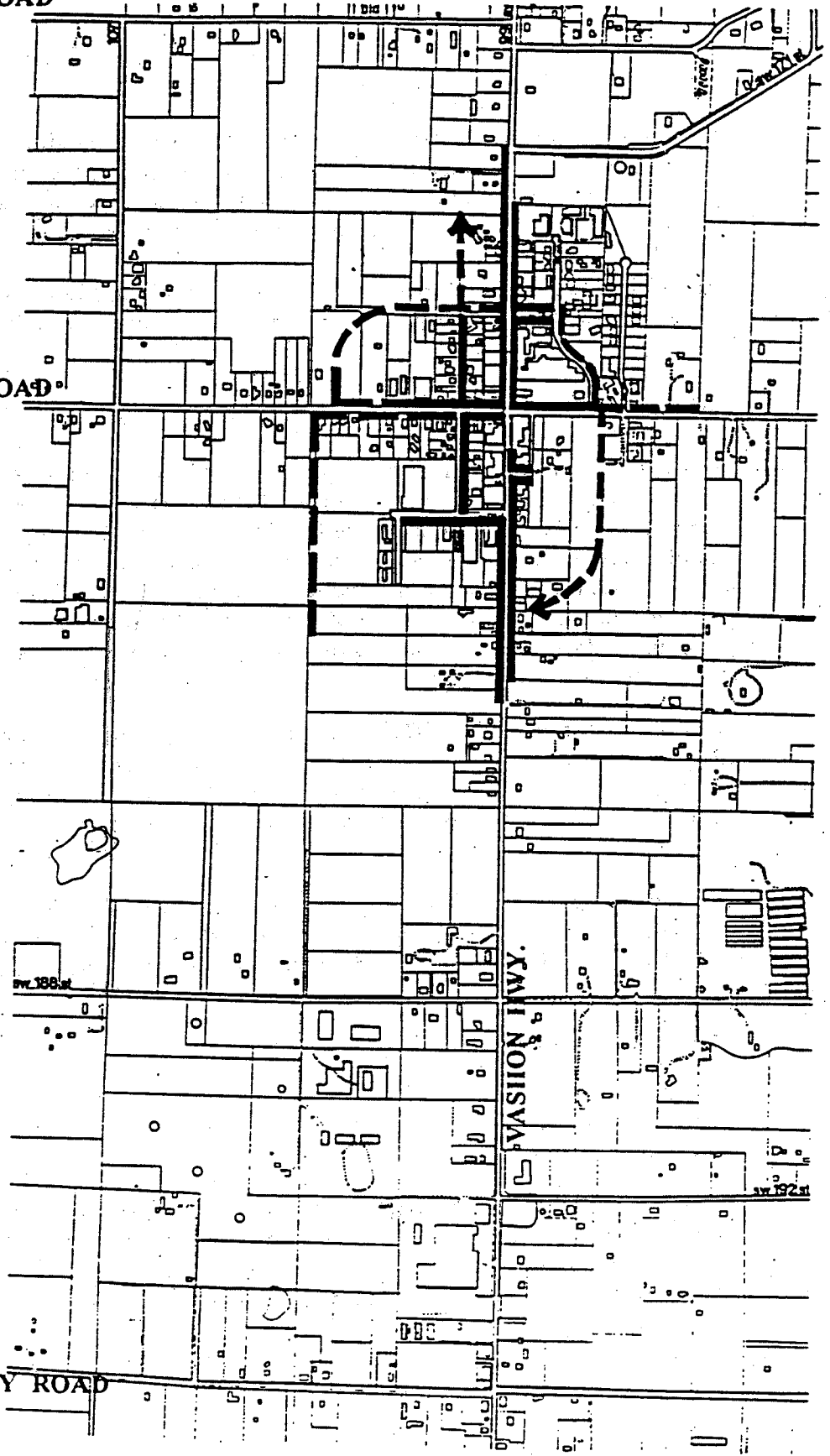

SW BANK ROAD

SW CEMETERY ROAD



Vashon Town Plan



-  FIRST PRIORITY
-  SECOND PRIORITY

PEDESTRIAN CIRCULATION
FIGURE 3

No specific recommendations have been made for bicycles or equestrians in this Town Plan policies over provisions already in effect through King County regulations.

- C-4 Safe pedestrian travel should be provided for by installing sidewalks, trails, paths or other separated walkways in locations shown on Figure 3. Pedestrian facilities should be placed where people walk and congregate naturally, with thought to how the land will continue to develop over the long term.**
- C-5 Pedestrian facilities should be provided for along 103rd Avenue SW, south of Bank Road, to allow employees in the industrial areas to the south to walk to Vashon.**

Parking

Off-street parking requirements are proposed to be waived for parcels in the Parking Reduction Zone (Figure 4) to encourage infill and existing businesses to redevelop, and to eliminate the need to demolish older buildings when remodeling or expanding. Although Islanders and visitors experience a parking problem at certain, popular locations on peak activity days, there is plenty of parking throughout Vashon. The addition of new off-street parking is not required and, in this Zone, would not be consistent with Vashon's rural character or desired pedestrian orientation. In aggregate, an adequate amount of parking exists within a five minute walk from the main intersection.

The County Zoning 21A.18.020D (authority and application section of the Zoning Code Chapter on Development Standards for Parking and Circulation) allows, under certain conditions, the director (of the Department of Development and Environmental Services) to waive parking requirements. Policy C-6 will be the policy basis for the director to honor requests for waivers.

- C-6 The director shall honor requests to waive County Code parking requirements for commercially zoned properties in the Parking Reduction Zone (Figure 4), except that any waiver shall not reduce the number of existing parking spaces.**

PARKS AND OPEN SPACE

A combination of public parks and open space and informal green spaces can result from public/private partnerships at the time of development of key sites. King County should help facilitate such partnerships.

The Vashon-Maury Island Park District has taxing authority which it uses to supplement King County Parks facilities and programs on the Island. The Park District now owns many of the park properties which it manages and maintains so as to customize service to Island residents. A combination of public park/open spaces and those incorporated in private developments as these occur is recommended in this Town Plan. Figure 5 illustrates possible sites and areas for future development by either public or private funds.

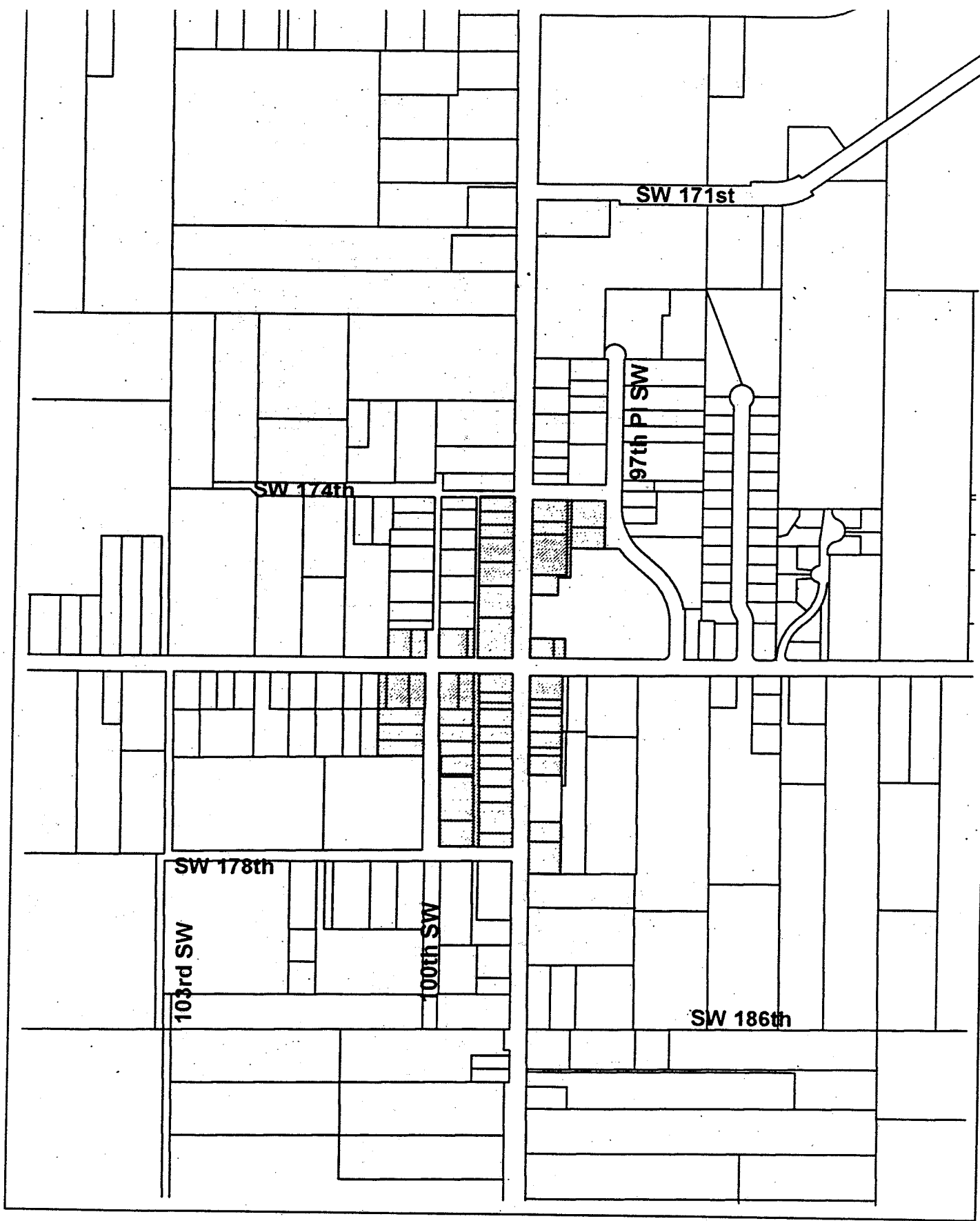

Vashon Town Plan
 Figure 4. Parking Reduction Zone

 Parcels in Parking Reduction Zone

