



**King County**

Department of Natural Resources and Parks  
Wastewater Treatment Division

## **Sewer Pipeline Work in Pacific, Algona & Auburn**

Phase B of the Kent-Auburn Conveyance System Improvements Project

April 2016

## **Kent-Auburn Conveyance System Improvements Project Phase B in Pacific, Algona and Auburn**

### **Why is King County constructing this project?**

To protect public health and the environment, King County's Wastewater Treatment Division (WTD) is building improvements that will accommodate growth in the area and allow us to continue to provide safe, reliable sewer service.

The new pipelines will provide additional capacity which will help reduce the risk of sewer overflows. The new pipelines will provide enough capacity to carry wastewater from the cities of Auburn, Pacific, and Algona through 2060.

### **What to expect during construction**

- To build the new sewer pipe, the contractor will need to work in the street (right-of-way) in some areas
- Other typical construction impacts include:
  - Noise, dust and vibrations
  - Occasional night and weekend work
  - Increased truck traffic and staging of heavy machinery and equipment
  - Loss of street parking and road closures
  - Vehicle and pedestrian detours



### **Project work along West Main Street in Auburn begins this spring!**

Construction on a small section of the project begins this spring along West Main St. in Auburn. Crews will be building a 300-foot long portion of the new sewer line. The goal is to complete this work in advance of a future City of Auburn paving project on West Main St. This work is anticipated to last through the summer.

The larger part of the project – which includes building a new sewer line through Auburn, Algona and Pacific is expected to begin early in 2017.



# Kent-Auburn Conveyance System Improvements Project Phase B in Pacific, Algona and Auburn

**City of Auburn:** a small part of the project along West Main Street started this spring—see more details on the first page. The remainder of the work will include open cut pipeline construction across commercial and industrial properties; going under State Route 18, crossing 15th Street Southwest, and next to Perimeter Rd.

**City of Algona:** work in Algona will include open cut construction primarily in residential areas—along 1st Ave. North, Seattle Blvd. South and the Interurban Trail. Most of the work will be in the street; some work will be adjacent to or on properties—the owners of these properties have been told about this work.

**City of Pacific:** work in Pacific will include open cut pipeline construction along Frontage Road and minor improvements and a stream crossing at the Pacific Pump Station on Frontage Road.

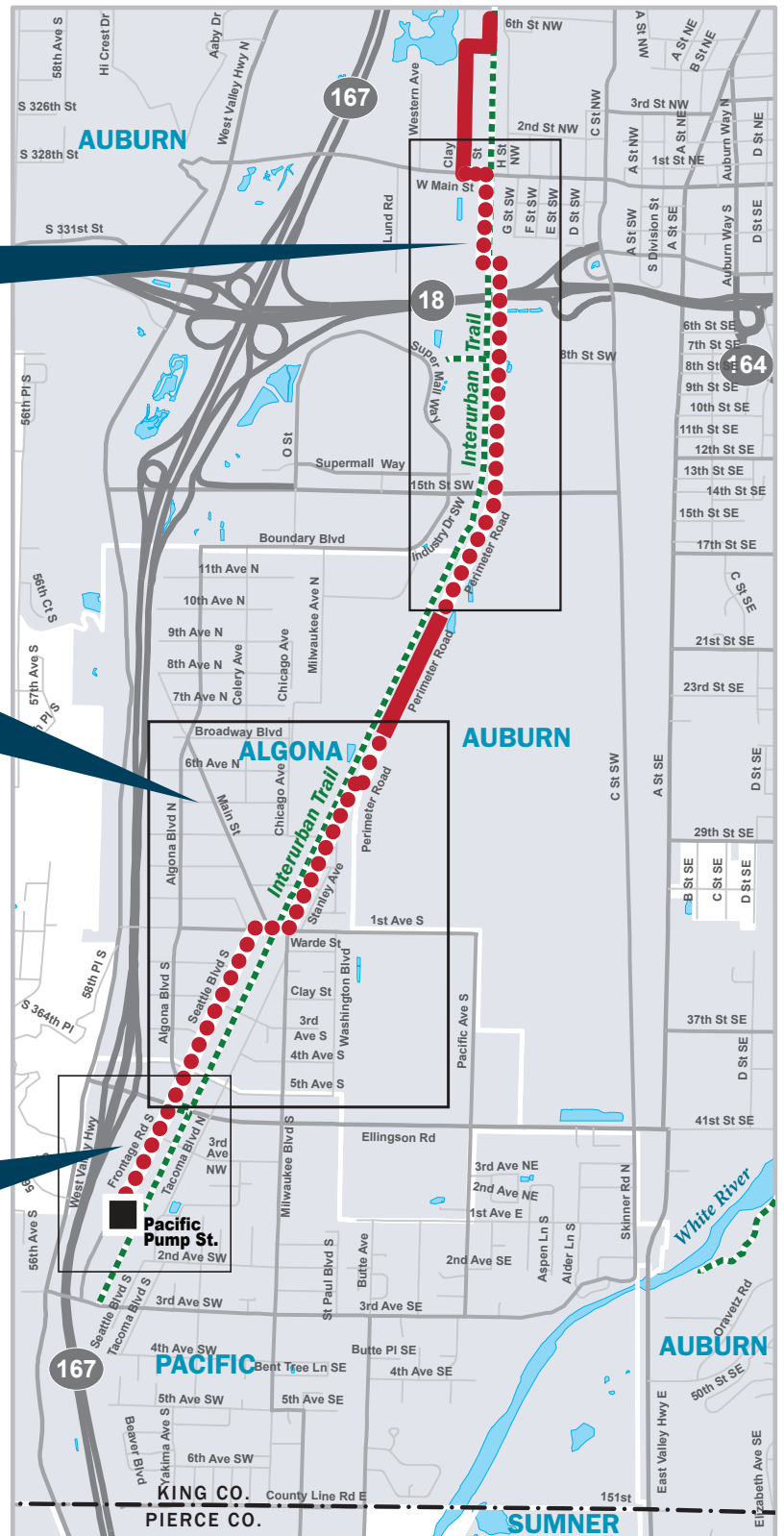

## 2017-18 Project Area

- ● ● ● New Sewerline
- Existing Sewerline



0 1,000 2,000 3,000  
Feet

# BEING A GOOD NEIGHBOR

**We are committed to working with the community to minimize construction impacts whenever possible. Residents can expect:**

- Advance notice of construction activities by mail, email, phone
- One-on-one problem solving with residents
- A project website to provide information and construction updates
- A project information phone line available during construction

## Engaging the public

Well before construction starts, we want to engage property and business owners, residents and tenants who could be impacted by the work. Outreach will include, notices, surveys, newsletters, and regular web and email updates.

## Staying informed

[www.kingcounty.gov/kent-auburn-csi](http://www.kingcounty.gov/kent-auburn-csi) - Visit the project web site to learn more and to sign up for updates.

Call or email David Freed at **206-263-9453** or [david.freed@kingcounty.gov](mailto:david.freed@kingcounty.gov)

**El condado King** está construyendo nuevas tuberías para aguas residuales en las ciudades Pacific, Algona y Auburn. La construcción se inició esta primavera en una pequeña parte del proyecto, a lo largo de West Main Street en Auburn. Se espera que la construcción del resto del proyecto inicie a principios de 2017 y que tarde alrededor de dos años. Comuníquese con nosotros si tiene alguna pregunta o necesita servicios de interpretación adicionales. Llame a **David Freed** al **206-263-9453** o envíele un correo electrónico a [david.freed@kingcounty.gov](mailto:david.freed@kingcounty.gov)



## King County

Department of Natural Resources and Parks  
**Wastewater Treatment Division**

201 S. Jackson St., KSC-NR-0505  
Seattle, WA 98104-3855

***Learn about new sewer  
improvements in your  
area that will help  
keep our water clean!***

## **Kent-Auburn Conveyance System Improvements Project Phase B in Pacific, Algona and Auburn**

The project involves new wastewater pipelines in Pacific, Algona, and Auburn. Construction started on a small part of the project this spring. Construction for the remainder of the project is expected to begin in early 2017 and last about two years.

### **Project timeline**

- **Spring – Summer 2016:** Auburn West Main Street pipeline work
- **Early 2017:** Remaining Phase B construction begins in Pacific, Algona and Auburn
- **Early 2019:** Construction ends

Alternative Formats Available

206-477-5371 TTY Relay: 711

Printed on recycled paper. Please recycle.

1604\_6598\_Kent-AuburnNewsletter.indd skrau

