



New Hidden Lake Pump Station

New pump station will replace aging facility, ensure safe and reliable operations

The King County Wastewater Treatment Division protects public health and the environment by conveying and treating our region's wastewater. King County has determined it must replace the Hidden Lake Pump Station, located on the corner of 10th Avenue Northwest and Northwest Innis Arden Way in Shoreline. The existing pump station is nearly 40 years old, has operating problems and lacks capacity, causing about three overflows per year into Puget Sound. The station does not meet current county pump station design standards, including odor and noise control standards.

The new Hidden Lake Pump Station will be built on King County's property next to the existing pump station. The pumping capacity will be increased from 4.3 to 6.8 million gallons per day (mgd). The new pump station will meet the county's current design standards, including noise and odor control, and will have greater capacity to meet local needs.

What can you expect during construction?

Construction of the pump station will take about two and one-half years. The existing pump station will operate during construction. There will be noise and activity during weekdays

Construction work will include:

- Removal of mature trees that screen the existing station to provide room to work
- Constructing the pump station foundation using cast-in-place concrete
- Excavating the pump station foundation
- Constructing the pump station building
- Installing new equipment inside the building
- Connecting the new pump station to the sewer, which will involve night work when wastewater flows are lowest
- Demolition of the existing pump station
- Restoring and landscaping the site

What will be done to minimize impacts?

King County will work hard to ease the impacts of construction on the community.

- The permitted construction hours are between 7 a.m. and 10 p.m. weekdays. We do not expect the contractor to work this long on most days.
- Limited work may be required at night, when wastewater flows are lowest. Advance notice of late night work will be provided.
- The pump station site will be fenced.
- Access to residences will be maintained at all times.
- Traffic will be directed and controlled to ensure safe travel around the construction area.
- Work will be done as safely and quickly as possible
- County staff will be available 24 hours a day to respond to question and concerns.

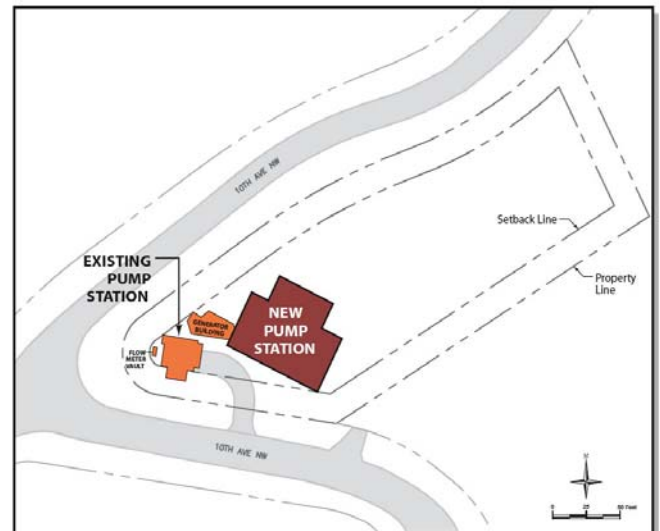

- The contractor will restore the site and roadway after work is complete.

What has the county heard from the community so far?

Public comment has influenced the design of the pump station and site landscaping. For example, the roof pitch was increased and a tile roof selected to fit with the residential setting. Native, drought-tolerant, low-maintenance plantings were selected. The county also heard that noise and odor control improvements were needed, and these are included in the new facility. The county was unable to save the mature trees that screen the existing pump station, because sewer pipes run under the trees and the site is very small.

More information?

- Call **Jennifer Kauffman** at **206-263-6029**.
- Request updates through e-mail by sending a message to jennifer.kauffman@metrokc.gov.
- Ask to be added to the Hidden Lake mailing list.
- Visit our Web site: <http://dnr.metrokc.gov/wtd/projects/hiddenlake.htm>.



New Hidden Lake Pump Station (South elevation (front) and east elevation (side))