



King County

Department of Natural Resources and Parks
Wastewater Treatment Division

Sewer Pipeline Work in Pacific, Algona & Auburn

Phase B of the Kent-Auburn Conveyance System Improvements Project

Pre-construction activities in your area - April-May 2017

Beginning the week of April 17, in preparation for the start of sewer pipeline construction, King County's contractor will be doing a variety of pre-construction activities, including:

- Surveying
- 'Potholing' to locate utilities
- Soil sampling
- Installing monitoring equipment
- Setting up erosion control measures

What to expect during work

- Equipment and noise close to the work areas
- There may be temporary traffic detours
- Work will occur weekdays between 7 a.m. and 7 p.m.
- When the crews are done, sites will be restored

For more information

Visit www.kingcounty.gov/kent-auburn-csi

Call the project hotline at 206-205-9283

Contact David Freed at david.freed@kingcounty.gov

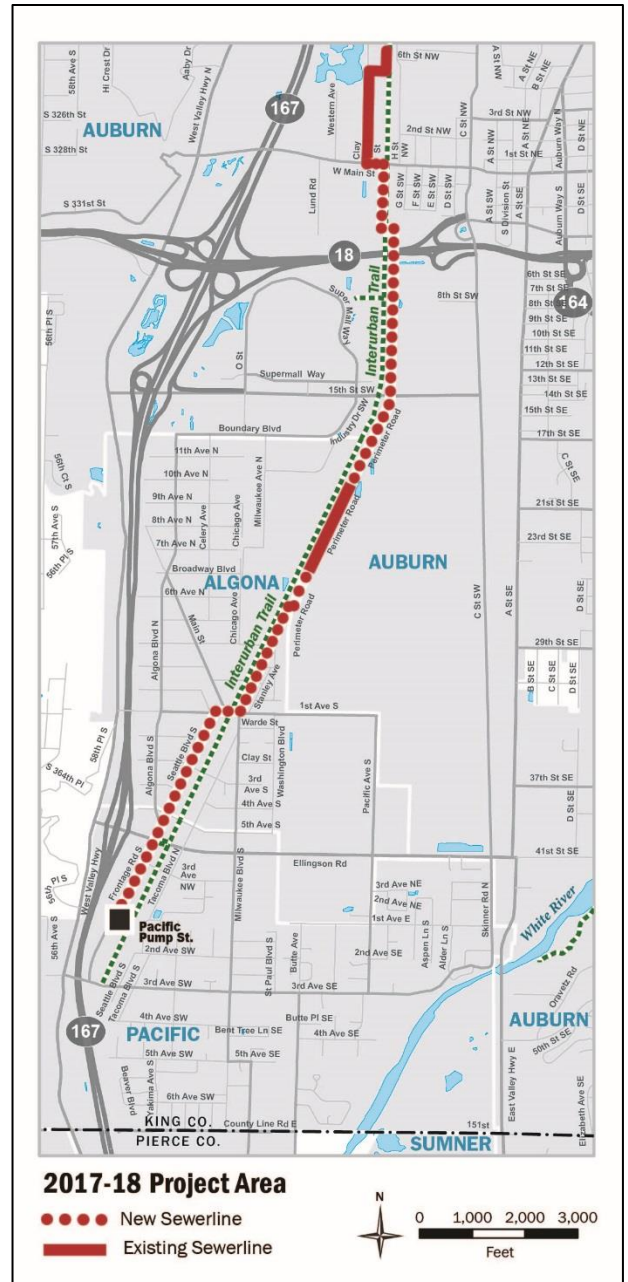

ALTERNATIVE FORMATS AVAILABLE

206-477-5371/ 711 (TTY Relay)