

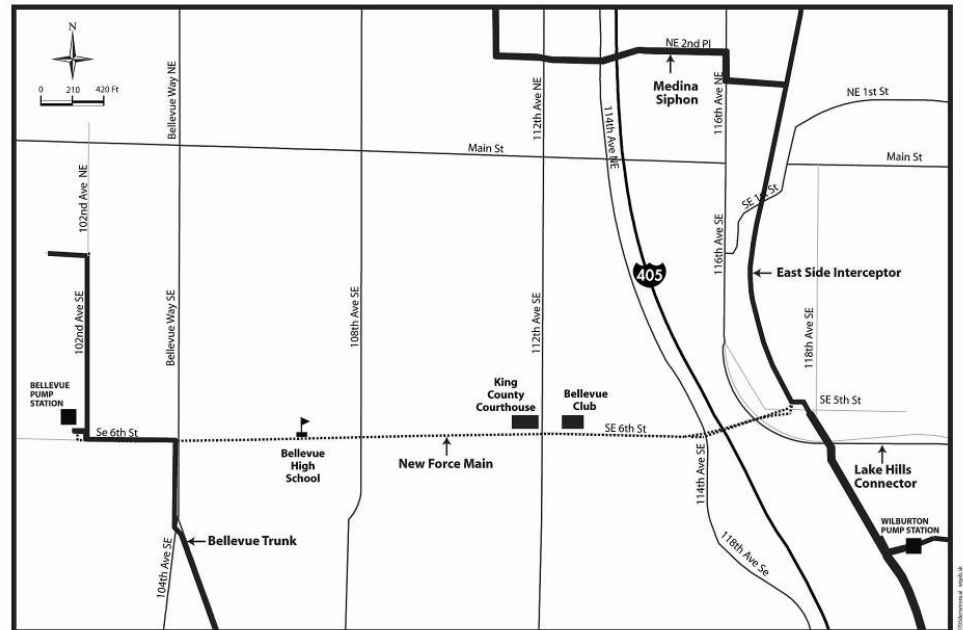

Traffic Detours & Road Closures

To protect public health and the environment, King County will build a new wastewater force main connecting the Bellevue Pump Station to a regional pipeline east of I-405 that transports wastewater to the county's Renton treatment plant.

The new 5,300 foot force main will help meet the wastewater treatment needs in west Bellevue and Bellevue's central business district for the next 50 years.



New Bellevue Force Main
Bellevue Pump Station Upgrade

■ Pump Station
..... Force Main Route
— KC-WTD Sewer
▲ School

This information is provided for informational purposes only. It is not intended to be used for any other purpose. The information is provided as is, without warranty. The user assumes all responsibility for the use of this information. The information is provided for informational purposes only. It is not intended to be used for any other purpose. The information is provided as is, without warranty. The user assumes all responsibility for the use of this information.

King County
Department of Natural Resources and Parks
Wastewater Treatment Division

To protect public safety and accommodate construction equipment, road and lane closures along Southeast Sixth Street and the westbound Lake Hills Connector will be in effect during the project. Drivers in western and central Bellevue should be aware of the following traffic detours when planning their trips:

Southeast Sixth Street Traffic Detours Between 100th & 102nd Avenues Southeast

- Southeast Sixth Street closed to traffic from 102nd Avenue Southeast west to the end of the Southeast Sixth Street Park.
- Southeast Sixth Street through traffic detoured north on 100th Avenue Southeast to Southeast Third Street.
- Road barriers across Southeast Sixth Street at the work site's eastern and western borders.
- Sidewalk at work site detoured north around Bellevue Pump Station.

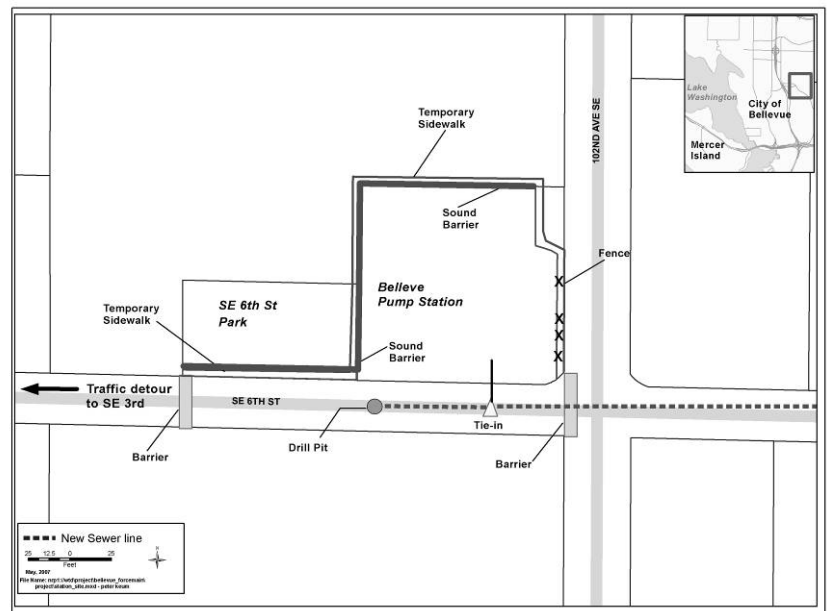

(more)

QUESTIONS? Call the 24-Hour Construction Hotline: 206-296-4081



Southeast Sixth Street Detours Between 112th & 114th Avenues Southeast

- Southeast Sixth Street closed to traffic between 112th Avenue Southeast and 114th Avenue Southeast east of Bellevue Club.
- Road barriers across Southeast Sixth Street at the work site's eastern and western borders.
- Brookside and San Mar Building access from 114th Avenue Southeast.
- Southern sidewalk closed at work site and detoured to northern side of Southeast Sixth Street.
- Access to Lincoln Plaza and Bellevue Club from 112th Avenue Southeast. Parking at Bellevue Club for members, guests and staff only.

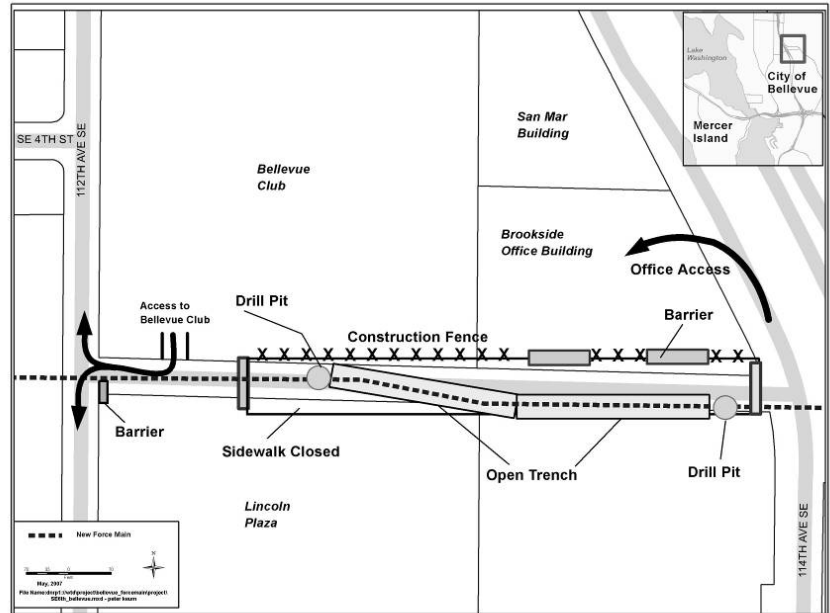

Lake Hills Connector Traffic Detours & Staging Area

- Westbound exterior lane of Lake Hills Connector closed.
- Road barriers across exterior lane of Lake Hills Connector work site's eastern and western borders.
- Road barriers across Southeast Sixth Street at the work site's eastern and western borders.
- Sidewalk at work site detoured north around work site.
- Staging area located on southeast corner of 115th Avenue Southeast and Southeast 5th Street intersection.

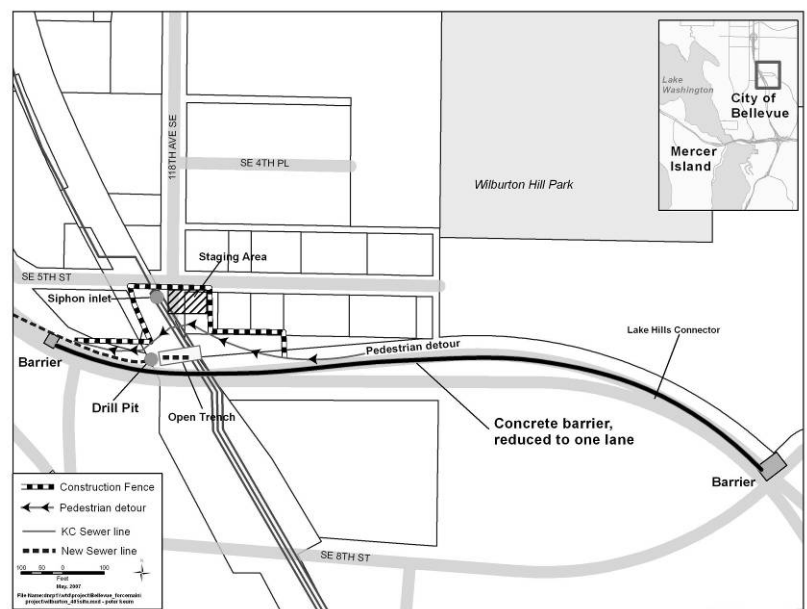

**Alternative Formats Available
206-263-6543 | 711 (TTY Relay)**